

**PRICE FURTHER REDUCED!!**



## Property Highlights

<b>FURTHER REDUCED</b>	<b><del>\$380,000</del> - \$369,995</b>
<b>Rent Guarantee</b>	<b>6 Months</b>
<b>Building Size</b>	3,640 SF (3 Suites)
<b>Lease Rate</b>	\$12.00/SF - 1,707 SF (Suite A)
<b>Suite A Availability</b>	Immediate - Contact Agents
<b>Lease Type</b>	Full Service Excluding Janitorial
<b>Lot Size</b>	0.157 Acres
<b>Zoning</b>	C-2
<b>Parking</b>	Ample - On-Site Parking
<b>Parcel Number</b>	R1607350075
<b>Year Built</b>	2001 - In Excellent Condition
<b>LockBox</b>	No, Contact Agents to Schedule

## Listing Features

- Owner/User Opportunity
- Professional Office Layout with Open Space & Waiting Area
- Near the Busy Chinden & Glenwood Intersection
- Close Proximity to Restaurants, Shopping and a Variety of Professional Services
- Current Tenants Include Edward Jones Investments & Good \$ense Business Solutions
- Neighboring Tenants Include: Visual Effects, Beverage Bistro, E-M Construction, Easy Chair Store, Grigg and Ritter & Brash CPA's
- Please Do Not Disturb Current Tenants, Contact Agents to Schedule Walkthroughs

**Jennifer McEntee**  
Director  
Office Specialist  
+1 208 287 9495  
jennifer.mcentee@paccra.com

**Chrissy Smith**  
Associate  
Office Specialist  
+1 208 287 8904  
chrissy.smith@paccra.com

398 South 9th Street, Ste 260  
Boise, Idaho 83702  
Main +1 208 287 9500  
Fax +1 208 287 9501  
**paccra.com**

*Independently Owned and Operated / A Member of the Cushman & Wakefield Alliance*

Cushman & Wakefield Copyright 2015. No warranty or representation, express or implied, is made to the accuracy or completeness of the information contained herein, and same is submitted subject to errors, omissions, change of price, rental or other conditions, withdrawal without notice, and to any special listing conditions imposed by the property owner(s). As applicable, we make no representation as to the condition of the property (or properties) in question.

# Creeks Edge Office Building

4491 North Dresden Place, Garden City, Idaho 83714

**SUITE A AVAILABLE**  
**1,707 SF - \$12.00/SF FSEJ**

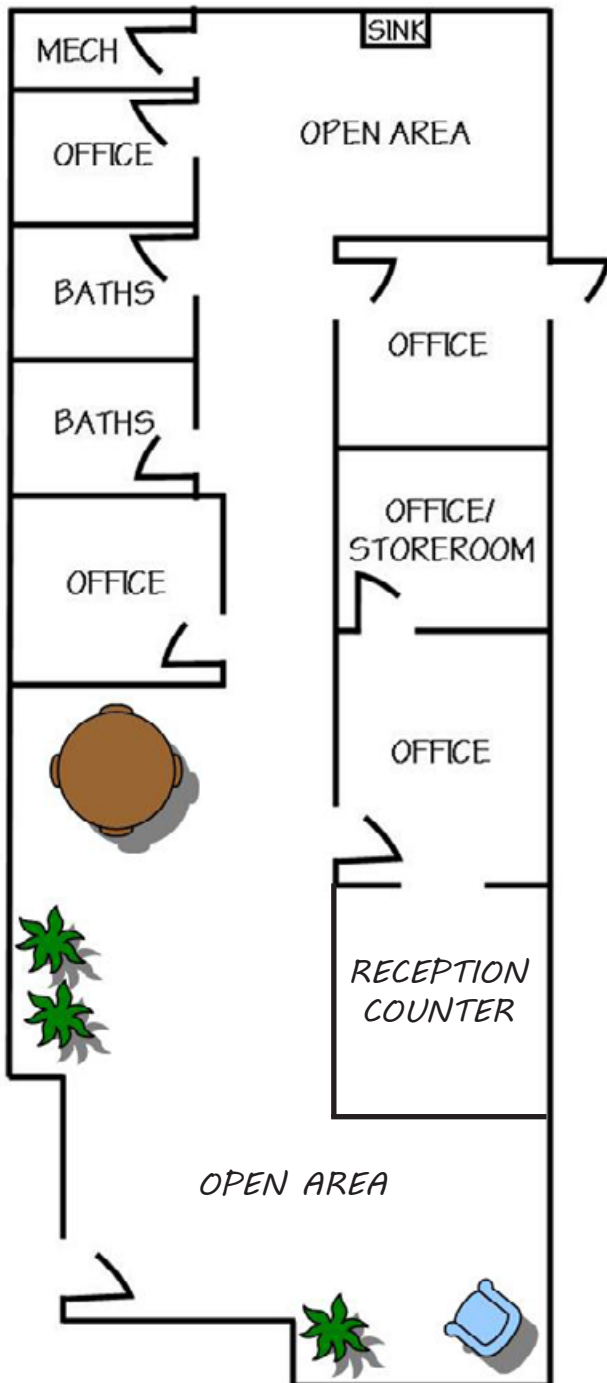

## BUILDING BREAKDOWN

SUITE	SIZE	STATUS
SUITE A	1,707 SF	AVAILABLE
SUITE B	933 SF	LEASED
SUITE C	1,000 SF	LEASED



# Creeks Edge Office Building

4491 North Dresden Place, Garden City, Idaho 83714



Average Daily Traffic (ADT) courtesy of Idaho Department of Transportation.

Independently Owned and Operated / A Member of the Cushman & Wakefield Alliance

Cushman & Wakefield Copyright 2015. No warranty or representation, express or implied, is made to the accuracy or completeness of the information contained herein, and same is submitted subject to errors, omissions, change of price, rental or other conditions, withdrawal without notice, and to any special listing conditions imposed by the property owner(s). As applicable, we make no representation as to the condition of the property (or properties) in question.