

# 110 Church Street

TRIBECA  
NEW YORK, NY



**NEWMARK**

# Property Details

## Location

West block between Park Place and Murray Street

## Approximate Size

Ground Floor 1,150 SF

## Site Status

Formerly a portion of Apple Bank

## Frontage

15 FT on Church Street

## Term

Negotiable

## Possession

Immediate

## Neighbors

Equinox Fitness Club, Whole Foods Market, Target, Burger Village, Los Tacos No. 1, Starbucks, Blank Street, Bluemercury, Le Pain Quotidien, CVS and Ole and Steen

## Comments

Most uses considered

Directly in front of the Park Place subway stop servicing the **A C E 2 3**

Two blocks from the **PATH** station with 12.5 million annual ridership

Steps from the World Trade Center, Brookfield Place, 9/11 Memorial & Museum, and City Hall

Located in the most dense residential confluence of the Financial District, Tribeca and Battery Park City with approximately 7,000 residential units and five million SF of office space within 1/4-mile

Below Equinox and one block from Target and the #2 NYC Whole Foods

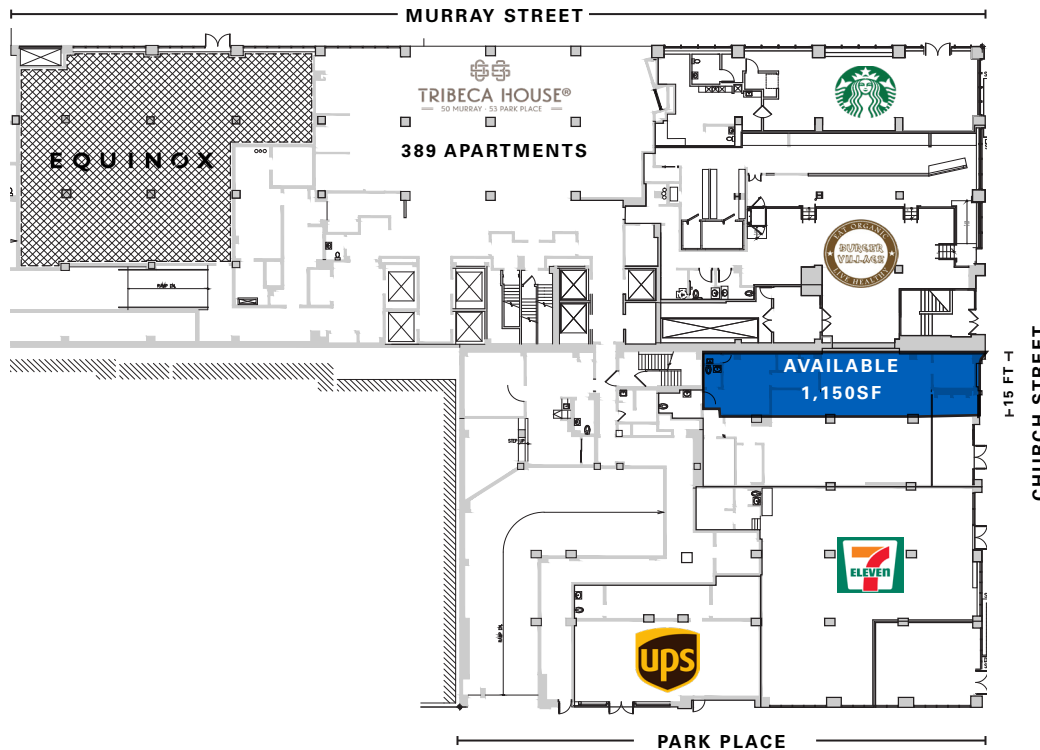

# 110 CHURCH STREET



## CONTACT

**Ariel Schuster**  
 t 212-331-0132  
 ariel.schuster@nrmk.com

**Ross Berkowitz**  
 t 212-916-3388  
 ross.berkowitz@nrmk.com

**Evan Roteman**  
 t 212-916-2931  
 evan.roteman@nrmk.com

[nrmk.com](http://nrmk.com)

©2023 NEWMARK The information contained herein has been obtained from sources deemed reliable but has not been verified and no guarantee, warranty or representation, either express or implied, is made with respect to such information. Terms of sale or lease and availability are subject to change or withdrawal without notice.