

413 CENTRAL AVENUE, PAWTUCKET, RI
(OFFICE SPACE AVAILABLE)

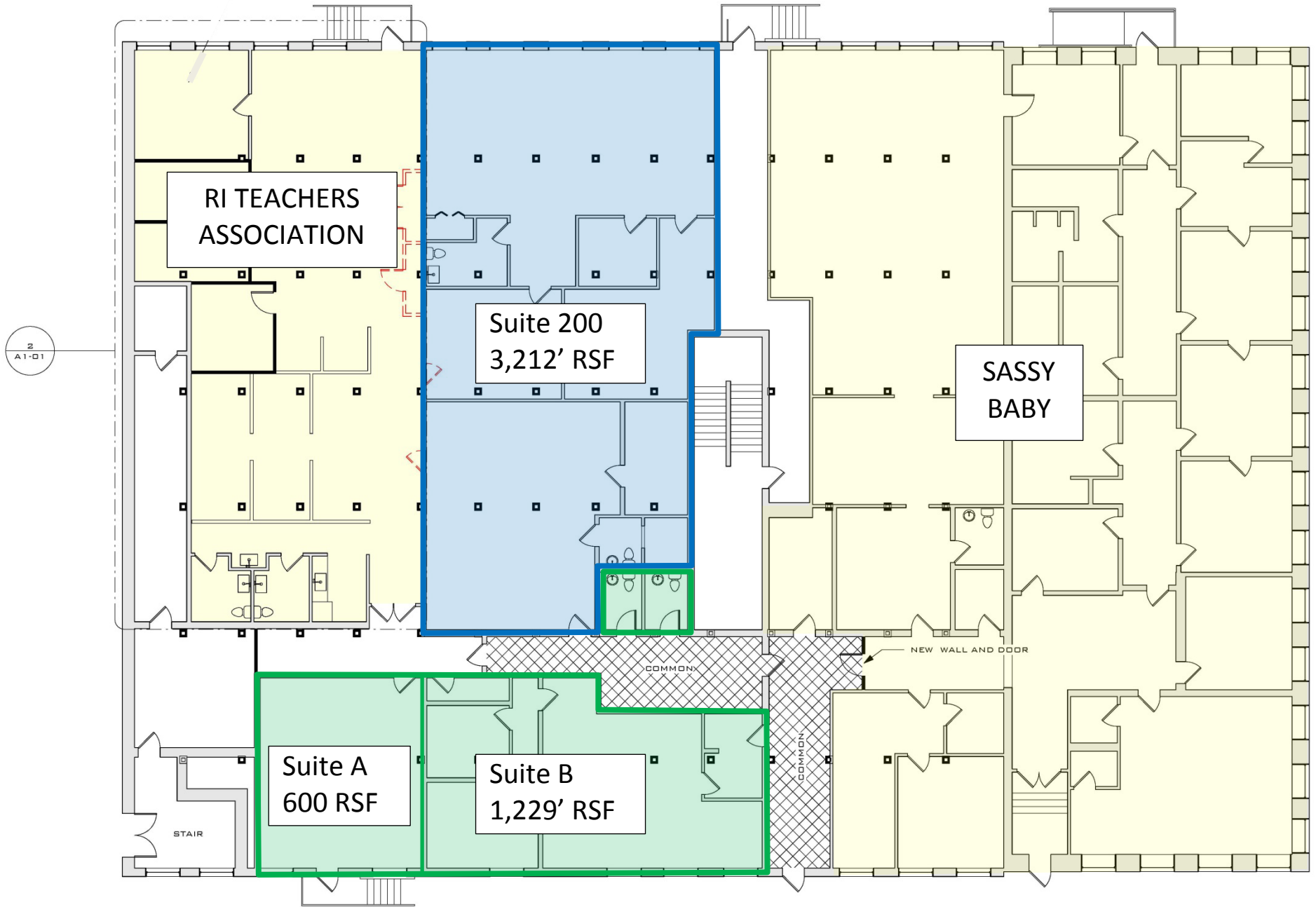



Brady Sullivan Properties
 870 N. Commercial Street
 Pawtucket, RI 02861
 603.822.8223

Notice:
 This drawing is the property of Brady Sullivan Properties. The use, reproduction or modification of this drawing for any purpose without an expressed written agreement between BSP and the user is prohibited. Rights to use the information on this sheet are not transferred until payment has been received for services rendered. Any rights or patents are non-transferable to other parties without the prior expressed written consent of BSP.

© 2015 Brady Sullivan Properties

Owner
 Owner

Project
 AMERICAN WIRE
 413 CENTRAL AVE
 PAWTUCKET, RI



Scale
 0%

Issues

Date	Description

Revisions

No.	Date	Description

Drawing Title
 SUITE-600,700,800

Issue Date	Issue Date
Project No. Project Number	Scale 1/8" = 1'-0"
Project Manager Project Leader	Project Architect Title Designer
Drawing Number	

A1.3

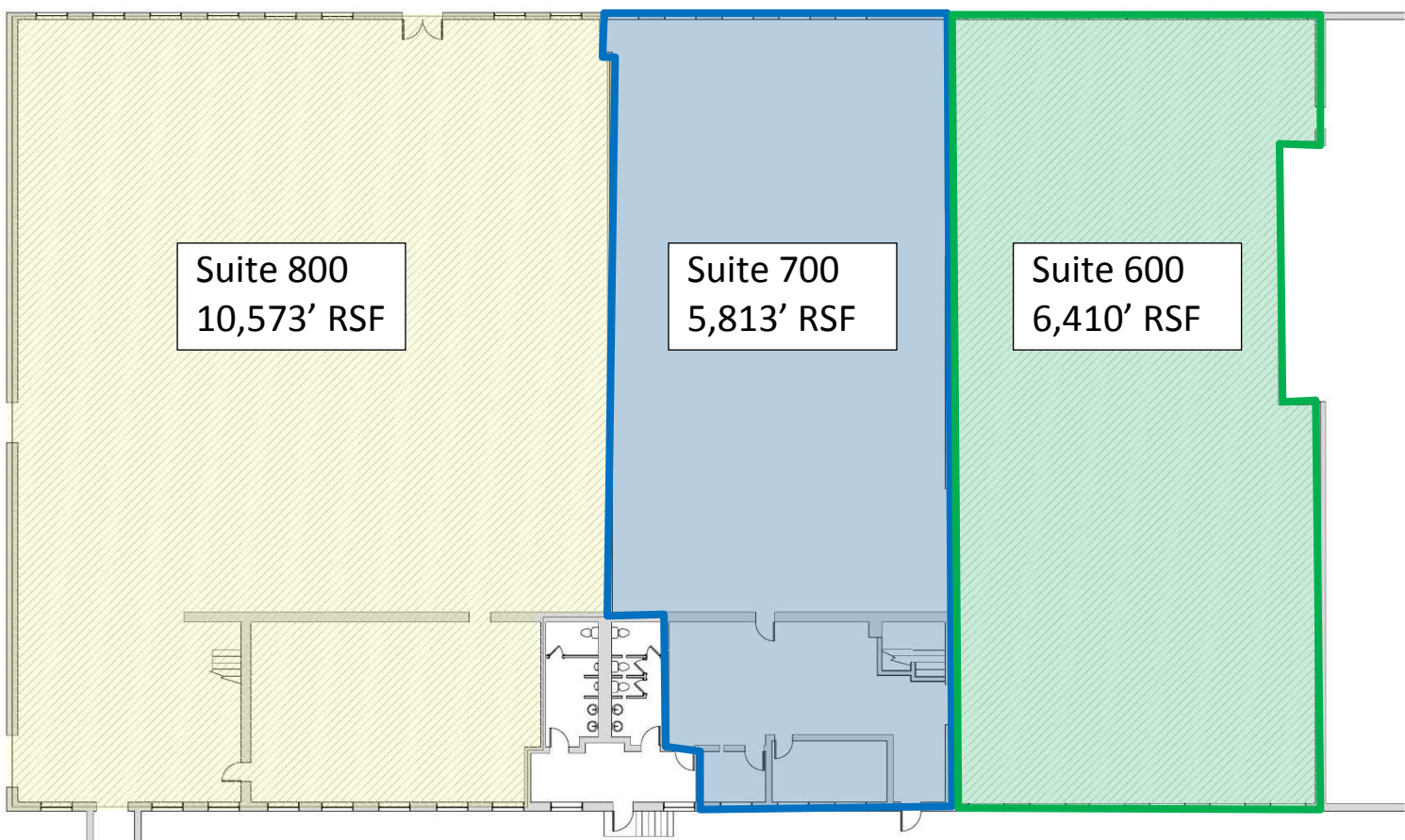

1 SUITE 600, 700, 800
 1/8" = 1'-0"

DISCLAIMER: ALL BUILDOUT IS BASED ON BRADY SULLIVAN PROPERTIES "CONSTRUCTION STANDARDS"
 BRADY SULLIVAN PROPERTIES RESERVES THE RIGHT TO ISSUE A CHANGE ORDER FOR ADDITIONAL WORK
 NOT INCLUDED IN DRAWINGS.

15/06/2015 10:45 AM