

2238 East Thomas Road
Phoenix, AZ 85016-3474
(602) 955-9800 Phone
(602) 955-0489 Fax
www.fama.com

ROBERT KUBICKI
Architects And Associates, Inc.

date 8-1-08

FINAL SITE PLAN

Walgreens

STORE NO. 1203
850 SUNSET CACTUS & 4TH STREET
MCKESON, ARIZONA

Design: RECAA
Drawn: RLB
checked: STS

sheet
SP-3
of
job 87881

PROJECT DATA	
ZONING:	B-2
NET SITE AREA:	255-8 S.F. (3.28 AC)
BUILDING AREA:	13,716 S.F.
1ST FLOOR (12200)	9,828 S.F.
MEZZANINE (14900)	3,948 S.F.
TOTAL:	13,776 S.F.
LOT COVERAGE:	10.58%
PARKING REQUIRED: (1 PER 200 S.F.)	68 SPACES
PARKING PROVIDED:	71 SPACES
ACCESSIBLE PARKING REQUIRED:	3 SPACES
ACCESSIBLE PARKING PROVIDED:	8 SPACES

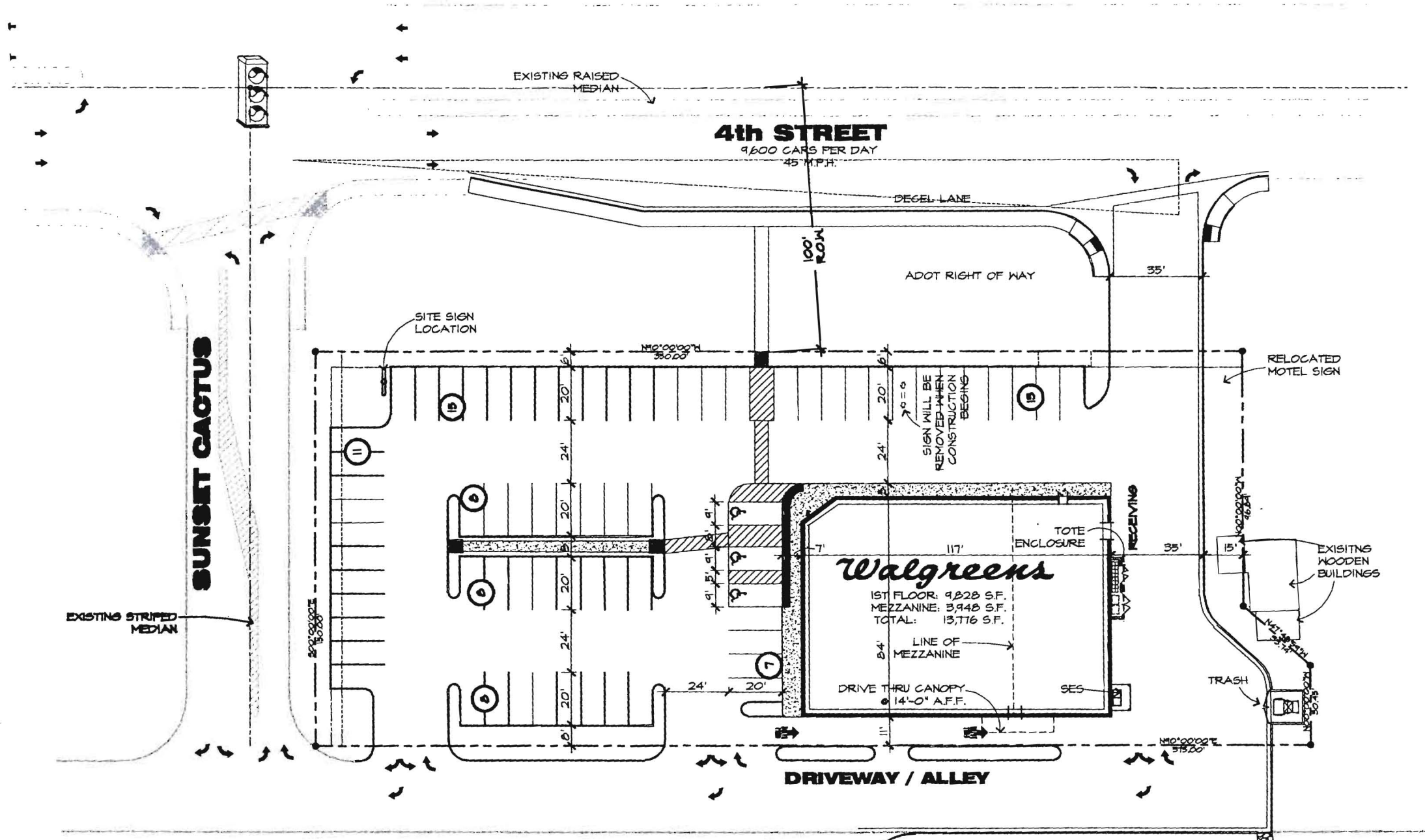

SITE PLAN

**WALMART SHOPPING CENTER
NOT A PART**

DETDR
13 Feb. 08