

Retail 24/7.

FOR LEASE RETAIL SPACE ON SOUTH TACOMA WAY

NOW AVAILABLE

2626 SOUTH TACOMA WAY :: TACOMA, WA

- Space Available: ±603 – ±5,566 SF (divisible)
- ±6,000 SF secured yard available
- 600' of frontage on South Tacoma Way
- Great location on the corner of South Tacoma Way and Pine Street
- Quick access to I-5 and SR-16
- 2 Grade-level doors
- Existing Tenants in Building: 7-11, FleetPride & Fastenal
- Pylon signage available



Teresa Patton

Team Leader

+1 253 596 0043

teresa.patton@cbre.com

Yeh-Hee Hahn

Vice President

+1 253 596 0055

yeh-hee.hahn@cbre.com

CBRE

FOR LEASE
RETAIL SPACE ON
SOUTH TACOMA WAY

Retail 24/7.

NOW AVAILABLE :: 2626 SOUTH TACOMA WAY :: TACOMA, WA

UNIT	SF (±)	RATE
A	2182	\$24.00 - \$28.00/SF
B	1213	\$24.00 - \$28.00/SF
C	1570	\$24.00 - \$28.00/SF
D	604	\$24.00 - \$28.00/SF
E	1517	\$24.00 - \$28.00/SF

SPACE AVAILABLE

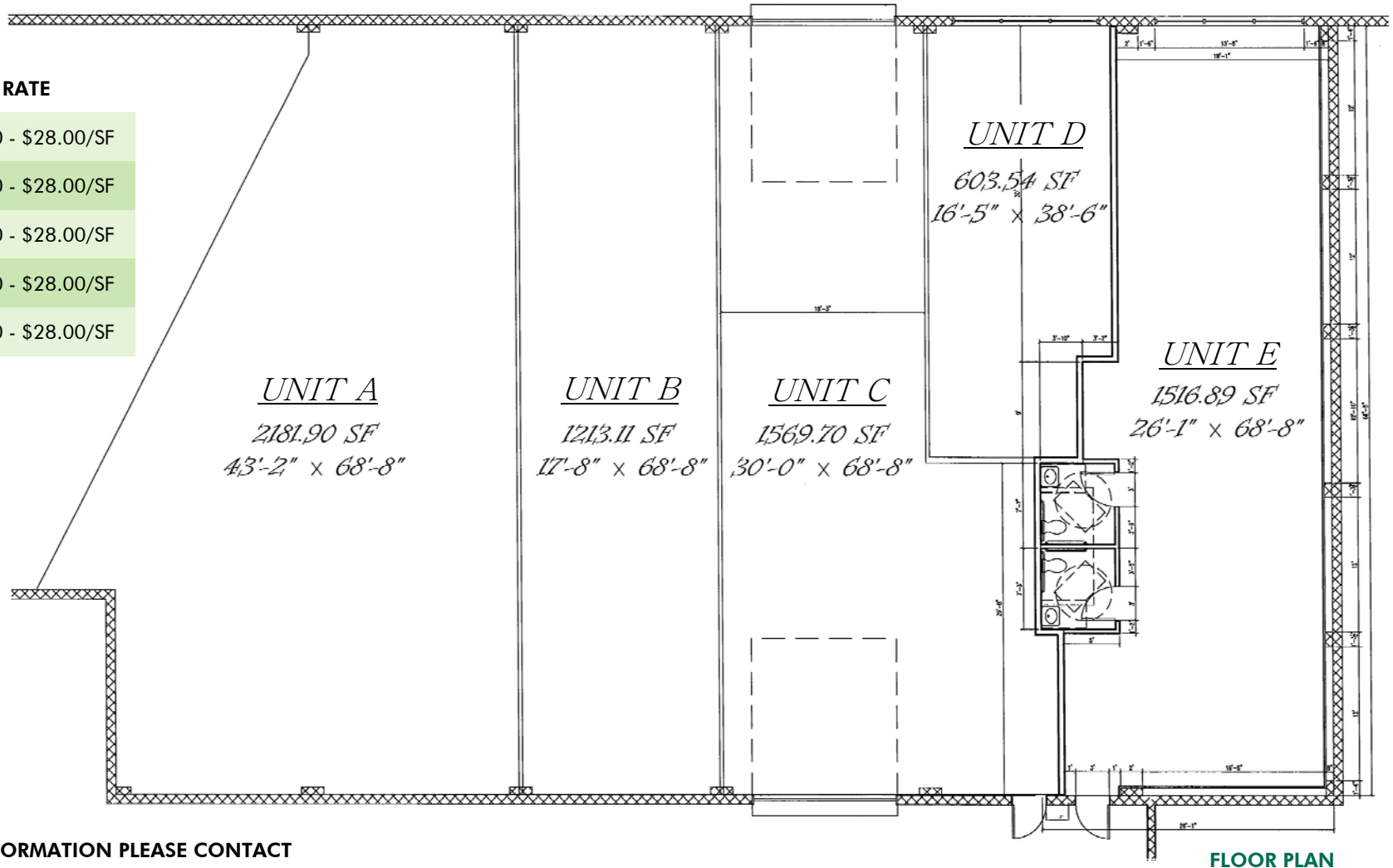

FOR MORE INFORMATION PLEASE CONTACT

Teresa Patton

Team Leader
 +1 253 596 0043
 teresa.patton@cbre.com

Yeh-Hee Hahn

Vice President
 +1 253 596 0055
 yeh-hee.hahn@cbre.com



FOR LEASE RETAIL SPACE ON SOUTH TACOMA WAY

Retail 24/7.

NOW AVAILABLE :: 2626 SOUTH TACOMA WAY :: TACOMA, WA



2013 Traffic Counts

South Tacoma Way	over 29,000 cars per day
South Pine Street	over 19,000 cars per day

LOCATION MAP

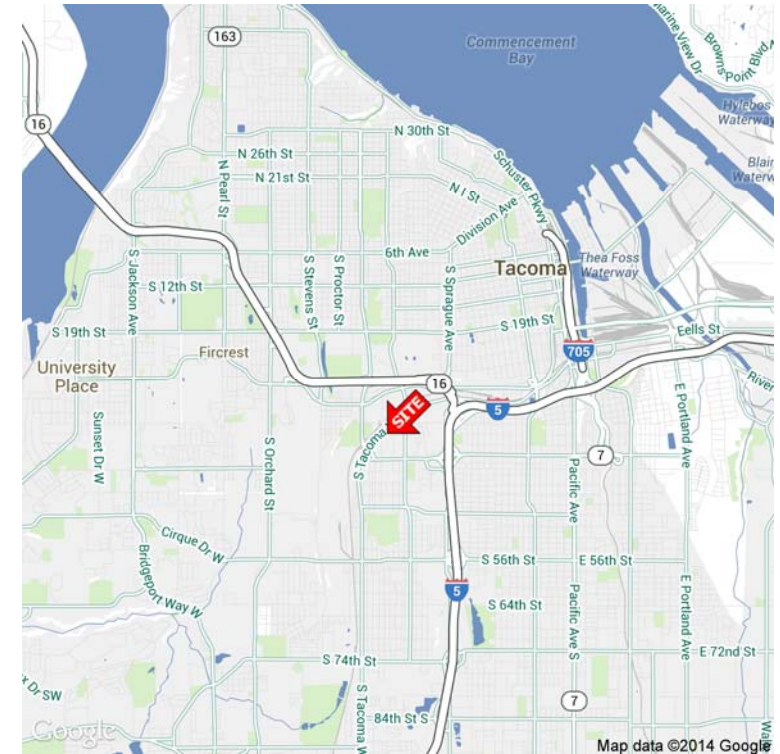

FOR MORE INFORMATION PLEASE CONTACT

Teresa Patton

Team Leader

+1 253 596 0043

teresa.patton@cbre.com

Yeh-Hee Hahn

Vice President

+1 253 596 0055

yeh-hee.hahn@cbre.com

CBRE | 1201 Pacific Avenue | Suite 1502 | Tacoma, WA 98402 | www.cbre.com/tacoma

CBRE

© 2012 CBRE, Inc. This information has been obtained from sources believed reliable. We have not verified it and make no guarantee, warranty or representation about it. Any projections, opinions, assumptions or estimates used are for example only and do not represent the current or future performance of the property. You and your advisors should conduct a careful, independent investigation of the property to determine to your satisfaction the suitability of the property for your needs. gls