

# Kapiolani Retail & Office Space



## PROPERTY DESCRIPTION

1400 Kapiolani is a two story retail/office building centered in the heart of Honolulu's urban core. The Kenrock Building is within short walking distance of Ala Moana Shopping Center, Ala Moana Beach Park, the Convention Center and many of Oahu's premier dining locations.

TMK: (1) 2-3-16:004

Zoning: BMX-3

Rent: Negotiable

Term: Two (2) Years

Parking: \$175/mo per stall

## AVAILABLE SPACES

### Second Floor

B20	714 SF
B33 & B34	495 SF
B35	426 SF
B40	684 SF
B49	450 SF
C24 & C25	1222 SF



800 Bethel Street  
Suite 501  
Honolulu, HI 96813

Duane Shimogawa (S)  
(808) 369-1126  
ds@avalonhi.com

# Kenrock Building

## 1400 Kapiolani Boulevard

### Honolulu, HI 96814



**AVALON**  
COMMERCIAL



#### KENROCK BUILDING VACANCIES 2ND FLOOR MAR 2017

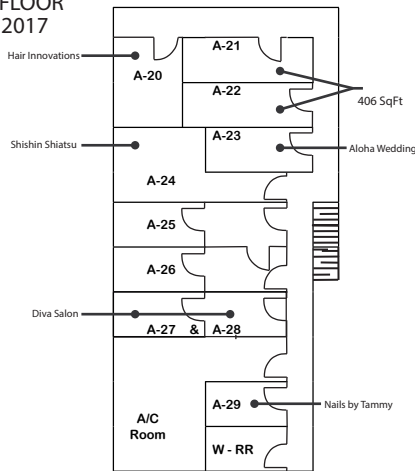

Vacant (As of Mar 2017)

#### KAPIOLANI BLVD

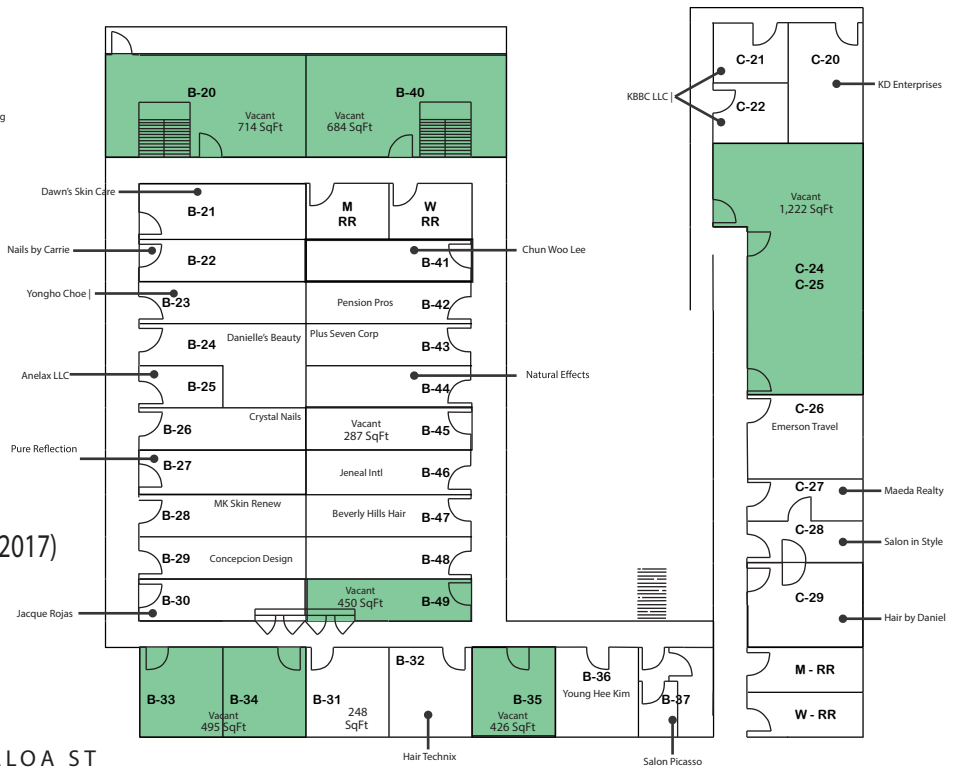

## Locational Attributes

- Located across from Ala Moana Shopping Center and Walmart
- Less than 10 minutes to Waikiki, Downtown Honolulu and the Convention Center
- Average traffic flow of 47,000 cars per day

©2017, Avalon Commercial LLC. We obtained the information above from sources we believe to be reliable. However, we have not verified its accuracy and make no guarantee, warranty or representation about it. It is submitted subject to the possibility of errors, omissions, change of price, rental or other conditions, prior sale, lease or financing, or withdrawal without notice. We include projections, opinions, assumptions or estimates for example only, and they may not represent current or future performance of the property. You and your tax and legal advisors should conduct your own investigation of the property and transaction.