



For Lease

Contact:

Michael Rosendin, SIOR, CCIM
Vice Chair
+1 408 282 3900
michael.rosendin@colliers.com
Lic. No. CA-00826095

225 W Santa Clara Street
10th Floor, Suite 1000
San Jose, CA 95113
United States
Main: +1 408 282 3800
colliers.com/siliconvalley

±14,705 SF Industrial Space with Yard

970–980 Lonus Street, San Jose, CA

Property Highlights

- Approx. 25% HVAC Office
- 3 Grade Level Doors
- 15' Clear Height
- 500 Amps, 240v, 3-Phase Power
- 100% HVAC
- 53 Total Parking Stalls
- Secure Fenced Yard (43 Stalls)
- Downtown Willow Glen Location
- Excellent Access to Hwys 280, 87, 880 & 101
- \$1.15 I.G.
- **Available Immediately — Call to Tour**

970-980 Lonus St.

Floorplan

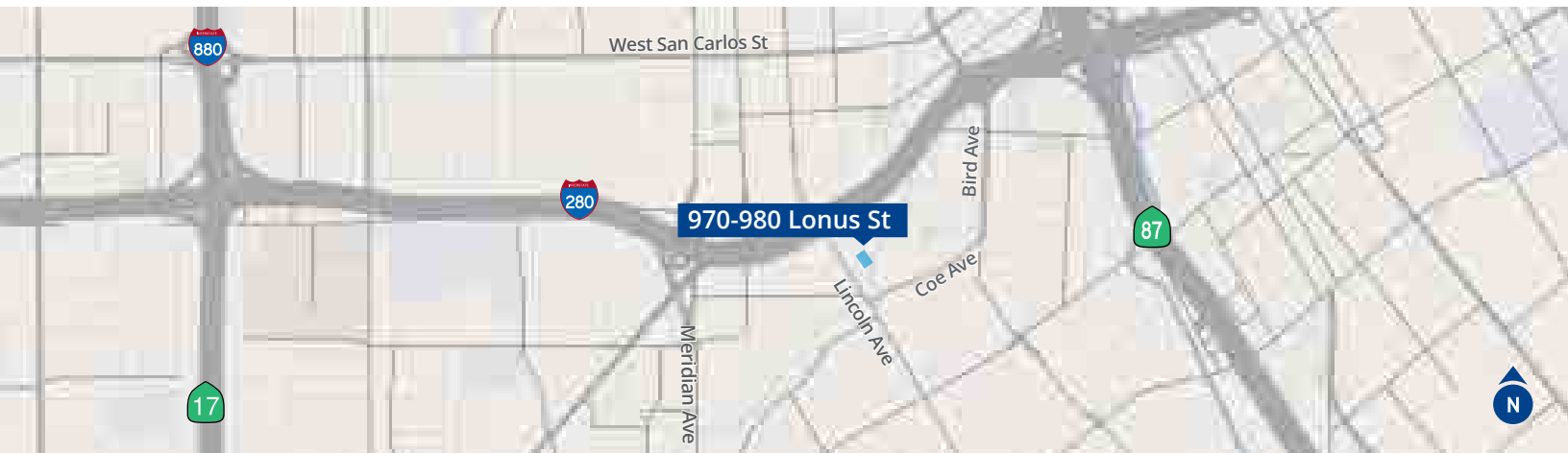
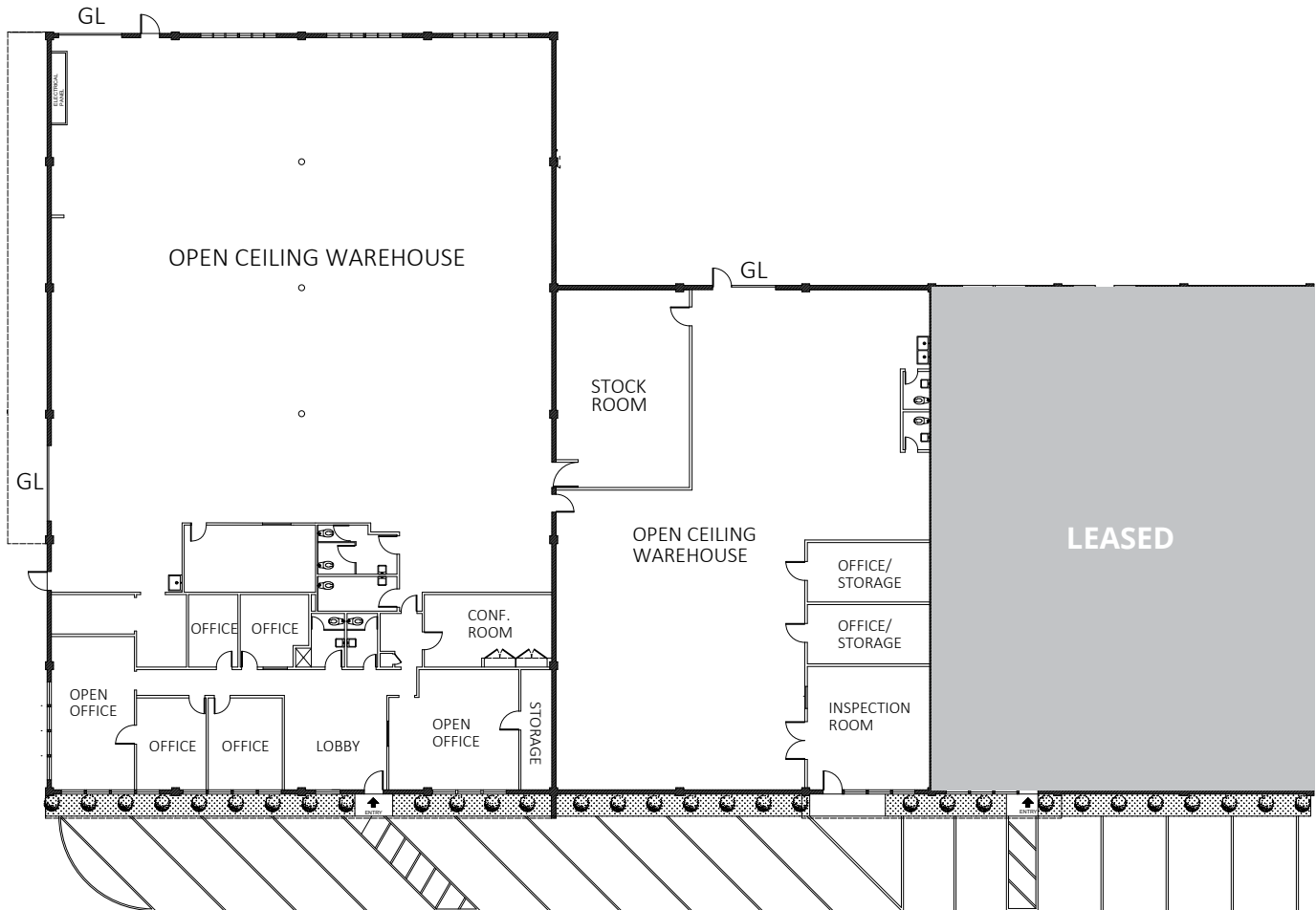

Michael Rosendin, SIOR, CCIM
Vice Chair
+1 408 282 3900
michael.rosendin@colliers.com
Lic. No. CA-00826095

Colliers
225 W Santa Clara Street
10th Floor, Suite 1000
San Jose, CA 95113
P: +1 408 282 3800



970-980 Lonus St

Site Plan

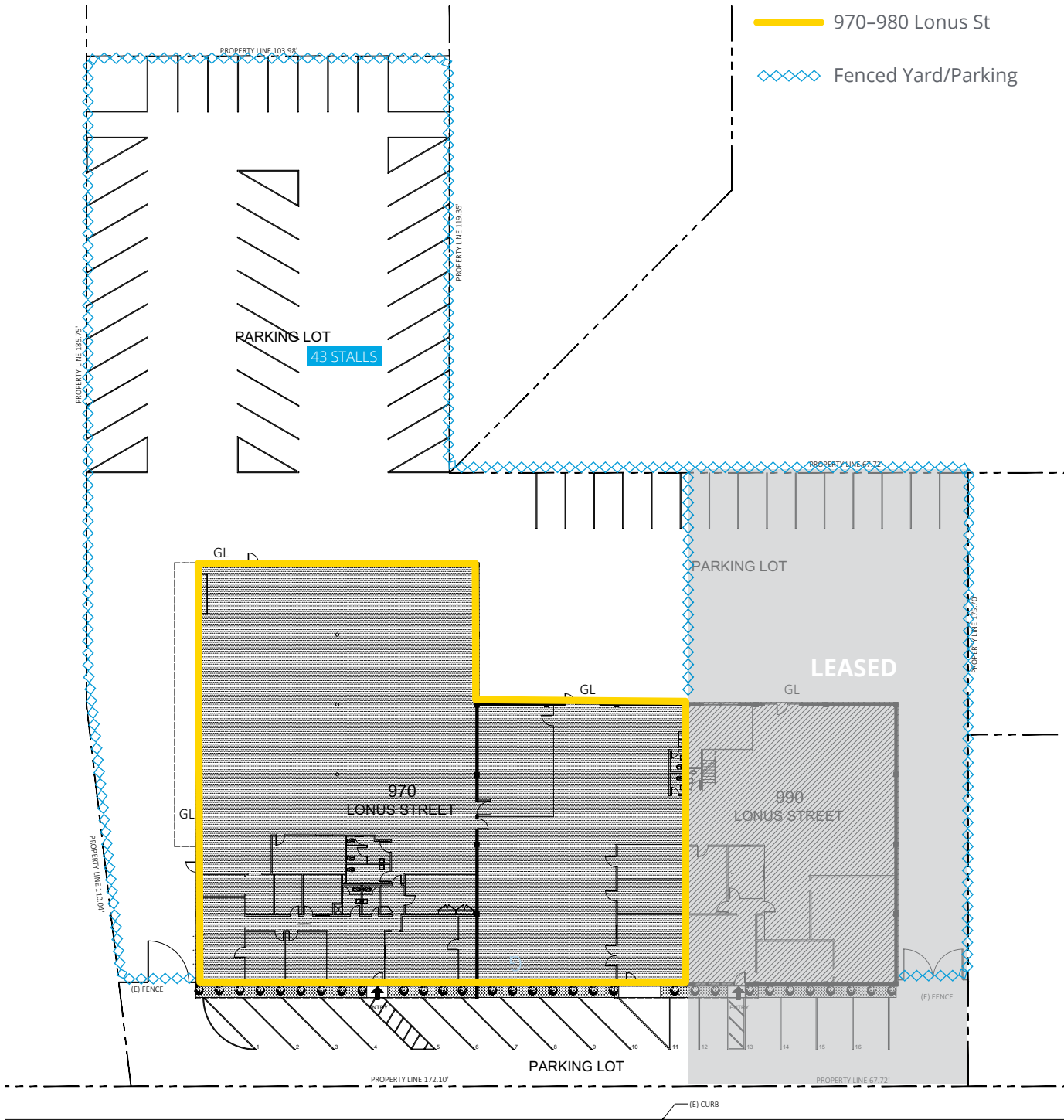

Michael Rosendin, SIOR, CCIM
Vice Chair
+1 408 282 3900
michael.rosendin@colliers.com
Lic. No. CA-00826095

Colliers
225 W Santa Clara Street
10th Floor, Suite 1000
San Jose, CA 95113
P: +1 408 282 3800



970-980 Lonus St

Amenities Map

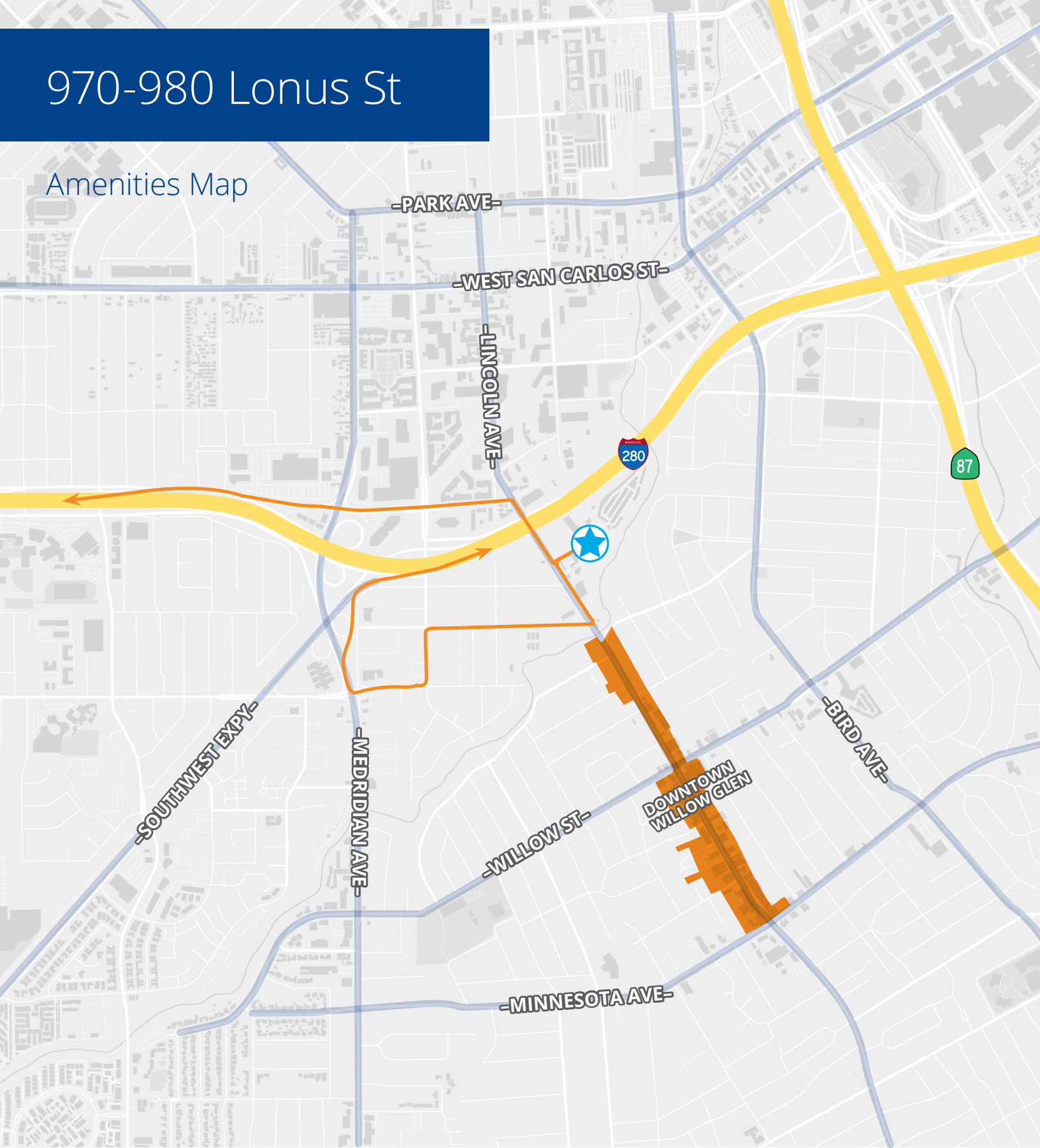

Michael Rosendin, SIOR, CCIM
Vice Chair
+1 408 282 3900
michael.rosendin@colliers.com
Lic. No. CA-00826095

Colliers
225 W Santa Clara Street
10th Floor, Suite 1000
San Jose, CA 95113
P: +1 408 282 3800

