

For Lease

Office Building

On Busy Corridor



653 Utah

Las Cruces, New Mexico 88001

Property Highlights

- Full service lease terms
- Near Downtown Area
- Multiple building entry and exit options
- Ample parking in front
- Covered parking in rear
- Surrounded by numerous retailers, restaurants and professional businesses

Property Description

This listing is 3,809 sq. ft. professional office with large break area. Nice outside seating area. Could be government agency or large law office. Landlord will paint and install new carpet. The space has separate men's and women's handicap accessible bathrooms.

OFFERING SUMMARY

Available SF	3,809 SF
Lease Rate	\$12.00 SF/yr (Full Service)
Building Size	3,809 SF



Google

Map data ©2018 Google

For more information

Stephanie Maddox

O: 575 521 1535 | C: 575 639 3504
stephanie@1stvalley.com

Floorplan

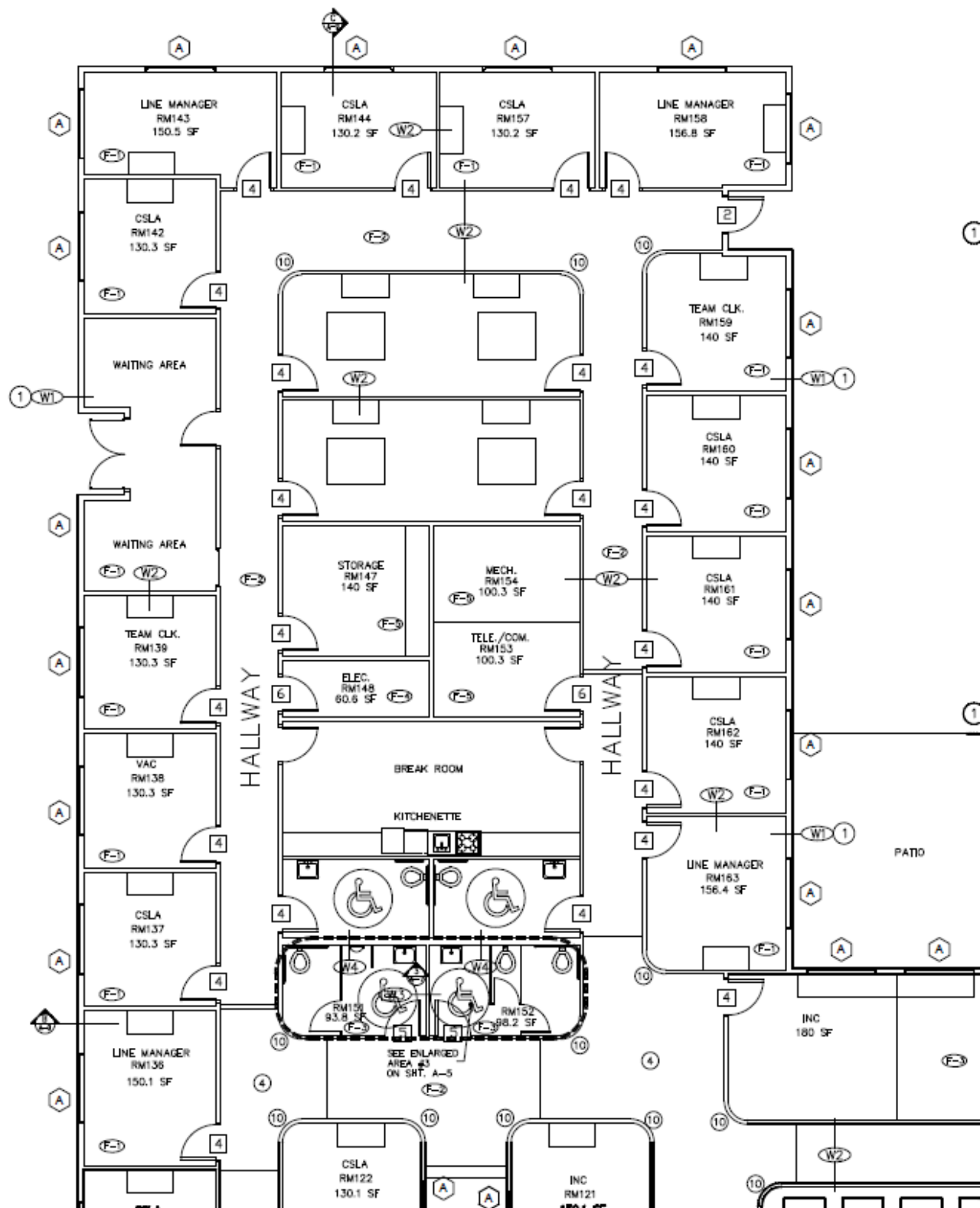

Retailer Map



Map data ©2018 Google Imagery ©2018, CNES / Airbus, DigitalGlobe, NMRGIS, Texas Orthoimagery Program, U.S. Geological Survey, USDA Farm Service Agency

Demographics Map

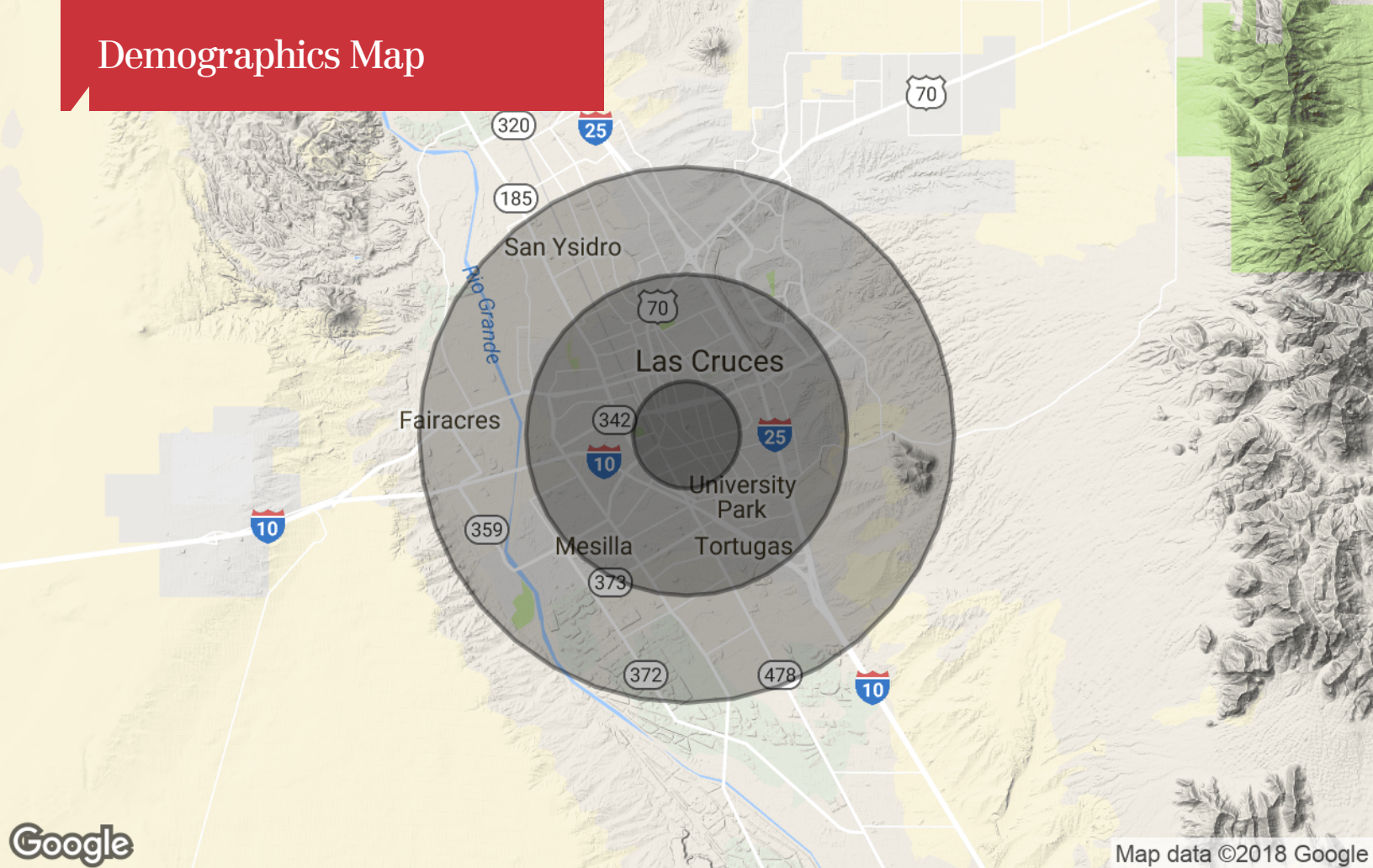

Population

	1 Mile	3 Miles	5 Miles
TOTAL POPULATION	11,011	66,863	101,713
MEDIAN AGE	30.1	31.4	32.9
MEDIAN AGE (MALE)	28.1	29.9	31.6
MEDIAN AGE (FEMALE)	32.9	34.0	35.0

Households & Income

	1 Mile	3 Miles	5 Miles
TOTAL HOUSEHOLDS	4,819	26,518	39,235
# OF PERSONS PER HH	2.3	2.5	2.6
AVERAGE HH INCOME	\$30,619	\$40,904	\$46,043
AVERAGE HOUSE VALUE	\$107,968	\$143,205	\$158,930

* Demographic data derived from 2010 US Census