

# FOR LEASE



## INDUSTRIAL SPACE AVAILABLE

6604 E. Seltice Way, Post Falls, ID 83854

Industrial Building in  
Multi-Tenant Business Park

### 6612 | B

SPACE SIZE	±2,280 SF
LEASE RATE	\$10.20 PSF
LEASE TYPE	Modified Gross

VIEW LOCATION



CASEY BRAZIL | AGENT

509.755.7579

[casey.brazil@kiemlehaagood.com](mailto:casey.brazil@kiemlehaagood.com)

**KIEMLE**  
HAGOOD

# SITE PLAN

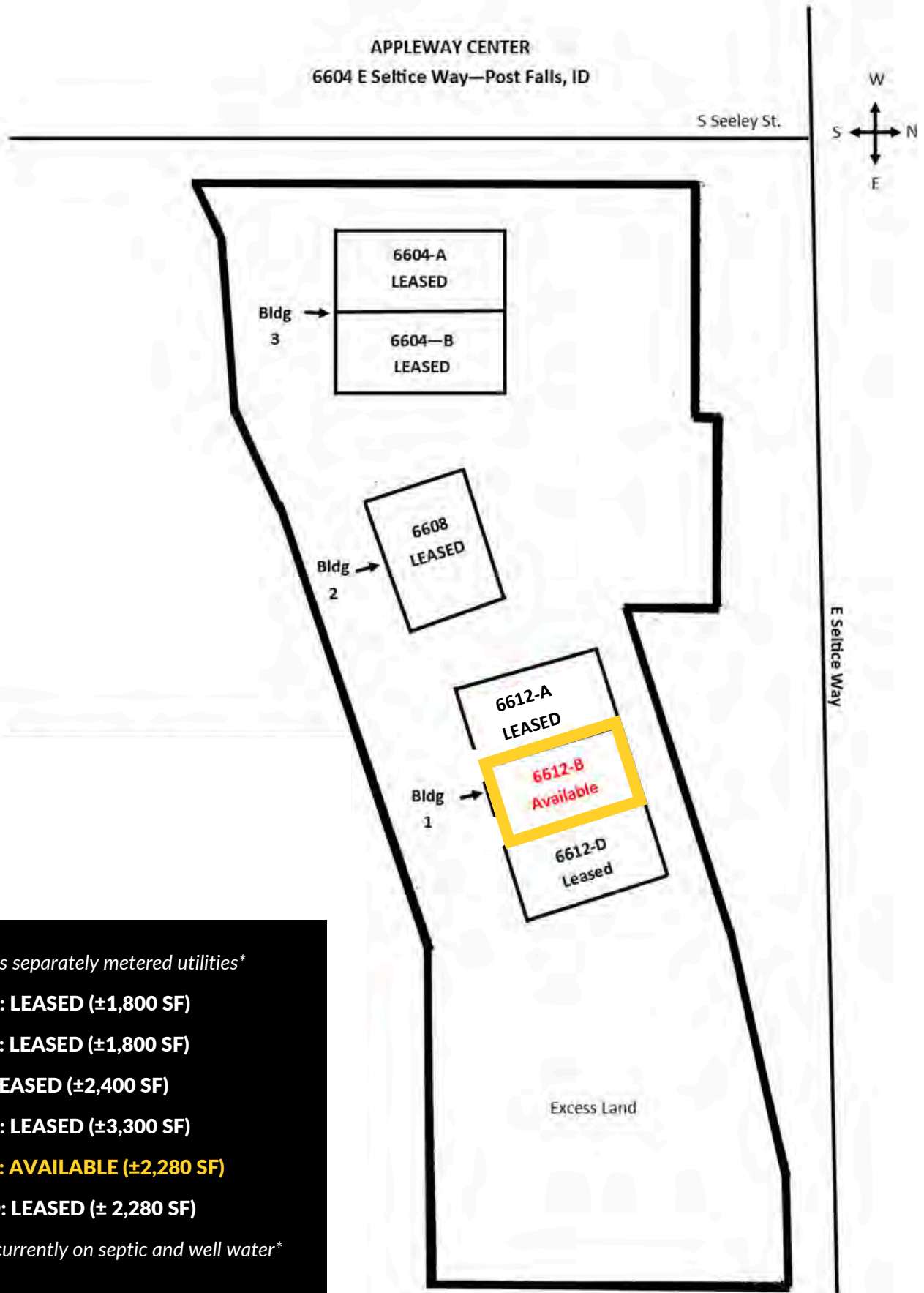

*\*Tenant pays separately metered utilities\**

- 6604-A: LEASED (±1,800 SF)
- 6604-B: LEASED (±1,800 SF)
- 6608: LEASED (±2,400 SF)
- 6612-A: LEASED (±3,300 SF)
- **6612-B: AVAILABLE (±2,280 SF)**
- 6612-D: LEASED (± 2,280 SF)

*\*The site is currently on septic and well water\**

# BUILDING DETAILS

## BUILDING | 1

**BUILDING SIZE** ±8,400 SF

### ADDITIONAL DETAILS:

Clean Light Industrial Space

Office and Storage

1 Space Available, ±2,280 SF

Overhead Door in Back of Building





# INDUSTRIAL SPACE AVAILABLE

VIEW LOCATION

6604 E. Seltice Way, Post Falls, ID 83854



## CASEY BRAZIL

509.755.7579 | [casey.brazil@kiemlehagood.com](mailto:casey.brazil@kiemlehagood.com)



No warranty or representation, expressed or implied, is made by Kiemle Hagood, its agents or its employees as to the accuracy of the information contained herein. All information furnished is from sources deemed reliable and submitted subject to errors, omissions, change of terms and conditions, prior sale, lease or financing, or withdrawal without notice. No one should rely solely on the above information, but instead should conduct their own investigation to independently satisfy themselves. Kiemle Hagood respects the intellectual property of others: If you believe the copyright in your work has been violated through this Website, please contact our office for notice of claims of copyright infringement. For your complaint to be valid under the Digital Millennium Copyright Act of 1998 (DMCA), you must provide the following information when providing notice of the claimed copyright infringement: Identify the material on the Website that you believe infringes your work, with enough detail so that we may locate it on the Website; provide your address, telephone number and email address; provide a statement that you have a good faith belief that the disputed use is not authorized by the copyright owner, its agent, or the law; provide a statement that the information in the notification is accurate, and under penalty of perjury, that the complaining party is authorized to act on behalf of the owner of an exclusive right that is allegedly infringed; and provide your physical or electronic signature. Upon receiving your complaint, Kiemle Hagood will, upon review, remove content that you believe infringes your copyright if the complaint is found to be valid.

### OFFICE LOCATIONS

SPOKANE | COEUR D'ALENE | TRI-CITIES | MISSOULA

1579 W RIVERSTONE DRIVE, SUITE 102  
COEUR D'ALENE, ID 83814