

± 9,300 SF
DEAD STORAGE SPACE

13465 GREGG STREET
POWAY, CA 92064



PROPERTY HIGHLIGHTS

Total Space: Approx. 9,300 SF

Clear Height: 24 ft.

Truck Docks: Three (3)

Grade Level Truck Doors: One (1)

Fire Sprinklers: Yes

Skylights: Yes

Warehouse Office: Small office

Sublease: 2 1/2 years remaining on lease. Will consider short-term.

Please contact me for more details.

CHARLES ADOLPHE | PRINCIPAL
cadolphe@lee-associates.com
619.823.5340 | Lic.No. 00915194

± 9,300 SF
DEAD STORAGE SPACE

13465 GREGG STREET
POWAY, CA 92064

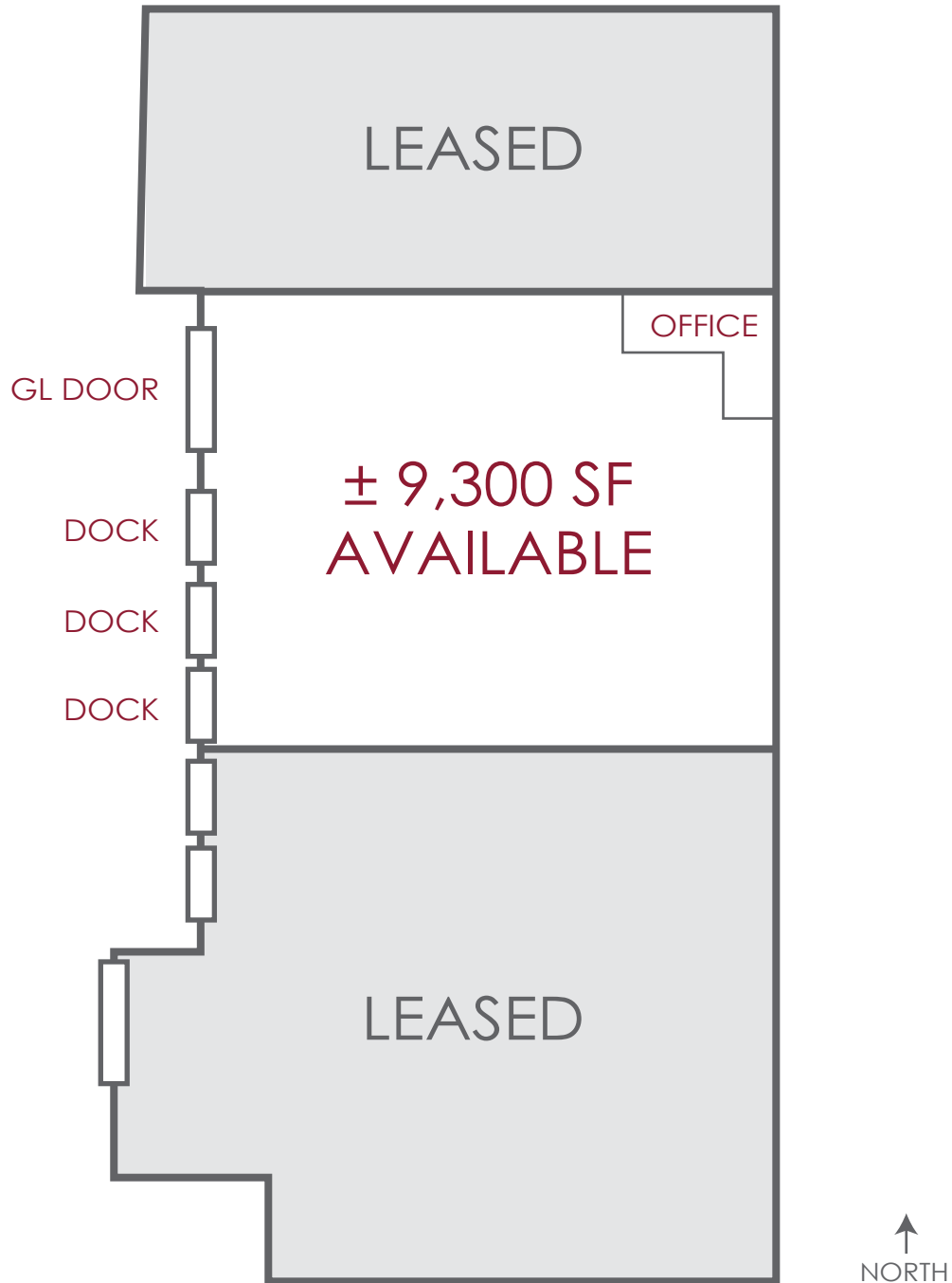

Please contact me for more details.

CHARLES ADOLPHE | PRINCIPAL
cadolphe@lee-associates.com
619.823.5340 | Lic.No. 00915194