



JIT BUILDING

1601 FONTANA RD, Paso Robles, CA 93446

Brent Smith, Jr
JIT CORPORATION, INC.
530 N. PUENTE, BREA, CA 92821
brentsmithjr.jitcorp@gmail.com
(480) 415-6366



JIT BUILDING

\$2,900,000

JIT is pleased to present the purchase or lease opportunity of an Excellent Industrial Building in Paso Robles. Owner/User opportunity for Manufacturing, Distribution, Showroom, etc.

- Newer Construction Sprinklered Building
- Single Story
- Shown by Appointment Only
- Built in 2001
- 41 Parking Spaces

Price:	\$2,900,000
Building Size:	30,000 SF
Price/SF:	\$96.67
Property Type:	Industrial
Property Sub-type:	Manufacturing
Additional Sub-types:	Flex Space, Warehouse
Property Use Type:	Vacant/Owner-User
Commission Split:	3%
Occupancy:	0%
No. Stories:	1



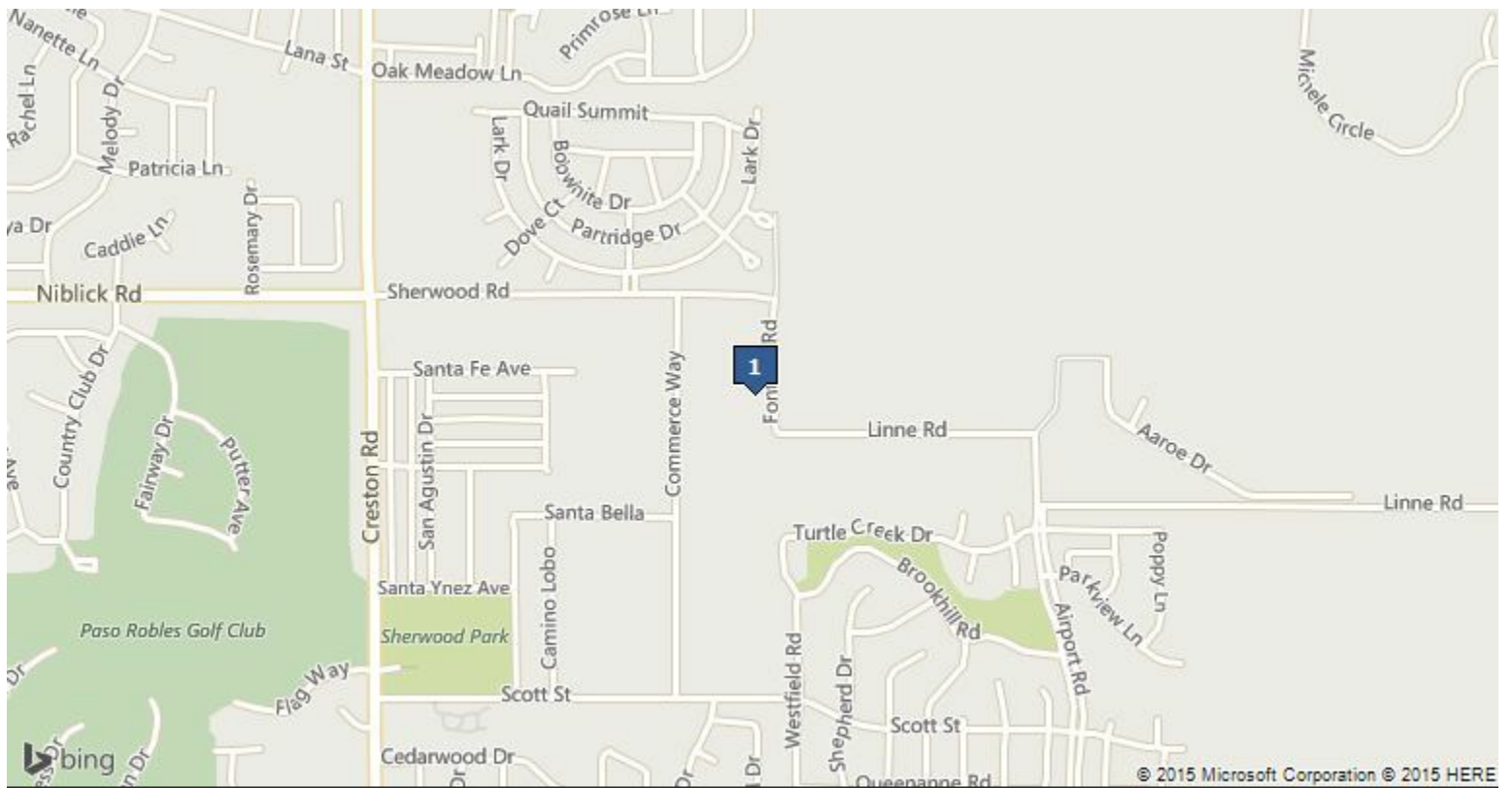

1601 FONTANA RD, Paso Robles, CA 93446

Sherwood Road/Fontana Road, One block south of Sherwood. Next to the US Post Office.

Property Photos

