



COMMERCIAL

CENTURION BUILDING B

INDUSTRIAL SPACE FOR LEASE | 2153 S. CENTURION PLACE | BOISE, ID 83709



**EASY I-84
ACCESS!**

CONTACT

CHRIS PEARSON, SIOR

208.947.0859
chris@tokcommercial.com

MIKE ARNOLD

208.957.5609
mikea@tokcommercial.com



HIGHLIGHTS



- HVAC throughout space.
- Great access to Interstate 84.
- Located just off Cole Road, near Costco.
- Single tenant building.
- Fenced and secured yard.

DETAILS



SUITE:	RSF:	RATE:
BUILDING B 2153	3,160 SF	\$1.10/SF NNN

Submarket:	Southwest	Grade Doors:	Two
Bldg Type:	Industrial	Parking:	Ample
Bldg Size:	3,160 SF	Lease Term:	3 - 5 Years
Zoning:	M-1D	Lease Type:	NNN
Available:	Immediately	Est. NNN:	\$0.45/SF

FLOOR PLAN | BUILDING B

SUITE:	RSF:	RATE:
Building B: 2153	3,160 SF	\$1.10/SF NNN

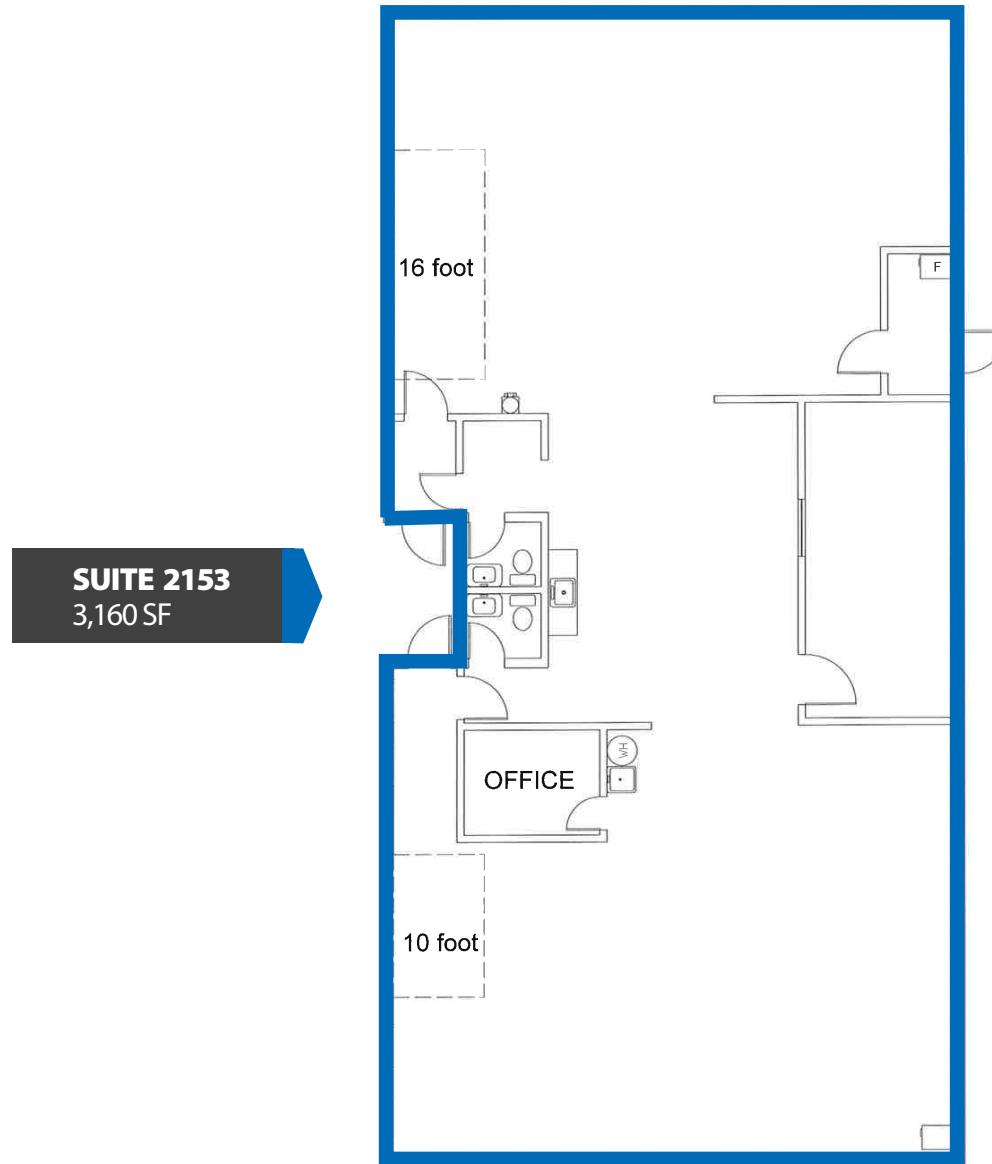

AERIAL

