

Office | For Sublease

CBRE

# Meadows Building

Central Expressway Office Market

5646 Milton Street  
Dallas, TX 75206

2,390 SF PLUG & PLAY



# Sublease Features

For Sublease

- + Suite 830 / 8th Floor
- + 2,390 SF
- + **Rate: \$20.50/SF +E**
- + Term thru February 28, 2025
- + Great Space for Start Up or Creative Tech User
- + Polished Concrete Floors
- + Exposed Finished Ceilings
- + Outdoor Terrace
- + Great Views of Park
- + Employee Balcony
- + Open Area
- + Large Office / Conference Room
- + Kitchen / Break Area
- + Furniture Negotiable
- + 3.00/1,000 SF Parking

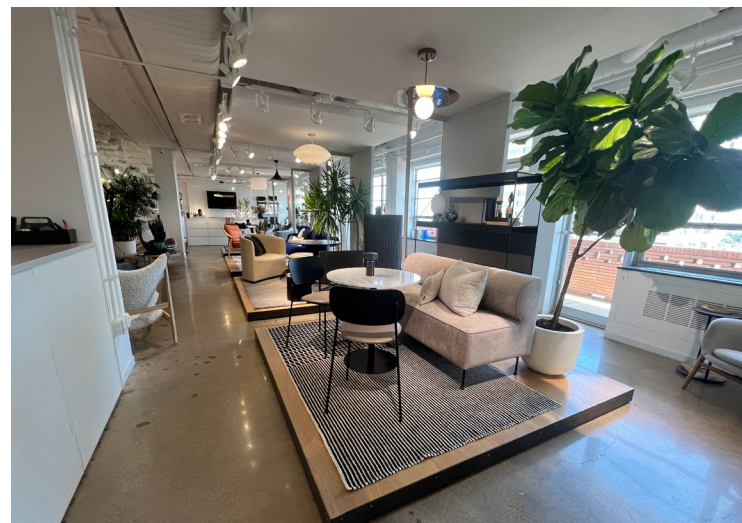
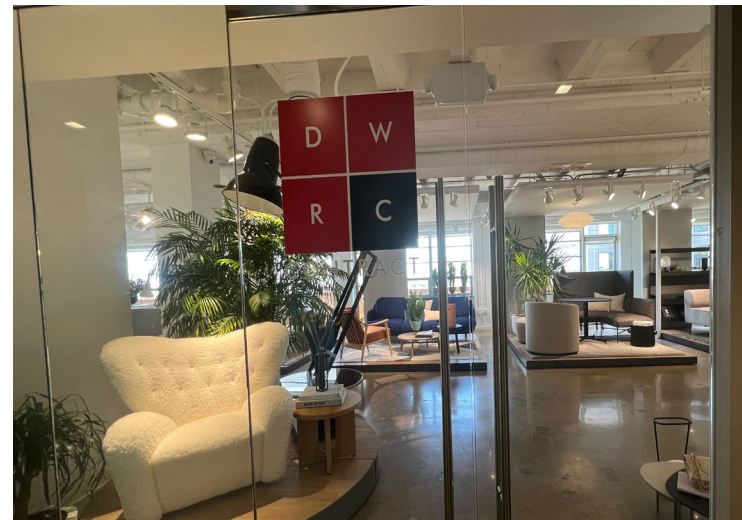

SUITE 830

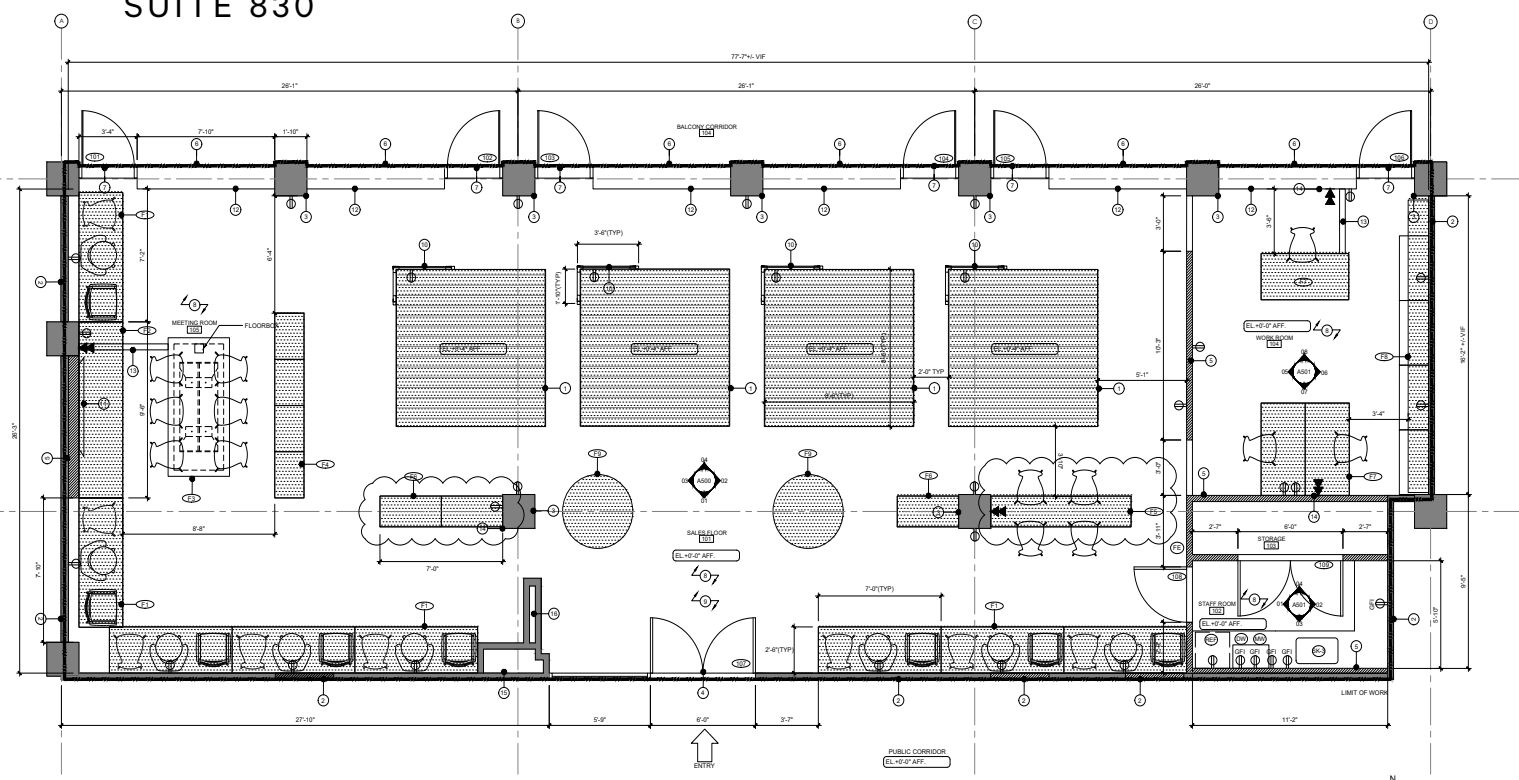



*Meadows  
Building*

Built in 1955, the Meadows building was city's first high rise building outside of downtown along the newly completed Central Expressway. The mid-century landmark building is ideal for design and creative fields. Renovated in 2019, it offers tenants structured parking beneath building, access to outdoor spaces and new campus park, campuswide Wi-Fi, amenities center access, and penthouse with 360 surrounding balcony.

## Contact Us

**Ryan Buchanan**  
First Vice President  
+1 214 979 6164  
ryan.buchanan@cbre.com  
Lic. 651491

**Chelby Sanders**  
Executive Vice President  
+1 214 979 6125  
chelby.sanders@cbre.com  
Lic. 511451

**Josh White**  
Executive Vice President  
+1 214 979 6198  
josh.white@cbre.com  
Lic. 495928

© 2022 CBRE, Inc. All rights reserved. This information has been obtained from sources believed reliable, but has not been verified for accuracy or completeness. You should conduct a careful, independent investigation of the property and verify all information. Any reliance on this information is solely at your own risk. CBRE and the CBRE logo are service marks of CBRE, Inc. All other marks displayed on this document are the property of their respective owners, and the use of such logos does not imply any affiliation with or endorsement of CBRE. Photos herein are the property of their respective owners. Use of these images without the express written consent of the owner is prohibited.