

REQUIREMENT, NEW OR USED, SHALL MEET ALL REQUIREMENTS OF THE CUMBERLAND CO. HEALTH DEPT.

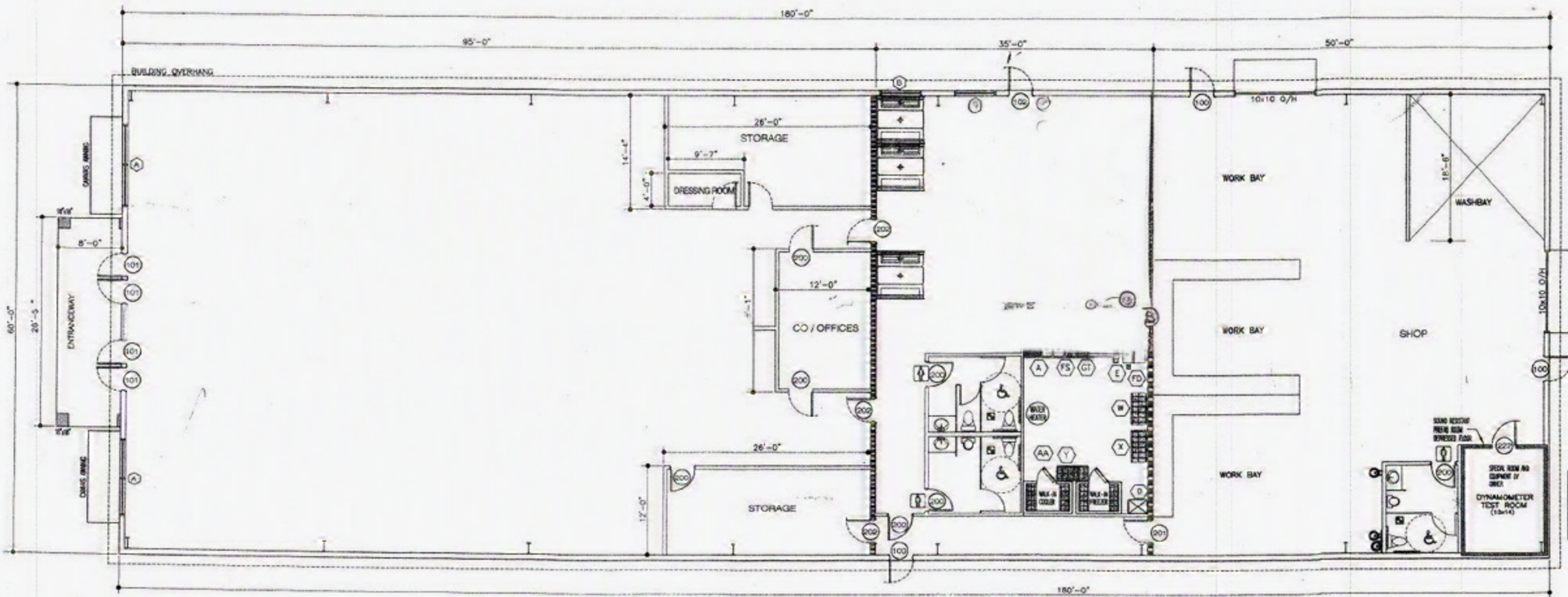

1 FLOOR PLAN
 W-1 1/8" = 1'-0"

IT IS UNDERSTOOD AND AGREED THAT THESE PLANS AND SPECIFICATIONS SHALL BE FULFILLED IN THEIR TRUE SPIRIT AND INTENT SO THAT ANY MINOR MATERIALS OR DEVICES ESSENTIAL TO PROPER AND CONVENIENT OPERATION, REQUIRED OR IMPLIED, SHALL BE SUPPLIED AND INSTALLED BY THE G.C. WITHOUT EXTRA CHARGE, EVEN THOUGH NOT SPECIFICALLY CALLED OUT OR SHOWN ON THE DRAWINGS.