

# Stowfield Cable works

Lydbrook, Gloucestershire  
GL17 9NG

All inclusive: From £5.00 per sq ft



Shows combined internal area of 2A1 and 2A2

Historic industrial site re-invented for modern requirements. The site comprises industrial and office buildings.

Suitable uses include logistics, storage, processing and office accommodation. Units can be fitted according to bespoke occupier requirements. Stowfield Cable Works is situated on the B4234 within 10 minutes of the A40 dual carriageway link to the motorway system (M50 and M4)

Building#2, Unit plan 2A2

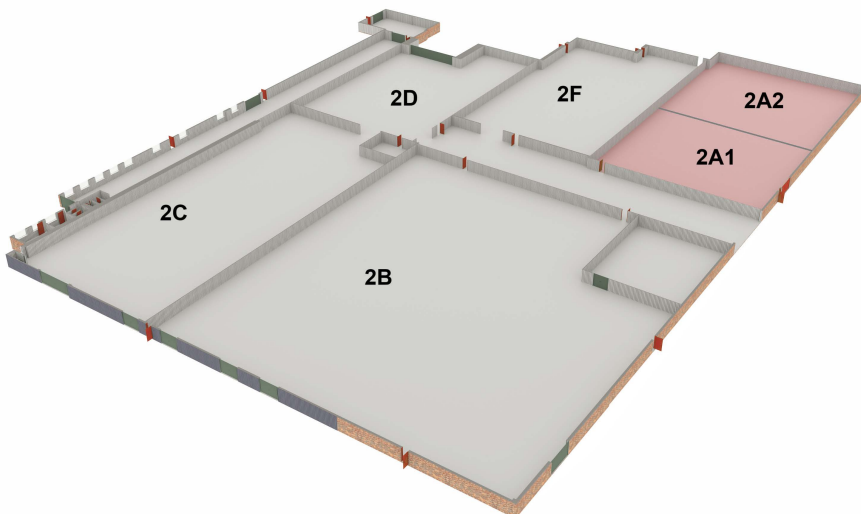

## Key Facts

Building #2

UNIT No: 2A2

UNIT SIZE: 9,258 sqft

RENT: From £3,857.50 pcm  
inc. service charge

Building size: 97,915 sq ft

Building units : 7

## Highlights of your unit:

- Private yard
- 6m eaves height
- Manned reception
- Historic business location

STOWFIELD CABLE WORKS  
LYDBROOK,  
GLOUCESTERSHIRE  
GL17 9NG

TEL : 0207 930 5724

[SALES@STOWFIELD.CO.UK](mailto:SALES@STOWFIELD.CO.UK)