

2.03. It is specially agreed that Landlord shall not be permitted to alter in any manner the parking areas or curb entrances and exits designated by cross-hatch markings on Exhibit "B" attached hereto (the "Prohibited Area"), or construct or place any building or other similar structure, in any part of the Common Areas shown on Exhibit "A-2", and shall only be permitted to reduce by no more than five (5) parking spaces the remaining parking area in the Shopping Center, without the prior written consent of Tenant.

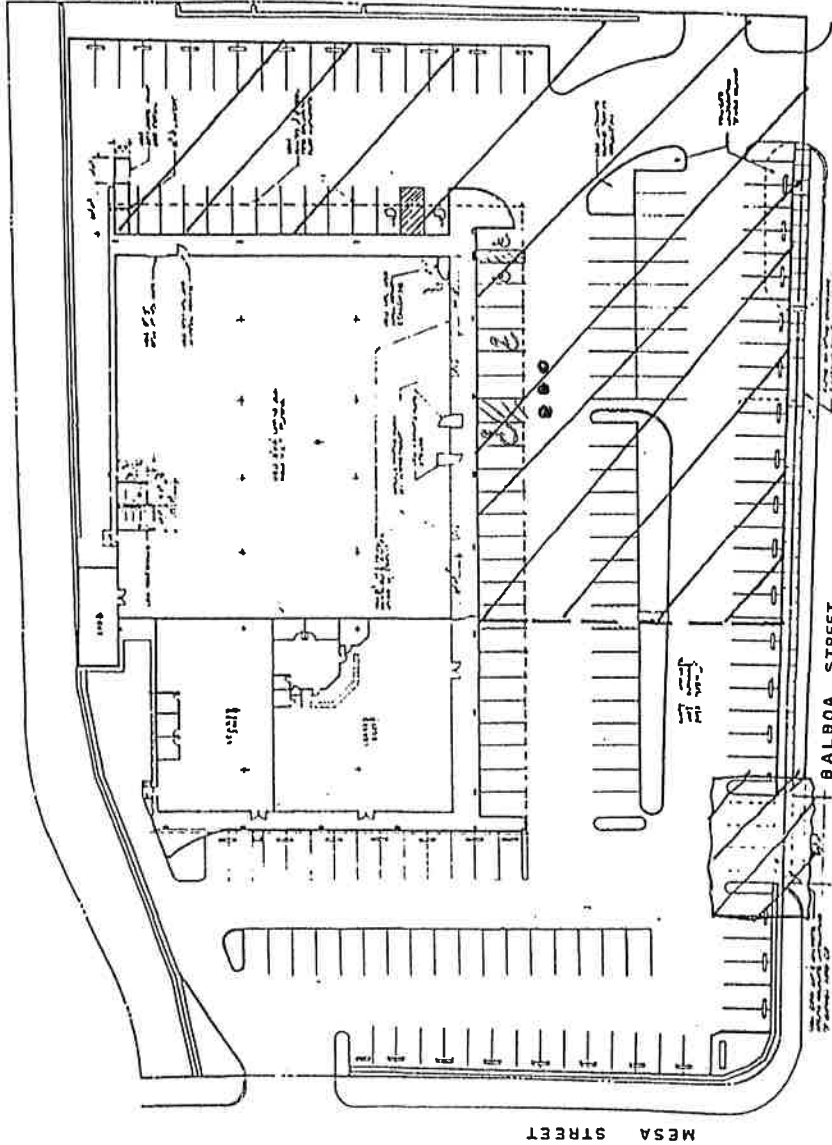

RAMP DETAIL



LOMAS CORONADO SITE PLAN

3	5	M	M	A	B	Y
LEASABLE AREA						
MAINTENANCE						
TOTAL						

Geoffrey Wright AIA & Associates
 2112 Marquette St., El Paso, Texas 79905 915/313-3777
 A-1

"Prohibited Area", as provided in Section 2.03 of the Lease.
 EXHIBIT "B"