

INDUSTRIAL

FOR SALE



**11990 RIVERA ROAD,
SANTA FE SPRINGS, CA 90670**

Property Features:

- 8,990 Square Foot Freestanding Building
- Approximately 1,300 Square Feet of Office
- 16' Clear Height; Three (3) Ground Level Doors
- Fully Concrete Parking and Loading Areas
- Immediate Access to I-605
- Excellent North Santa Fe Springs Location
- Central to Los Angeles and Orange Counties
- For Aerial Video: www.11990rivera.com

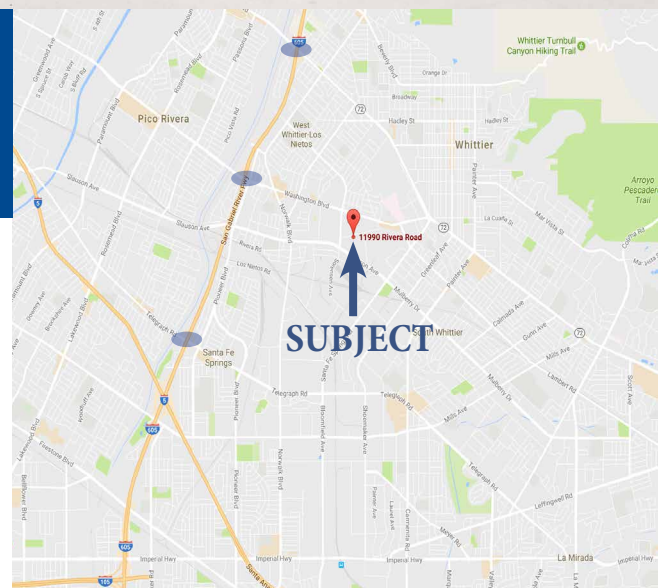

For More Information, Contact:

Tyler Portman

Direct: (562) 762 - 3152

tyler@gmpropertiesinc.com

Liam Hayes

Direct: (562) 762 - 3114

liam@gmpropertiesinc.com



The information contained herein was obtained from sources we believe to be accurate, but is for information purposes only. Potential tenants and buyers are recommended to verify and perform its own due diligence. GM Properties or the Owner does not represent or warrant any of this information. CalBRE #01238514

8,990 SF

INDUSTRIAL

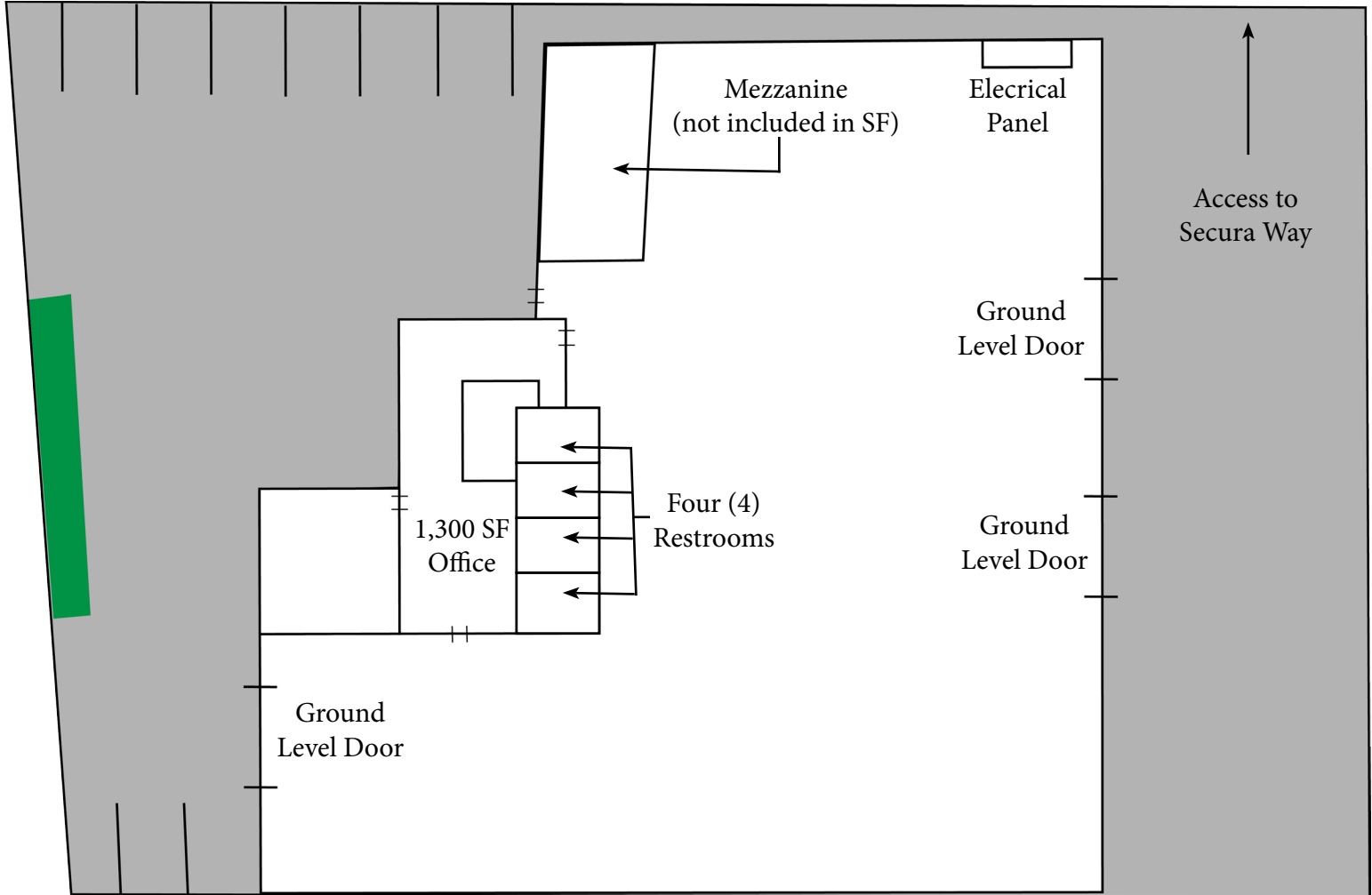

For More Information, Contact:

Tyler Portman

Direct: (562) 762 - 3152

tyler@gmpropertiesinc.com

Liam Hayes

Direct: (562) 762 - 3114

liam@gmpropertiesinc.com



The information contained herein was obtained from sources we believe to be accurate, but is for information purposes only. Potential tenants and buyers are recommended to verify and perform its own due diligence. GM Properties or the Owner does not represent or warrant any of this information. CalBRE #01238514