

Lower Level Floor Plan

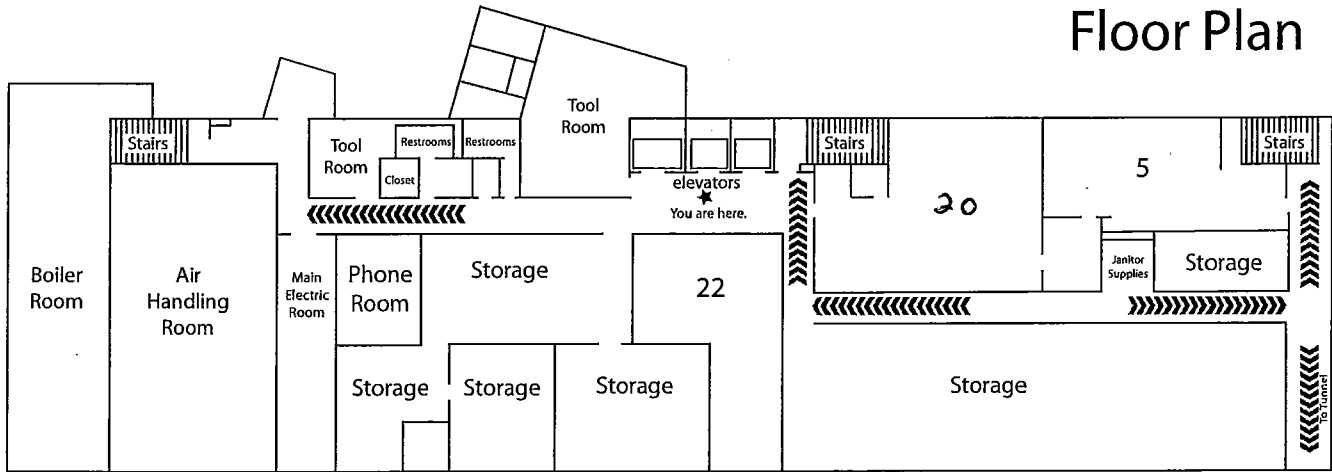

*In the event of an emergency, please follow guided arrows to nearest stairwell exit.

FIRST FLOOR PLAN

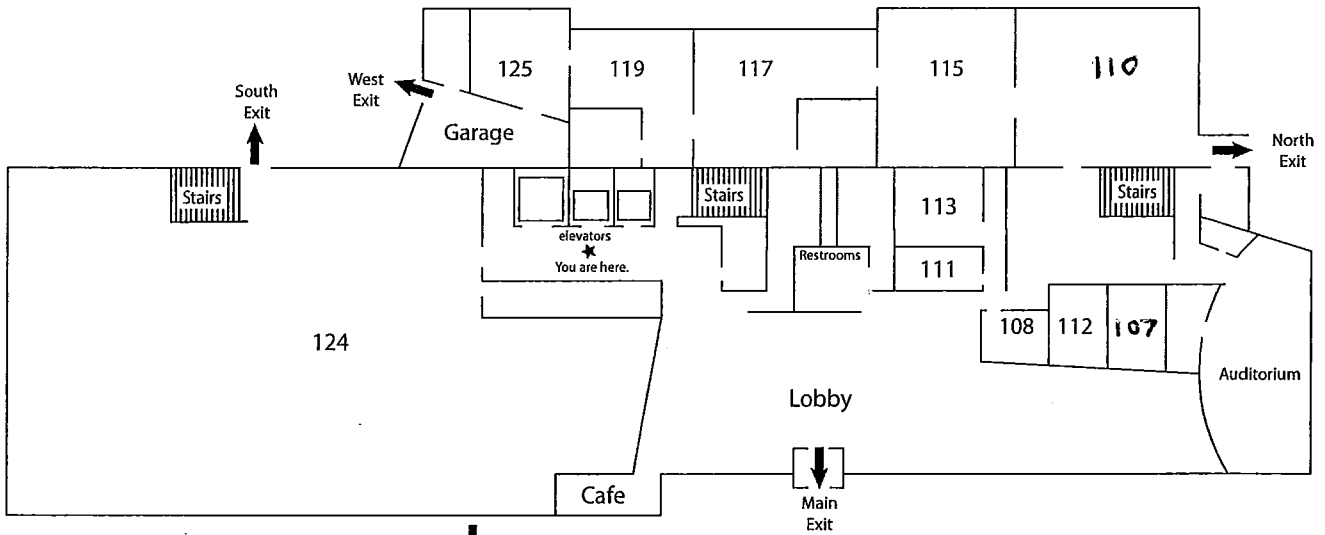

*In the event of an emergency, please locate your nearest exit as indicated by ↓.

SECOND FLOOR PLAN

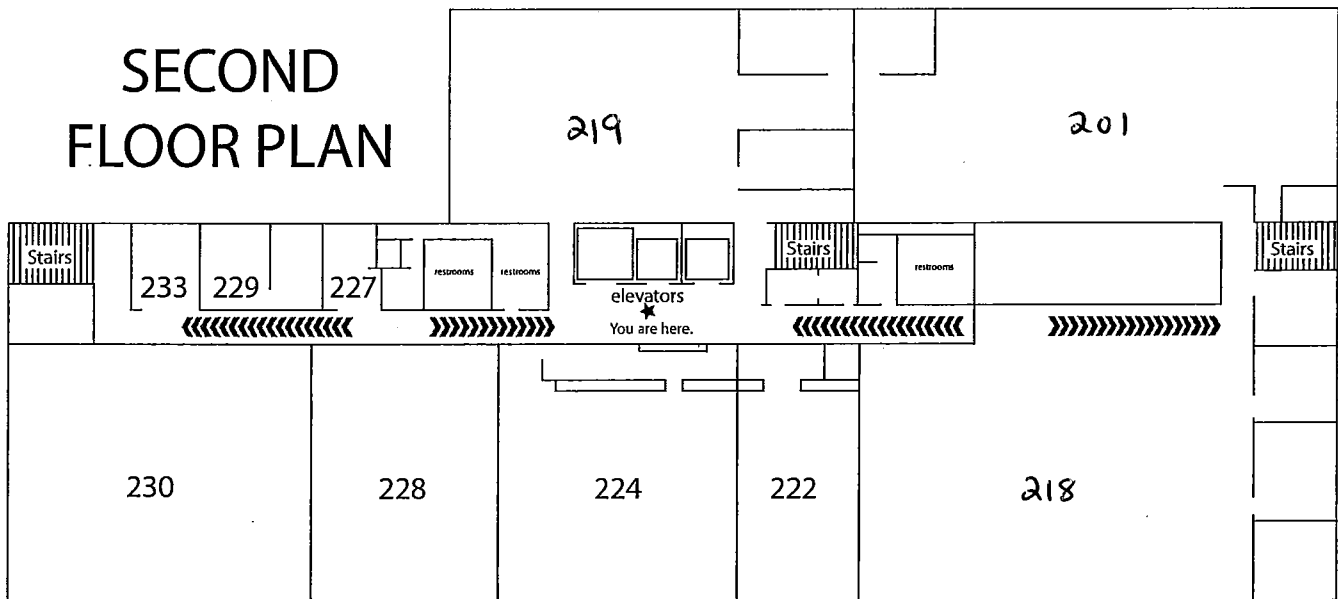

*In the event of an emergency, please follow guided arrows to nearest stairwell exit.

THIRD FLOOR PLAN

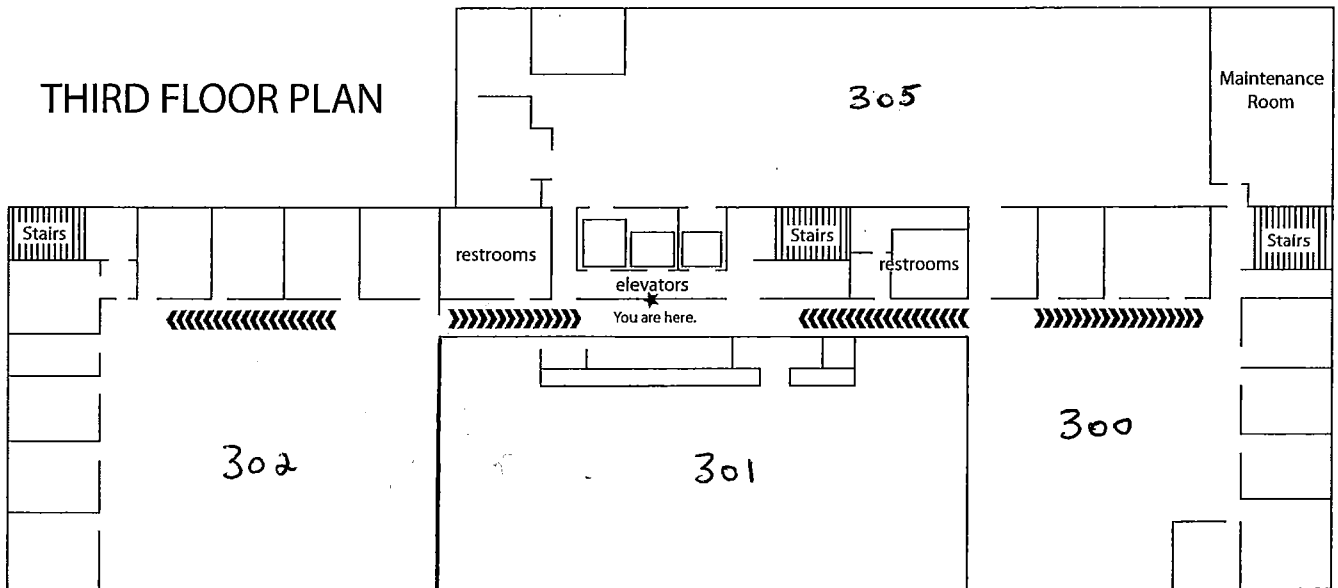

*In the event of an emergency, please follow guided arrows to nearest stairwell exit.

FOURTH FLOOR PLAN

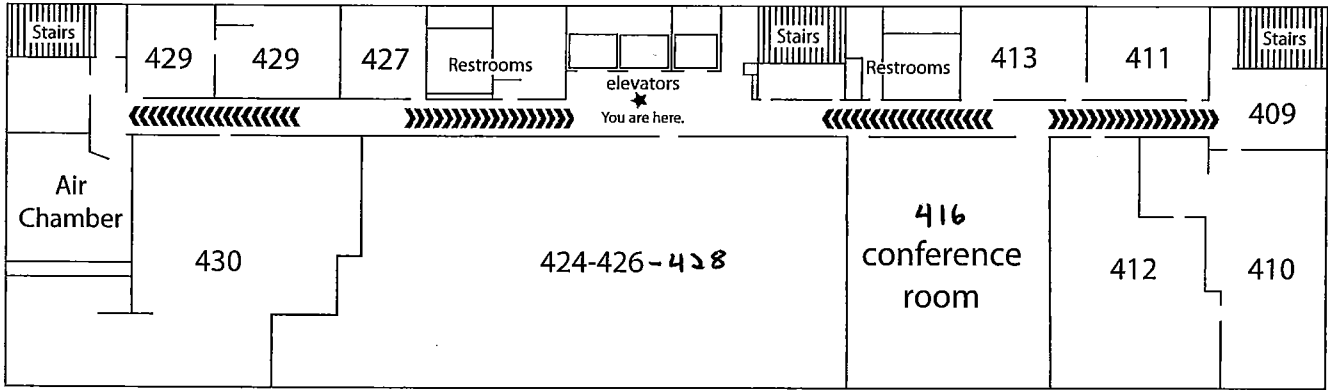

*In the event of an emergency, please follow guided arrows to nearest stairwell exit.

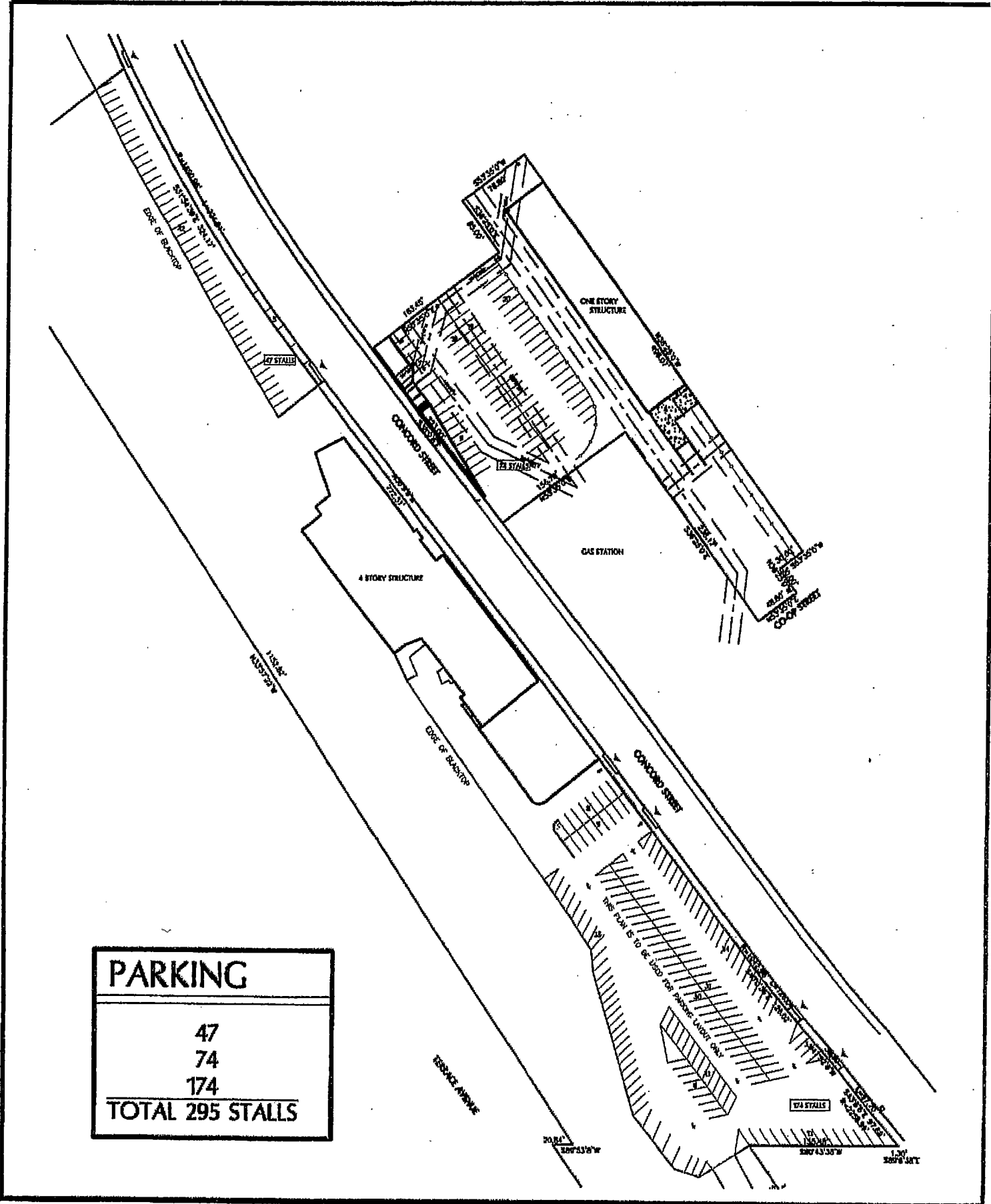

PARKING	
47	
74	
174	
TOTAL 295 STALLS	