

46480 CONTINENTAL DRIVE  
CHESTERFIELD TWP., MICHIGAN



**SIGNATURE  
ASSOCIATES**  
KNOW SIGNATURE | KNOW RESULTS

INDUSTRIAL FOR LEASE  
62,529 Square Feet Available



## PROPERTY FEATURES

- 62,529 square feet available
- 18,877 square feet office
- 18' - 19' clear height
- (4) 12' x 14' grade level doors, (2) truckwells
- (5) 2-5 ton cranes
- 2000 amps, 480 volts, primary power – buss duct throughout
- Seconds from I-94
- Completely upgraded, fully functional former injection mold facility
- Plenty of upgrades: epoxy flooring, restrooms, painted shop (walls and ceiling)
- Includes private executive parking garage, water tower, and chiller
- Lease Rate: \$7.95/sq. ft. NNN

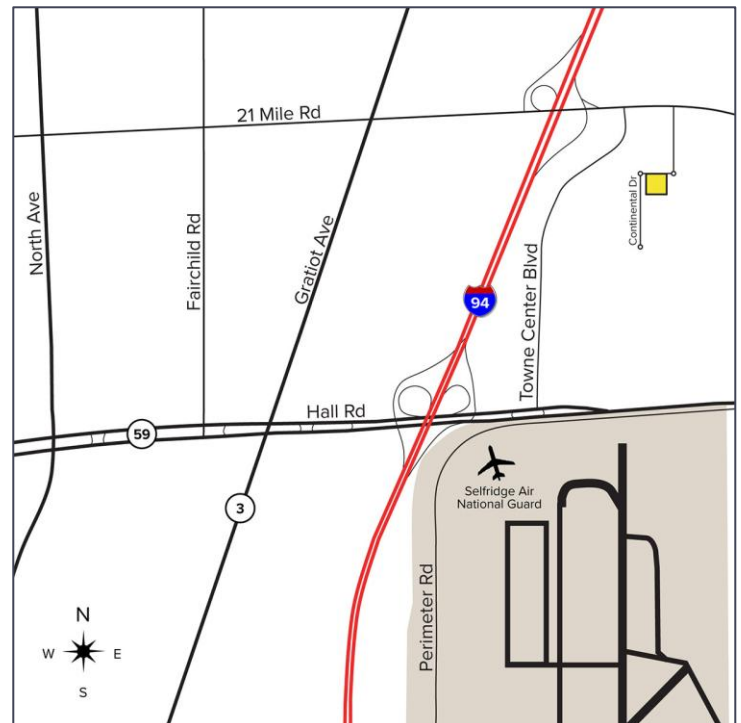

For more information, please contact:

**BEN WILKIEMEYER**  
(248) 359 0624  
bwilkiemeyer@signatureassociates.com

**PAUL SAAD**  
(248) 359 0652  
psaad@signatureassociates.com

**SIGNATURE ASSOCIATES**  
One Towne Square, Suite 1200  
Southfield, MI 48076  
www.signatureassociates.com

# 46480 Continental Drive – Chesterfield Twp., MI

## Industrial For Lease

62,529  
Square Feet  
AVAILABLE

### Site Plan

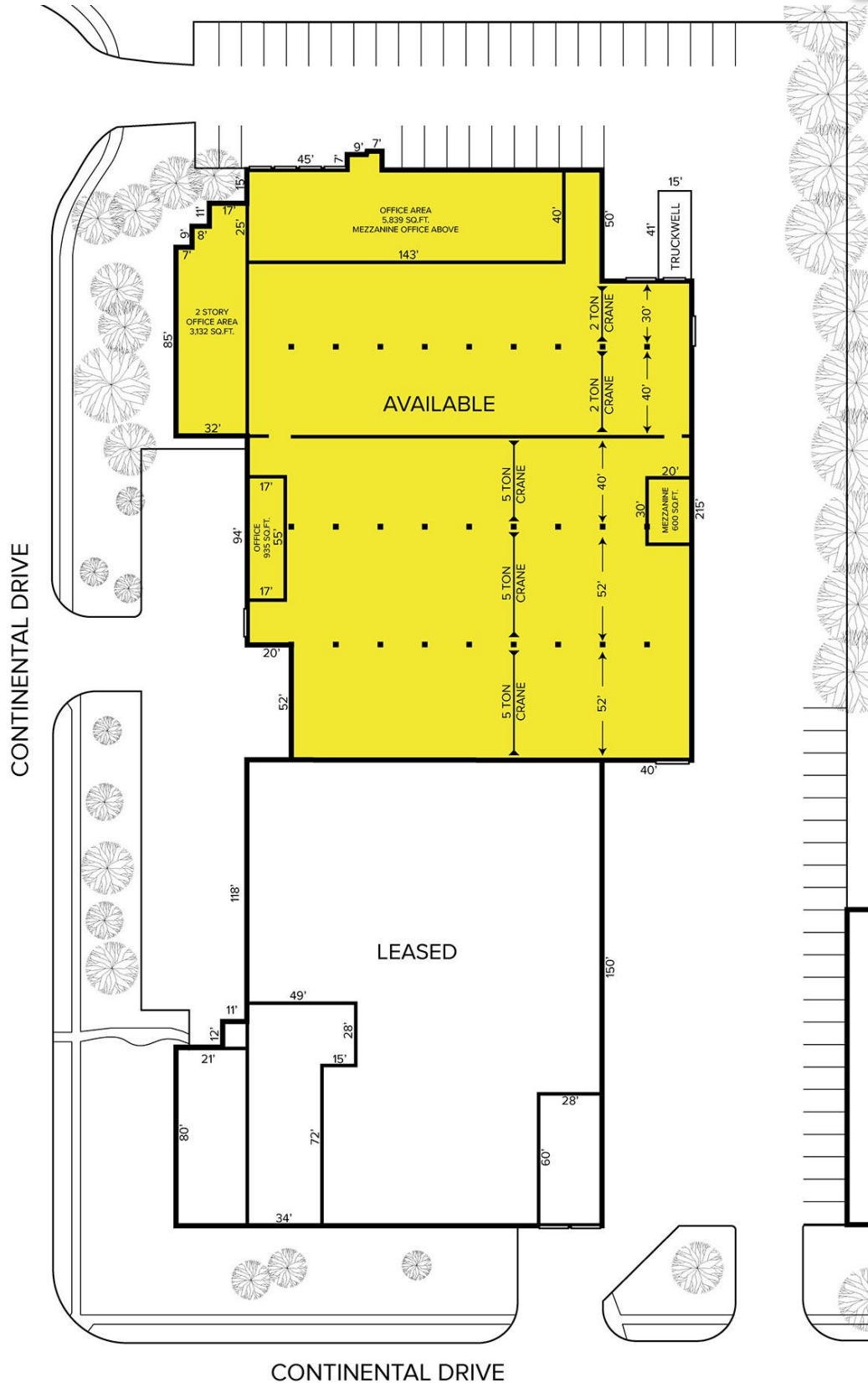

For more information, please contact:

**BEN WILKIEMEYER**  
(248) 359 0624  
bwilkiemeyer@signatureassociates.com

**PAUL SAAD**  
(248) 359 0652  
psaad@signatureassociates.com

**SIGNATURE ASSOCIATES**  
One Towne Square, Suite 1200  
Southfield, MI 48076  
www.signatureassociates.com

# 46480 Continental Drive – Chesterfield Twp., MI

Industrial For Lease

62,529  
Square Feet  
AVAILABLE

Aerial



For more information, please contact:

**BEN WILKIEMEYER**  
(248) 359 0624  
bwilkiemeyer@signatureassociates.com

**PAUL SAAD**  
(248) 359 0652  
psaad@signatureassociates.com

**SIGNATURE ASSOCIATES**  
One Towne Square, Suite 1200  
Southfield, MI 48076  
www.signatureassociates.com