





PLANTING NOTES:

1. THE LAYOUT OF ALL PLANTING BEDS AND INDIVIDUAL TREES SHALL BE STAKED BY THE CONTRACTOR IN ADVANCE OF INSTALLATION. FLAGGING, STAKES, OR PAINT MAY BE USED TO DELINEATE LOCATIONS AS SCALED FROM THE PLANS. THE LANDSCAPE ARCHITECT WILL REVIEW THESE LOCATIONS WITH THE CONTRACTOR AND MAKE MINOR ADJUSTMENTS AS NECESSARY. BED LAYOUT SHALL ALSO INCLUDE PERENNIAL GROUPINGS BY SPECIES.
2. THE CONTRACTOR IS RESPONSIBLE FOR INDEPENDENTLY DETERMINING THE PLANT MATERIAL QUANTITIES REQUIRED BY THE LANDSCAPE PLANS. REPORT ANY DISCREPANCIES TO THE LANDSCAPE ARCHITECT.
3. AREAS UNDER PLANTING BEDS SHALL NOT CONTAIN COMPACTED AGGREGATE TO ALLOW FOR PROPER DRAINAGE AND GROWTH OF PLANT MATERIAL. REMOVE AGGREGATE AND PERFORM SUBSOILING AS NECESSARY TO OBTAIN LOOSE, FREE DRAINING SUBGRADE BELOW PLANTING BEDS. UNDESIRABLE CONDITIONS SHALL BE BROUGHT TO THE ATTENTION OF THE LANDSCAPE ARCHITECT PRIOR TO BEGINNING OF WORK. IT SHALL BE THE CONTRACTOR'S RESPONSIBILITY TO ENSURE PROPER SURFACE AND SUBSURFACE DRAINAGE IN ALL AREAS.
4. ALL SEED AREAS SHALL RECEIVE A MINIMUM OF 4" DEPTH OF TOPSOIL
5. ALL PLANTING BEDS SHALL RECEIVE 12" DEPTH OF PREPARED SOIL.
6. NEW SEEDED AREAS TO BE TREATED WITH HERBICIDE TO KILL ALL EXISTING GROUNDCOVER. THERE SHALL BE A MINIMUM OF TWO (2) APPLICATIONS SEPARATED BY 10 DAYS. IF ALL EXISTING GROUNDCOVER VEGETATION IS NOT KILLED WITHIN 10 DAYS OF 2ND APPLICATION, A 3RD APPLICATION IS REQUIRED.
7. NEWLY SEEDED AREAS SHALL BE BLENDED INTO EXISTING LAWN TO CREATE A SMOOTH TRANSITION.
8. ALL DISTURBED AREAS OUTSIDE THE LIMITS OF WORK SHALL BE RESTORED TO ORIGINAL OR BETTER CONDITION AT NO ADDITIONAL COST TO THE OWNER.
9. TRENCHED EDGE TYPICAL OF ALL PLANTING BEDS.
10. ALL PLANTING BEDS AND PLANTED TREES SHALL BE MULCHED WITH 3" DEEP SHREDDED HARDWOOD MULCH PER PLANTING DETAILS. MULCH SHALL BE CONSIDERED INCIDENTAL TO PLANT MATERIALS
11. NO PLANT MATERIAL SUBSTITUTIONS WILL BE ACCEPTED UNLESS APPROVAL BY THE LANDSCAPE ARCHITECT. ALL PLANT MATERIAL AND SEED SHALL BE PROVIDED FROM A NURSERY (WITHIN 200 MILES) WITH A SIMILAR PLANT HARDINESS ZONE AS PROJECT LOCATION.
12. CONTRACTOR IS RESPONSIBLE FOR ON-GOING MAINTENANCE OF ALL NEWLY INSTALLED MATERIALS UNTIL TIME OF OWNER ACCEPTANCE. ANY ACTS OF VANDALISM OR DAMAGE WHICH MAY OCCUR PRIOR TO OWNER ACCEPTANCE SHALL BE THE RESPONSIBILITY OF THE CONTRACTOR
13. PROVIDE 1 YEAR WARRANTY ON ALL PLANT MATERIAL.
14. LAWN SEED SHALL BE ESTABLISHED BY THE CONTRACTOR TO A DENSE, GREEN CONSISTENT LAWN VOID OF ANY BARE OR PATCHY AREAS LARGER THAN 3"x3"
15. SEED PRIOR TO OCT. 15. IF SEEDED AFTER OCT. 15, MAINTAIN AND ESTABLISH LAWN UNTIL SPRING REVIEW

LANDSCAPE POINTS REQUIREMENTS:

PAVED AREA

47,626 SF = 429 POINTS REQ.  
EXISTING POINTS PROVIDED - 92  
NEW POINTS PROVIDED - 399  
TOTAL POINTS PROVIDED - 491

PARKING LOT STREET YARD - HWY 33

275 LF = 220 POINTS REQ.  
EXISTING POINTS PROVIDED - 0  
NEW POINTS PROVIDED - 272  
TOTAL POINTS PROVIDED - 272

UNDESIGNATED AREA

40,000 SF = 640 POINTS REQ.  
EXISTING POINTS PROVIDED - 405  
NEW POINTS PROVIDED - 252  
TOTAL POINTS PROVIDED - 657

PARKING LOT STREET YARD - SWEETWATER BLVD.

125 LF = 100 POINTS REQ.  
EXISTING POINTS PROVIDED - 50  
NEW POINTS PROVIDED - 60  
TOTAL POINTS PROVIDED - 110

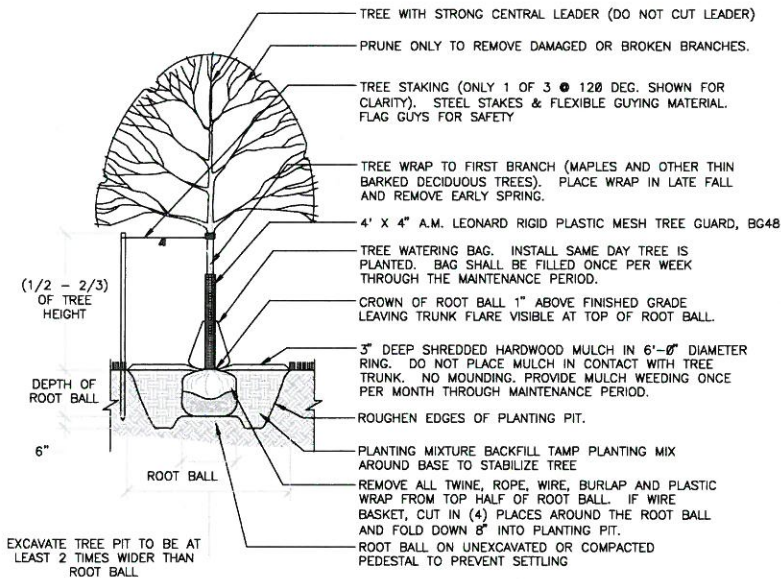

1 TREE PLANTING

1/4" = 1'-0"

329343-01

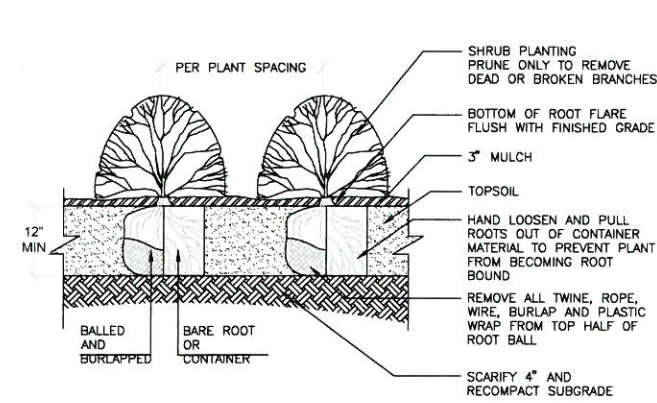

BAREROOT PLANTING NOTES

1. SOAK ROOTS IN WATER FOR AT LEAST ONE HOUR BUT NOT MORE THAN 24 HOURS PRIOR TO PLANTING
2. SCARIFY SIDES AND BOTTOMS OF HOLE
3. PROCEED WITH CORRECTIVE PRUNING OF THE TOP AND BOTTOM ROOTS
4. TRANSFER PLANT DIRECTLY FROM WATER TO HOLE. SET PLANT SO THE ROOT FLARE IS APPROXIMATELY AT THE FINISHED SOIL ELEVATION. SPREAD ROOTS OUT EVENLY. PLUMB AND IMMEDIATELY BACKFILL WITH PLANTING SOIL MIX
5. WATER THOROUGHLY WITHIN 2 HOURS TO SETTLE PLANTS AND FILL VOIDS
6. BACKFILL VOIDS AND WATER SECOND TIME
7. PLACE MULCH WITHIN 48 HOURS OF THE SECOND WATERING UNLESS SOIL MOISTURE IS EXCESSIVE

2 SHRUB PLANTING

1/2" = 1'-0"

329333-02

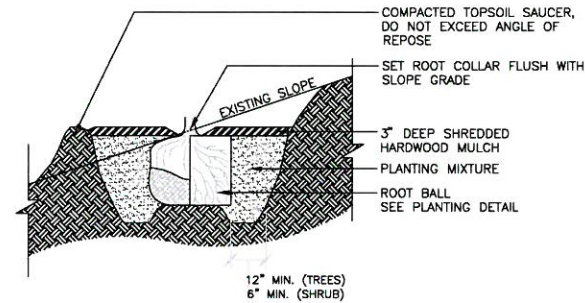

3 TREE PLANTING ON SLOPE

3/8" = 1'-0"

329343-02

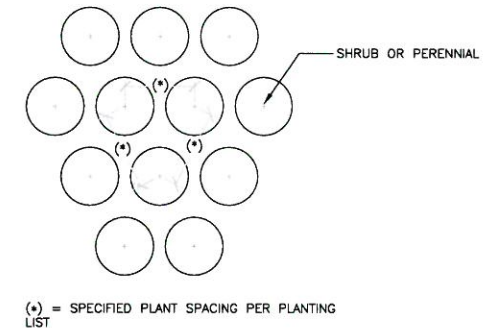

4 PLANT SPACING DETAIL

1/2" = 1'-0"

3293-02

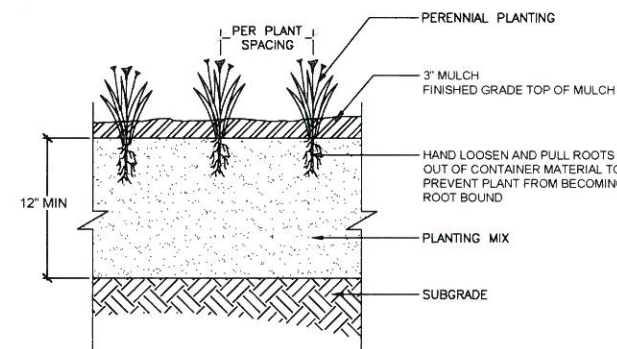

5 PERENNIAL PLANTING DETAIL

1" = 1'-0"

3293-01

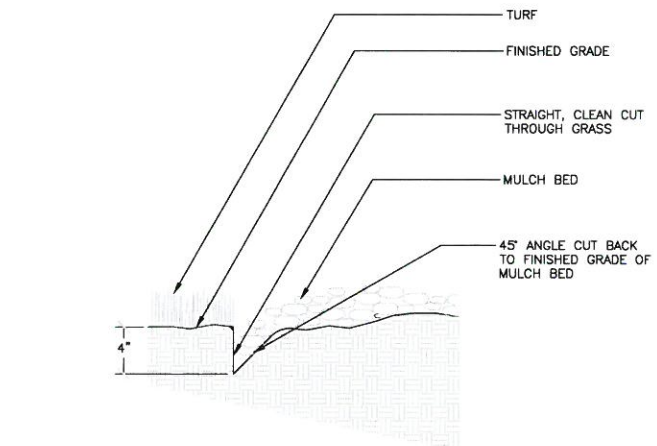

6 TRENCHED EDGE DETAIL

N.T.S.

329413.23-02

DRAWN BY: DJB	NO.	BY	DATE	REVISIONS
DESIGNER: DJB				
CHECKED BY: -				
DESIGN TEAM				



HIDDEN HILLS COMMERCIAL  
PARKING LOT EXPANSION & REPAVING  
CITY OF PORT WASHINGTON, WISCONSIN

NOTES & DETAILS

FILE NO. 136768	2
DATE 04/06/2017	2