

Account Identifier: District - 03 Account Number - 0316002471

Owner Information

Owner Name: PAHL LESLIE C SR Use: COMMERCIAL
PAHL MARY J Principal Residence: NO
Mailing Address: 4211 BUCKINGHAM RD Deed Reference: /04617/ 00589
BALTIMORE MD 21207

Location & Structure Information

Premises Address: 4223 BEDFORD RD Legal Description:
0-0000 440FT E OF CAMPFIELD RD

Map: 0078 Grid: 0020 Parcel: 0622 Sub District: Subdivision: 0000 Section: Block: Lot: Assessment Year: 2016 Plat No: Plat Ref:
Special Tax Areas: Town: NONE
Ad Valorem:
Tax Class:
Primary Structure Built 1958 Above Grade Enclosed Area 1216 Finished Basement Area Property Land Area 2.8300 AC County Use 06

Stories Basement Type Exterior Full/Half Bath Garage Last Major Renovation
STORAGE GARAGE

Value Information

Base Value Value Phase-in Assessments
As of As of As of
01/01/2016 07/01/2015 07/01/2016
Land: 180,400 180,400
Improvements 30,500 30,800
Total: 210,900 211,200 210,900 211,000
Preferential Land: 0 0

Transfer Information

Seller: Date: Price:
Type: Deed1: Deed2:
Seller: Date: Price:
Type: Deed1: Deed2:
Seller: Date: Price:
Type: Deed1: Deed2:

Exemption Information

Partial Exempt Assessments: Class 07/01/2015 07/01/2016
County: 000 0.00
State: 000 0.00
Municipal: 000 0.00|0.00 0.00|0.00
Tax Exempt: Special Tax Recapture:
Exempt Class: NONE

Homestead Application Information

Homestead Application Status: No Application

Account Identifier: District - 03 Account Number - 0316002470

Owner Information

Owner Name: PAHL LESLIE C SR Use: RESIDENTIAL
PAHL MARY J Principal Residence: YES
Mailing Address: 4211 BUCKINGHAM RD Deed Reference: /03480/ 00604
BALTIMORE MD 21207-4615

Location & Structure Information

Premises Address: 4211 BUCKINGHAM RD Legal Description: .09 AC SS BUCKINGHAM
0-0000 NR CAMPFIELD RD

Map: 0078 Grid: 0020 Parcel: 0622 Sub District: Subdivision: 0000 Section: Block: Lot: Assessment Year: 2017 Plat No: Plat Ref:

Special Tax Areas: Town: NONE
Ad Valorem:
Tax Class:

Primary Structure Built 1959 Above Grade Enclosed Area 2,028 SF Finished Basement Area Property Land Area 39,204 SF County Use 04

Stories 1 1/2 Basement YES Type STANDARD UNIT Exterior BRICK Full/Half Bath 2 full Garage 1 Detached Last Major Renovation

Value Information

Base Value Value Phase-in Assessments
As of As of As of
01/01/2014 07/01/2016 07/01/2017
Land: 69,200 69,200
Improvements 162,200 162,200
Total: 231,400 231,400 231,400
Preferential Land: 0

Transfer Information

Seller: Date: Price:
Type: Deed1: Deed2:

Seller: Date: Price:
Type: Deed1: Deed2:

Seller: Date: Price:
Type: Deed1: Deed2:

Exemption Information

Partial Exempt Assessments: Class 07/01/2016 07/01/2017
County: 000 0.00
State: 000 0.00
Municipal: 000 0.00 0.00

Tax Exempt: Special Tax Recapture:
Exempt Class: NONE

Homestead Application Information

Homestead Application Status: Approved 12/31/2012



**Account Identifier:** District - 03 **Account Number -** 2200014384

**Owner Information**

**Owner Name:** PAHL LESLIE C PAHL MARY JANE  
PAHL LESLIE C JR PAHL PAMELA B  
**Use:** RESIDENTIAL  
**Principal Residence:** NO  
**Mailing Address:** 4211 BUCKINGHAM RD  
BALTIMORE MD 21207-4615  
**Deed Reference:** /09501/ 00381

**Location & Structure Information**

**Premises Address:** 7210 PAHLS FARM WAY  
0-0000  
**Legal Description:** 7210 PAHLS FARM WAY SWS  
BEDFORD CROSSING

Map:	Grid:	Parcel:	Sub District:	Subdivision:	Section:	Block:	Lot:	Assessment Year:	Plat No:	Plat Ref:	
0078	0014	0274		0000			13	2017			1
											0064/ 0099

**Special Tax Areas:**  
**Town:** NONE  
**Ad Valorem:**  
**Tax Class:**

Primary Structure Built	Above Grade Enclosed Area	Finished Basement Area	Property Land Area	County Use
1895	2,058 SF		32,879 SF	04

Stories	Basement	Type	Exterior	Full/Half Bath	Garage	Last Major Renovation
2	YES	STANDARD UNIT	SIDING	2 full		

**Value Information**

	Base Value	Value	Phase-in Assessments	
		As of 01/01/2014	As of 07/01/2016	As of 07/01/2017
<b>Land:</b>	77,900	77,900		
<b>Improvements</b>	71,900	71,900		
<b>Total:</b>	149,800	149,800	149,800	
<b>Preferential Land:</b>	0			

**Transfer Information**

**Seller:** PAHL LESLIE C, JR  
**Type:** NON-ARMS LENGTH OTHER  
**Date:** 12/10/1992  
**Deed1:** /09501/ 00381  
**Price:** \$0  
**Deed2:**

**Seller:** BEDFORD CROSSING LTD PARTNERSHIP  
**Type:** NON-ARMS LENGTH OTHER  
**Date:** 12/10/1992  
**Deed1:** /00000/ 00000  
**Price:** \$1  
**Deed2:**

**Seller:**  
**Type:**  
**Date:**  
**Deed1:**  
**Price:**  
**Deed2:**

**Exemption Information**

Partial Exempt Assessments:	Class	07/01/2016	07/01/2017
<b>County:</b>	000	0.00	
<b>State:</b>	000	0.00	
<b>Municipal:</b>	000	0.00l	0.00l

**Tax Exempt:**  
**Exempt Class:**  
**Special Tax Recapture:**  
NONE

**Homestead Application Information**

**Homestead Application Status:** No Application

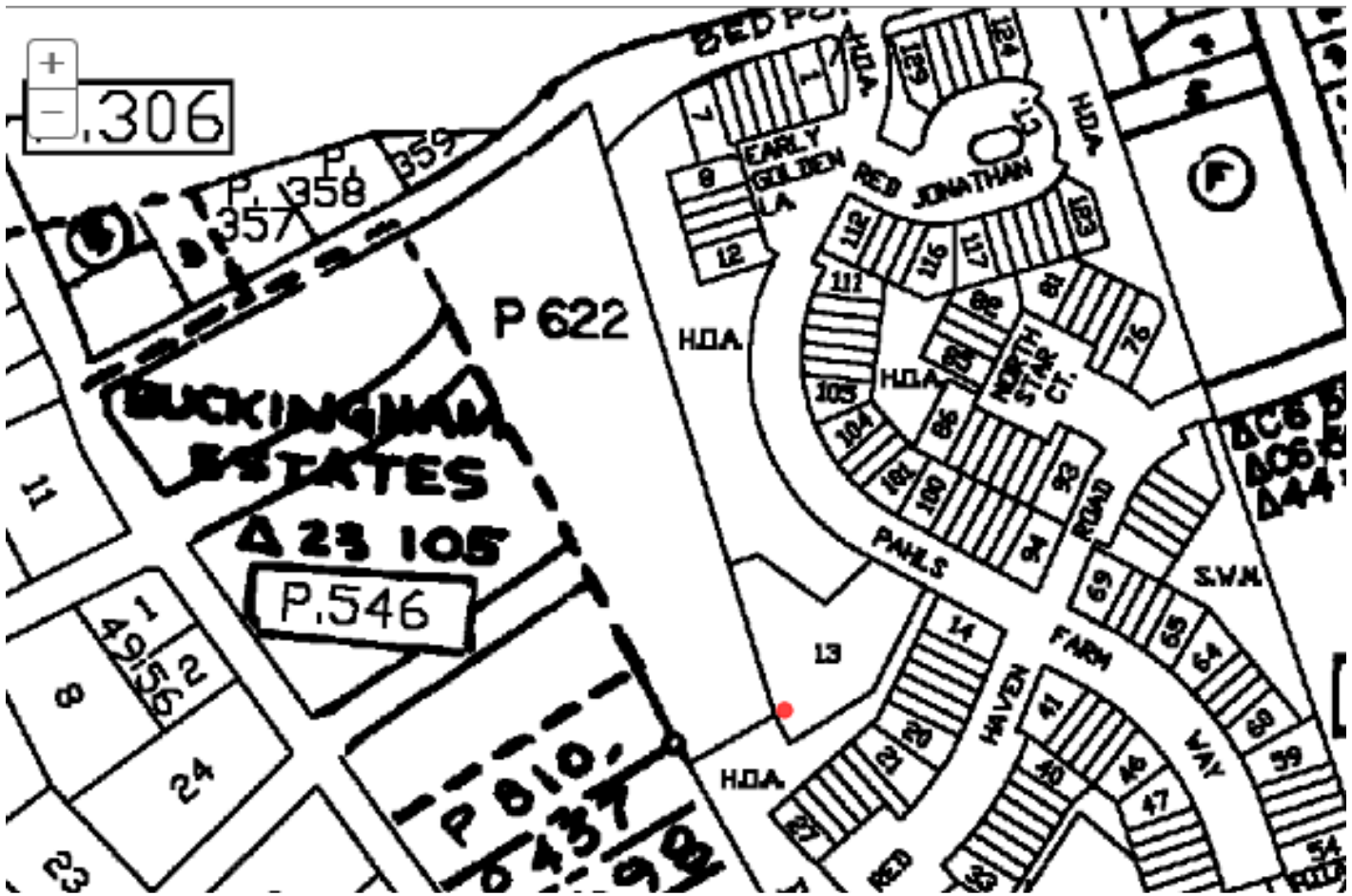

+  
- .306

**BUCKINGHAM ESTATES**

**Δ 23 105**

**P.546**

**P.622**

**P.010**  
**0437**  
**99**

**ACB**  
**ACB**  
**444**