

**MITCHELL STREET
LOCAL ROAD
SPEED LIMIT: 40 MPH
R.O.W.: 60 FEET**

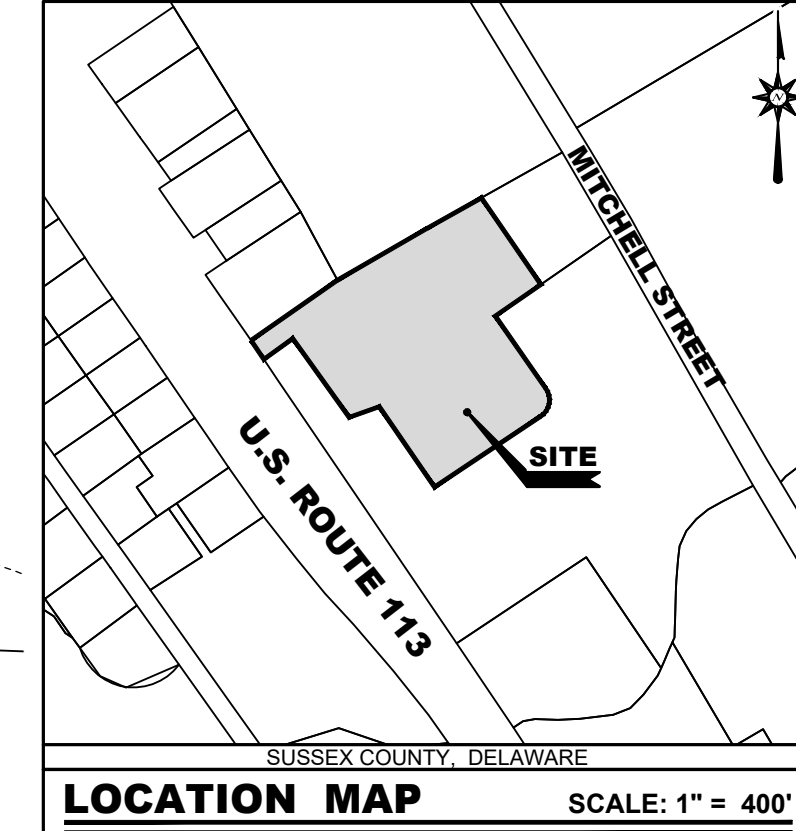

TM 233-5.00-2.00
N/F
J.L. PARKER, SR. FAMILY LP
DEED REF, DB: 3705 PG: 148
ZONING HR

TM 133-17.00-76.00
N/F
LIBORIO BURTONS LLC
DEED REF, DB: 4192 PG: 77
ZONING HR

EXISTING BUILDING
TM 133-21.00-4.00
N/F
MID SUSSEX ASSOCIATES
DEED REF, DB: 2181 PG: 342
ZONING HC
10.02 ± A.C.

EXISTING BUILDING
FOOTPRINT: 39,530 S.F.
F.F. ELEVATION: 23.70 ±

TM 133-21.00-4.02
N/F
DELAWARE NATIONAL BANK
DEED REF, DB: 2182 PG: 9
ZONING HC

SPACE RESERVED FOR
FUTURE OUT PARCEL
DEVELOPMENT
1.28 AC ±

SPACE RESERVED FOR
FUTURE OUT PARCEL
DEVELOPMENT
2.05 AC ±

TM 133-21.00-4.01
N/F
TRES TACUACHES LLC
DEED REF,
DB: 3803 PG: 288
ZONING HC

TM 2:
M J DEVE
DEED REF,
ZO

BECKER MORGAN GROUP
ARCHITECTURE
ENGINEERING
Delaware
309 South Governors Avenue
Dover, DE 19904
302.734.7950
The Tower at STAR Campus
100 Discovery Boulevard, Suite 102
Newark, DE 19713
302.369.3700
Maryland
312 West Main Street, Suite 300
Salisbury, MD 21801
410.546.9100
North Carolina
3333 Jaeckle Drive, Suite 120
Wilmington, NC 28403
910.341.7600
www.beckermorgan.com

PROJECT TITLE
LANDS OF MILLSBORO CARPET MART LLC AND MID SUSSEX ASSOCIATES
28587 DUPONT BOULEVARD
MILLSBORO
SUSSEX COUNTY, DE

SHEET TITLE
LEASED PARKING EXHIBIT

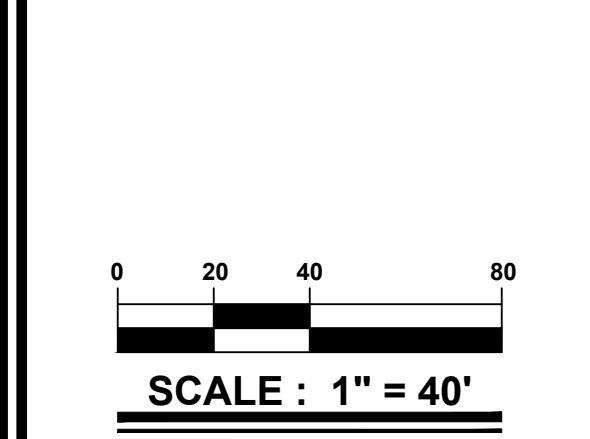

ISSUE	DATE	DESCRIPTION
1	1/6/23	UPDATE TO SHOW UTILITIES
<p>PROJECT NO.: 2020155.02 DATE: 03/09/2022 SCALE: 1" = 40" DRAWN BY: J.D.M. PROJ. MGR.: C.D.C.</p>		
<p>PARKING 1</p>		

SOUTH DUPONT BOULEVARD (U.S. ROUTE 113)
OTHER PRINCIPAL ARTERIALS
SPEED LIMIT: 55 MPH
R.O.W.: VARIES