



Keegan & Coppin
COMPANY, INC.

FOR LEASE

1500 COPPERHILL PARKWAY
SANTA ROSA, CA

HEAVY INDUSTRIAL WAREHOUSE
AND YARD



Go beyond broker.

PRESENTED BY:

DEMI BASILIADES, SREA
LIC #02080190 (707) 664-1400, EXT 305
DBASILIADES@KEEGANCOPPIN.COM



PROPERTY DETAILS



1500 COPPERHILL PARKWAY
SANTA ROSA, CA

HEAVY INDUSTRIAL WAREHOUSE AND YARD

PROPERTY INFORMATION

HIGHLIGHTS

- 1,200 - 17,500+/- SF Available
- Fenced Yard
- 600 Amps Power
- 14' Max Clear Height
- Multiple Structures Available
- Large Air Compressor Available
- Two 35' Storage Containers Available for Lease

DESCRIPTION OF AREA

Excellent location in Santa Rosa, the project affords both easy access and convenience to the Sonoma County Airport and Highway 101. This building is located in the Northwest Regional Industrial Park off of Airport Boulevard Area. Amenities include a full-service health club and championship golf course, Smart Train and other amenities, all within minutes of downtown Santa Rosa via U.S. Highway 101.

LEASE TERMS

Rate

Warehouse: \$1.00 PSF

Yard: \$.15 PSF

Terms

Full Service Gross

No CAM, Increases Over Base Year Expenses

3 - 5 Year Lease Term Preferred

Zoning

M2 - Heavy Industrial

Keegan & Coppin Co., Inc.
1201 N McDowell Blvd.
Petaluma, CA 94954
www.keegancoppin.com
(707) 664-1400

The above information, while not guaranteed, has been secured from sources we believe to be reliable. Submitted subject to error, change or withdrawal. An interested party should verify the status of the property and the information herein.

REPRESENTED BY:

DEMI BASILIADES, SREA
LIC # 02080190 (707) 664-1400, EXT 305
DBASILIADES@KEEGANCOPPIN.COM



SITE PLAN



1500 COPPERHILL PARKWAY
SANTA ROSA, CA

**HEAVY INDUSTRIAL
WAREHOUSE AND YARD**

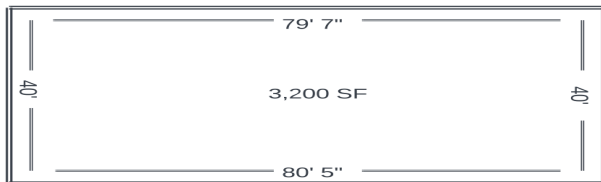
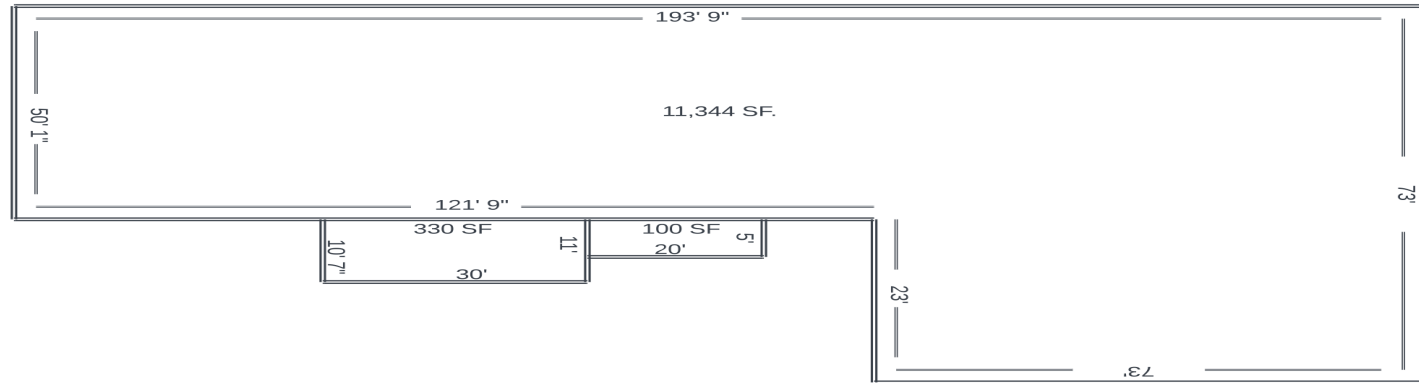

Above Unit Available: June
2024

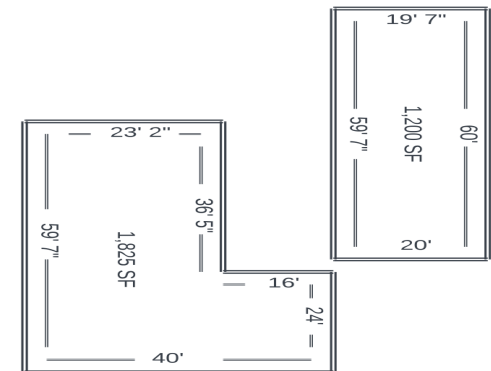
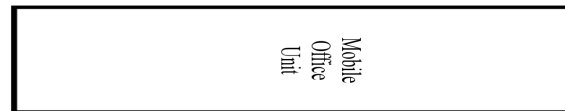

PRESENTED BY:

DEMI BASILIADES, SREA
KEEGAN & COPPIN CO., INC.
LIC #02080190 (707) 664-1400, EXT 305
DBASILIADES@KEEGANCOPPIN.COM



PROPERTY PHOTOS



1500 COPPERHILL PARKWAY
SANTA ROSA, CA

**HEAVY INDUSTRIAL
WAREHOUSE AND YARD**



PRESENTED BY:

**DEMI BASILIADES, SREA
KEEGAN & COPPIN CO., INC.
LIC #02080190 (707) 664-1400, EXT 305
DBASILIADES@KEEGANCOPPIN.COM**



LOCATION MAP



1500 COPPERHILL PARKWAY
SANTA ROSA, CA

**HEAVY INDUSTRIAL
WAREHOUSE AND YARD**

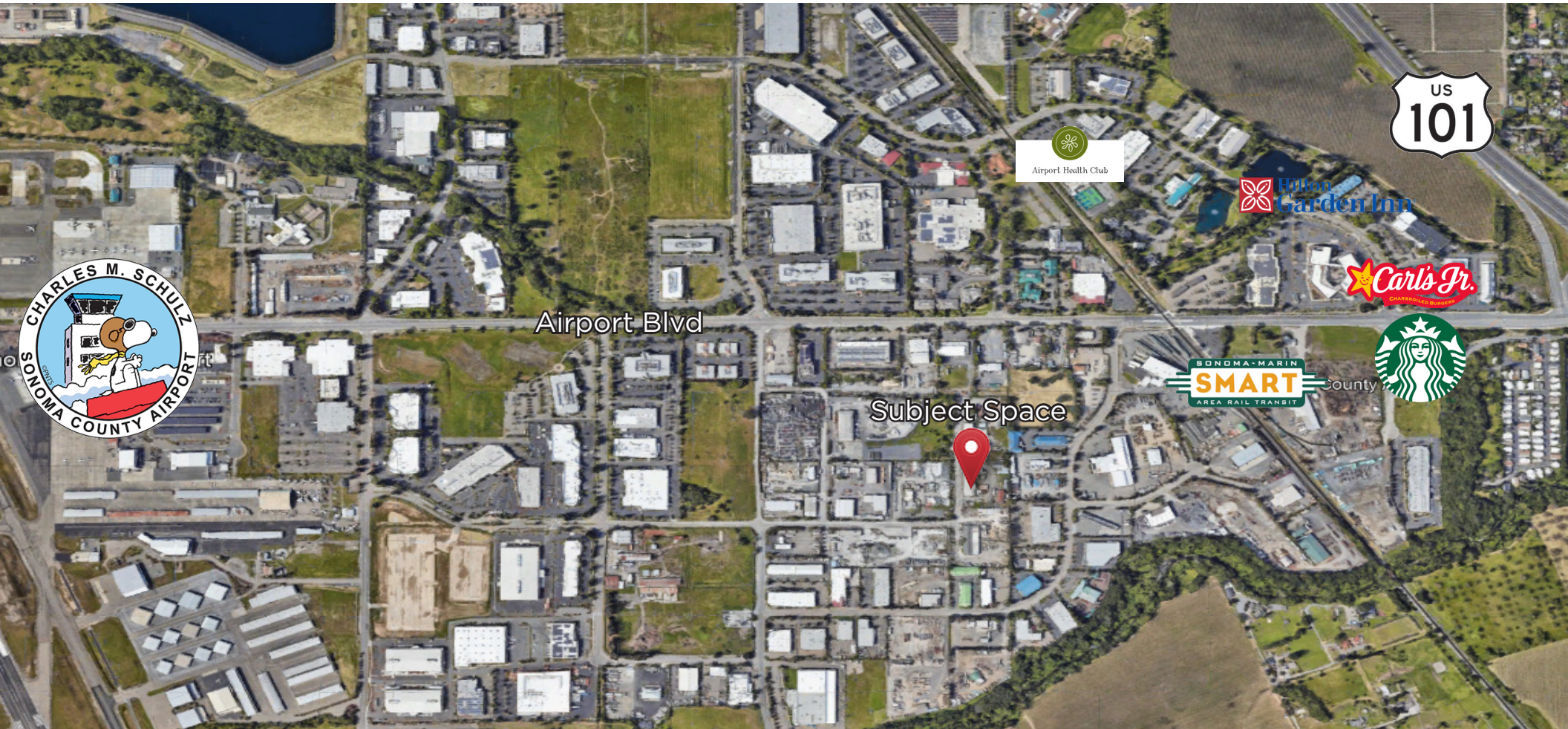

Keegan & Coppin Co., Inc.
1201 N McDowell Blvd.
Petaluma, CA 94954
www.keegancoppin.com
(707) 664-1400

The above information, while not guaranteed, has been secured from sources we believe to be reliable. Submitted subject to error, change or withdrawal. An interested party should verify the status of the property and the information herein.

REPRESENTED BY:

DEMI BASILIADES, SREA
LIC # 02080190 (707) 664-1400, EXT 305
DBASILIADES@KEEGANCOPPIN.COM