

FOR LEASE
2,037 ± SF
RETAIL Mobile, AL



4660 Airport Blvd.

Mobile, AL 36608

Property Features

- Available: 2,037 ± sf
- Frontage: 77 ± ft
- Parking: 11+
- Zoned: B-2
- American Title Loan occupies space closest to Airport Blvd.
- Proximate to Publix and Chic-Fil-A
- Floor plan attached

Call for Lease Rates

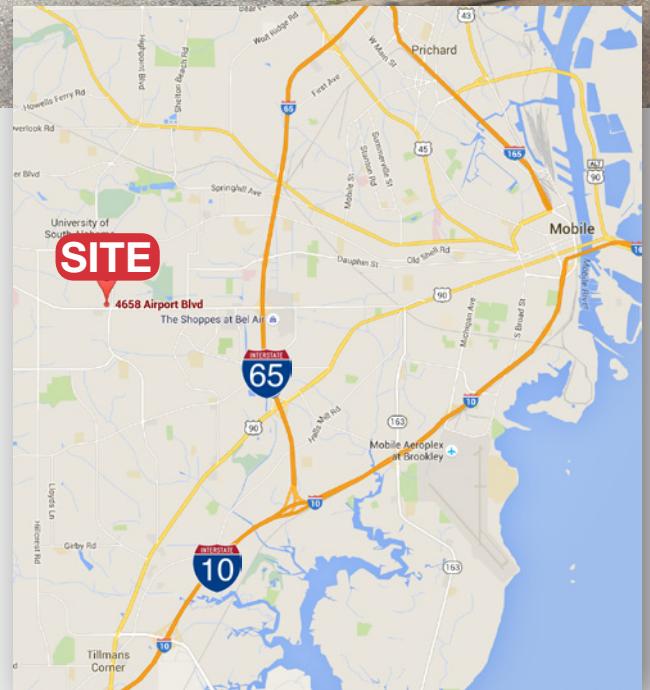

For more information:

Jay Roberds

251.753.1015 cell
jay@nai-mobile.com

NO WARRANTY OR REPRESENTATION, EXPRESS OR IMPLIED, IS MADE AS TO THE ACCURACY OF THE INFORMATION CONTAINED HEREIN, AND THE SAME IS SUBMITTED SUBJECT TO ERRORS, OMISSIONS, CHANGE OF PRICE, RENTAL OR OTHER CONDITIONS, PRIOR SALE, LEASE OR FINANCING, OR WITHDRAWAL WITHOUT NOTICE, AND OF ANY SPECIAL LISTING CONDITIONS IMPOSED BY OUR PRINCIPALS NO WARRANTIES OR REPRESENTATIONS ARE MADE AS TO THE CONDITION OF THE PROPERTY OR ANY HAZARDS CONTAINED THEREIN ARE ANY TO BE IMPLIED.

56 St. Emanuel St.
Mobile, AL
251.438.4312

www.nai-mobile.com

**FOR LEASE
2,037 ± SF**



Location Description

Located on major retail corridor of the west Mobile area. Proximate to restaurants, grocery stores, shopping centers, banks and residential neighborhoods. Approximately 8 minute drive to I-65.

Publix	0.1 miles
Chic-Fil-A	0.2 miles
I-65	2.9 miles
Mobile Regional Airport	4.4 miles
I-10	6.0 miles
Downtown Mobile	7.1 miles

Demographics

2016	1 Mi.	3 Mi.	5 Mi.
POPULATION	8,967	73,747	149,541
# OF HOUSEHOLDS	4,057	31,899	61,596
AVG. HH INCOME	\$81,765	\$67,370	\$65,240

For more information:

Jay Roberds

251.753.1015 cell
jay@nai-mobile.com

FLOOR PLAN: 4660 Airport Blvd.

FOR LEASE
2,037 ± SF



WALL LEGEND

	EXISTING BRICK WALLS
	EXISTING OAK WALLS
	EXISTING WOOD SLAT WALLS
	NEW WALLS

FLOOR PLAN
Scale: 1/4" = 1'-0"

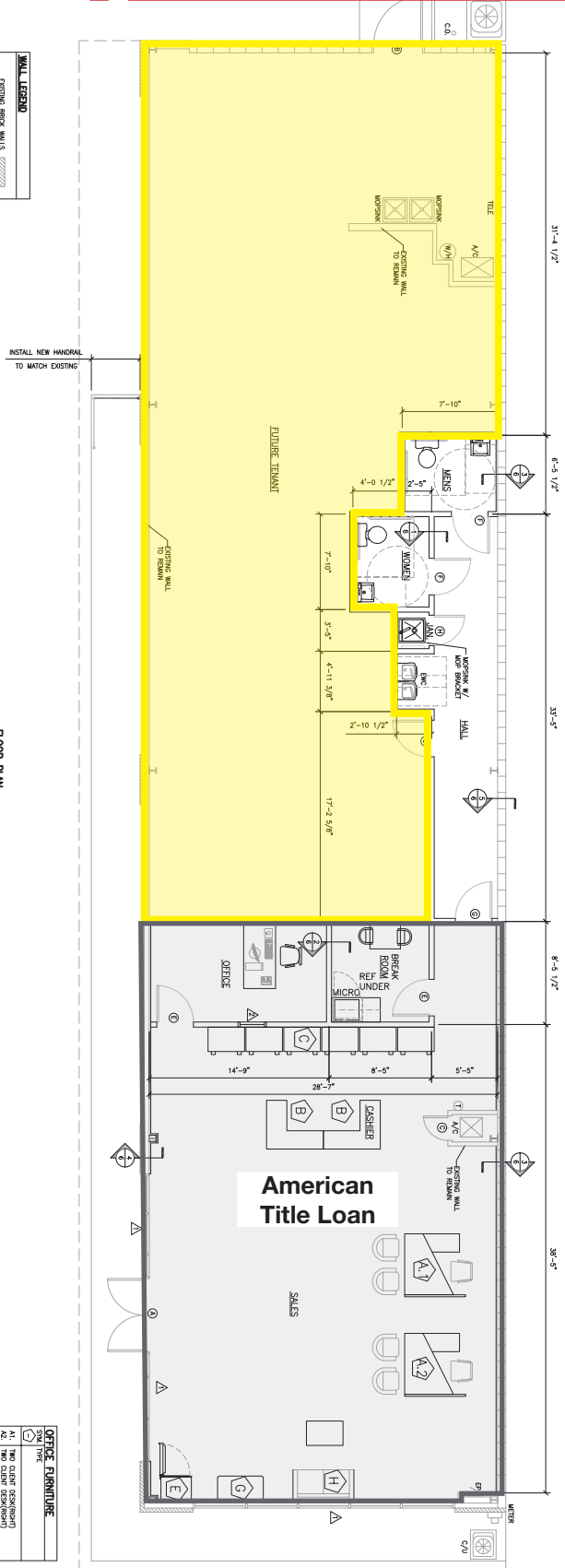

OFFICE FURNITURE

SYMBOL	TYPE
	TABLE
	TABLE
	STATION
	STATION
	STATION
	STATION
	STATION
	STATION
	STATION