

Southport One Building, Suite 204
12110 Port Grace Blvd.
Omaha, NE 68128

OFFICE SPACE FOR LEASE

Presented by



Brad Underwood
402.333.3333 x 102
cell: 402.598.6311
brad.underwood@rebc.com



listing.loopnet.com/4173066

Available: 2,068 sq. ft.

Price: \$16.00 / sq. ft. NNN **Lease Term:** 5 years

Description: Like new 2nd floor space with Class A finishes, including a shared executive board / conference room and shared kitchen / break space.

Class A building filled with light from windows and atrium. Easy interstate access and beautiful lake setting in growing Southport area.

- Features:**
- New Building In Upscale Office Park
 - Visible From I-80
 - Second Floor High Exposure
 - Building Is On Lake With Walking Trail
 - Southport Development Includes Paypal, Hotels, Cabelas, & Food

REBC | The Real Estate Brokerage Company
11717 Burt Street, Suite 102 | Omaha, Nebraska 68154

Commercial Real Estate Development | Sales, Leasing, & Brokerage
Property Management | Business Sales | Real Estate Investments



402 333 3333 REBC.com

All information deemed reliable, but not guaranteed. All properties are subject to prior sale, change, or withdrawal. Neither listing broker(s) or information provider(s) shall be held responsible for typographical errors, misstatements, and/or misprints, and shall be held totally harmless.

FLOOR PLAN

Southport One Building, Suite 204

12110 Port Grace Blvd.

2,068 sq. ft.

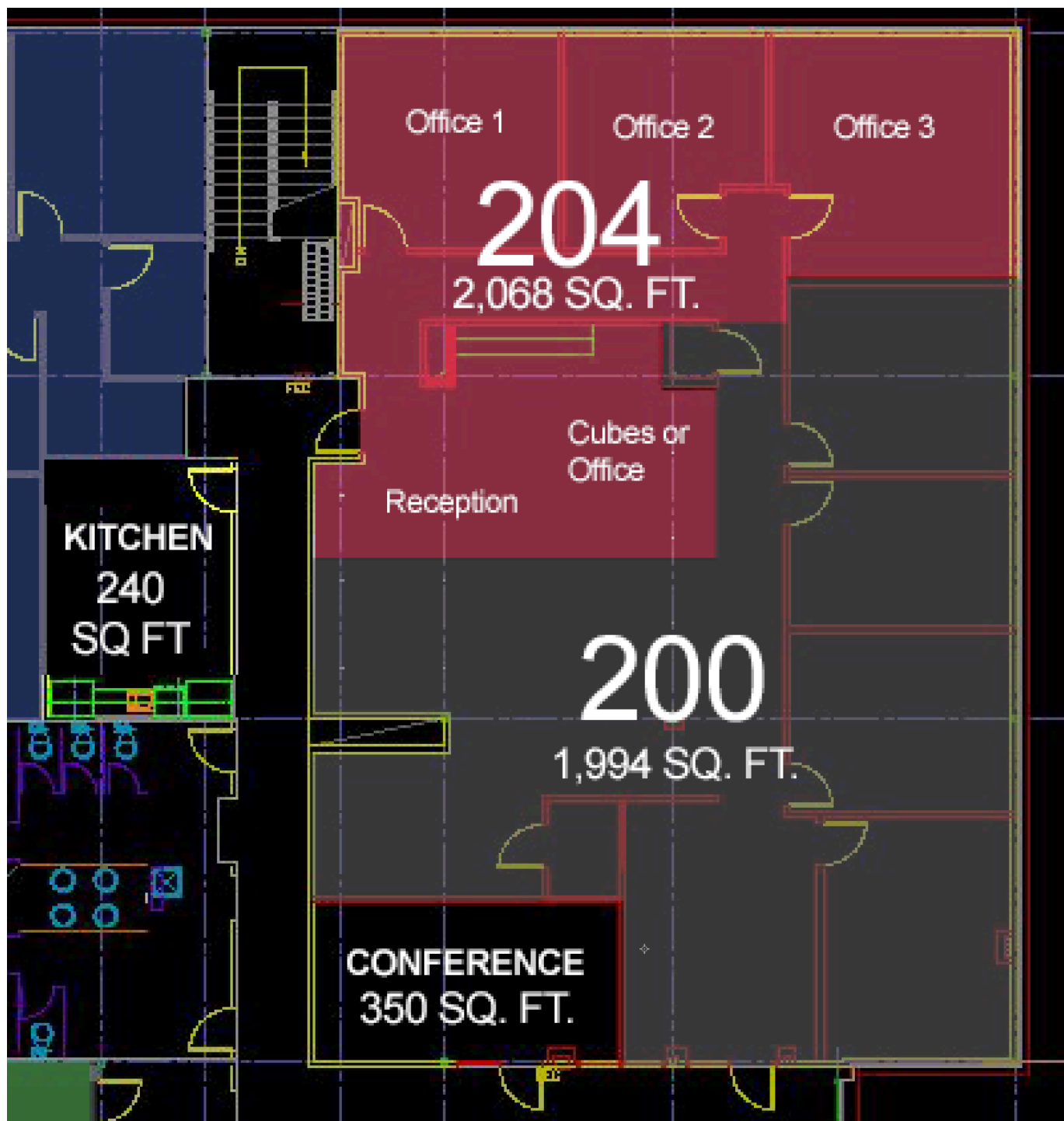

REBC | The Real Estate Brokerage Company
11717 Burt Street, Suite 102 | Omaha, Nebraska 68154

Commercial Real Estate Development | Sales, Leasing, & Brokerage
Property Management | Business Sales | Real Estate Investments

REBC | 
The Real Estate Brokerage Company

402 333 3333

REBC.com

All information deemed reliable, but not guaranteed. All properties are subject to prior sale, change, or withdrawal. Neither listing broker(s) or information provider(s) shall be held responsible for typographical errors, misinformation, and/or misprints, and shall be held totally harmless.