

FOR LEASE

±17,607 SF INDUSTRIAL UNIT

REDUCED LEASE RATE

LEASE RATE: \$1.20/SF GROSS



2229 YATES AVE | COMMERCE | CA

MILES SOLOMON

Senior Vice President & Land Specialist | LIC NO 02099423

e msolomon@lee-associates.com

c 949.532.8609

MASON LAWRENCE

LIC NO 02213856

e mlawrence@lee-associates.com

c 949.338.9567



±17,607 SF INDUSTRIAL UNIT

FOR LEASE



Central Commerce Location



Easy Loading Interior Dock



New Bathroom, Break Room, and LED Lights Throughout

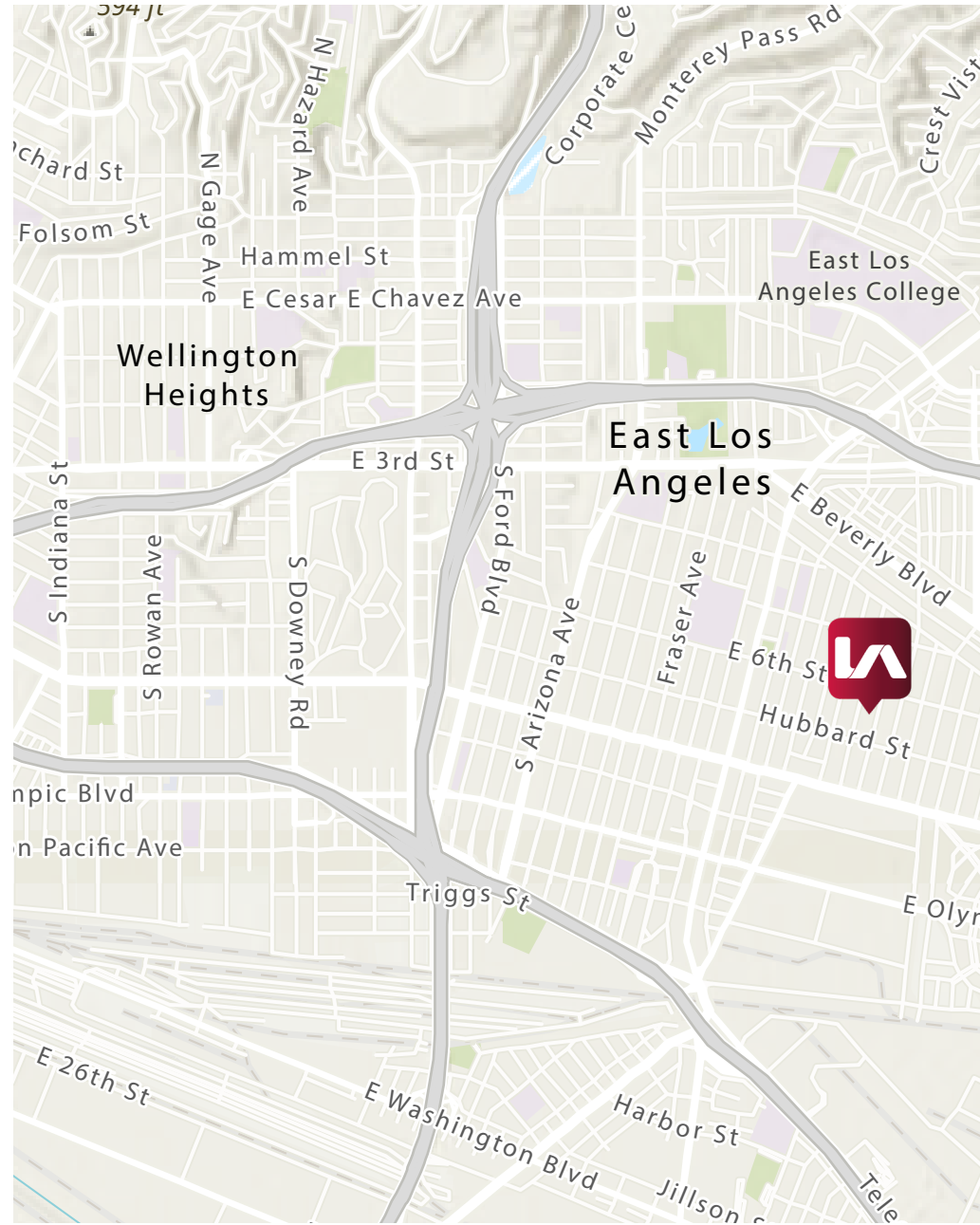

±17,607 SF INDUSTRIAL UNIT

FOR LEASE

AERIAL



±17,607 SF INDUSTRIAL UNIT

FOR LEASE



±17,607 SF INDUSTRIAL UNIT

FOR LEASE

SITE PLAN

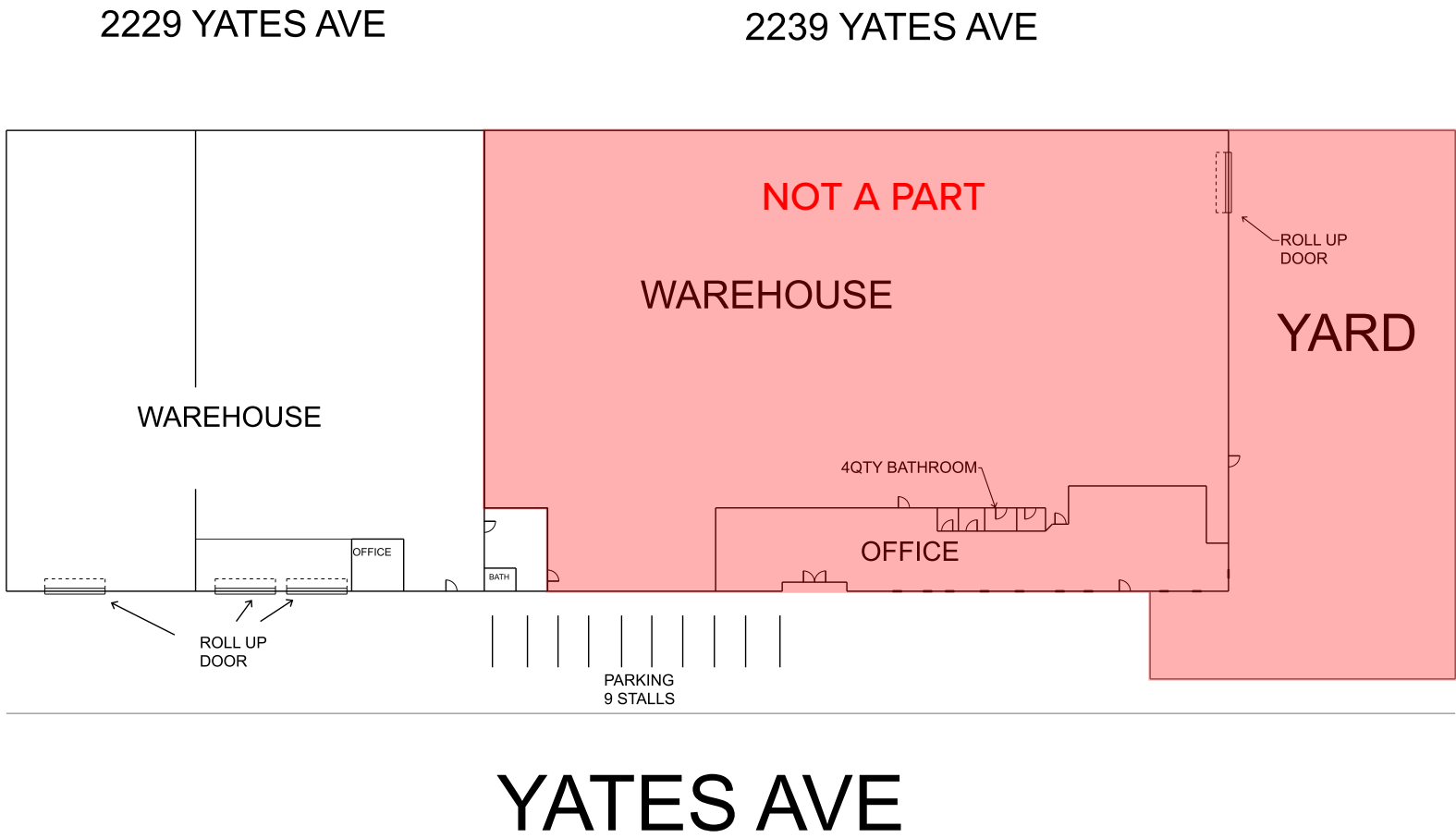

FOR LEASE

±17,607 SF INDUSTRIAL UNIT

2229 YATES AVE | COMMERCE, CA 90040

Miles Solomon

Senior Vice President & Land Specialist
msolomon@lee-associates.com
949-532-8609
LIC NO 02099423

Mason Lawrence

mlawrence@lee-associates.com
949-338-9567
LIC NO 02213856

Lee & Associates® Los Angeles, Inc. Corp. ID 02174865 1201 North Main Street | Los Angeles, CA 90012 323-922-3832

LEE-ASSOCIATES.COM/DOWNTOWNLA | TEAM-CLINE.COM

Tenant should verify all aspects of this brochure and material facts concerning the property including, but not limited to: square footage and composition of offices, building & land; whether the square footage includes interior dock or mezzanine areas; loading dock and door construction, size and condition; age and construction of building and all improvements; physical and structural condition of the building and all systems, including the HVAC, any elevators and roof; adequacy of floor loads for Tenant's intended use; ceiling and door clearance; ADA compliance; power; sprinkler calculations; zoning; permits, unpermitted improvements and permitted uses; taxes; whether the location of the property is within an incentive zone; and any other consideration that the Tenant deems to be material to its decision whether to purchase or lease the property. It is strongly recommended that Tenant utilize the services of professionals such as attorneys, accountants, architects, environmental consultants, surveyors, structural engineers and contractors to complete their due diligence prior to waiving any contingencies. It is also recommended that Buyer/Tenant obtain any use permits or business licenses that may be material to the operation of their business.