



AVAILABLE TO LET

79-91 NEW KING'S ROAD

5,000 SQ FT SHOWROOM / OFFICE TO LET - B1, D1, D2,
USES SUBJECT TO PLANNING

THE
Lorenz
CONSULTANCY  LTD

Andrew Knights
ak@lorenzconsultancy.com

Bailey Crouch
bc@lorenzconsultancy.com

79-91 NEW KING'S ROAD

5,000 SQ FT SHOWROOM / OFFICE TO LET - B1, D1, D2, USES SUBJECT TO PLANNING

To request a viewing call us on 020 7629 9898



RARE OPPORTUNITY TO ACQUIRE STUNNING 5,000 SQ FT GROUND FLOOR SUITABLE FOR A VARIETY OF USES (STP)

Highlights

- 5,000 SQ FT NIA
- SUITABLE FOR A VARIETY OF USES (STP)
- LARGE PROMINENT FRONTAGE
- DEMISED EXTERNAL PARKING AND LOADING FORECOURT
- FREEHOLD WITH VACANT POSSESSION ALSO FOR SALE

Property details

Rent	£225,000 per annum
Est. rates payable	£73,359 per annum
Size	5,000 Sq ft
Term	New lease direct from the Freeholder for a term by arrangement

Floor	Size sq ft	Rent pa	Service charge pa	Rates pa	Total pa	Planning usage (STP)
Ground	5,000	£225,000.00	£TBC	£73,359.00	£298,359.00	B1, D1, D2

* All sizes NIA



More information

[Visit microsite](#)

<https://realla.co/m/39599-79-91-new-kings-road-to-let-79-91-new-kings-road>

Contact us

The Lorenz Consultancy
24 Hanover square, London W1S 1JD
www.lorenzconsultancy.com
020 7629 9898
info@lorenzconsultancy.com
[linkedin.com/company/the-lorenz-consultancy](https://www.linkedin.com/company/the-lorenz-consultancy)
twitter.com/lorenzproperty
facebook.com/lorenzconsultancy

Andrew Knights
The Lorenz Consultancy
020 7647 4043
ak@lorenzconsultancy.com

Bailey Crouch
The Lorenz Consultancy
020 7647 4049
bc@lorenzconsultancy.com



04/03/2019 The particulars contained in this brochure are believed to be correct but cannot be guaranteed. All liability and negligence or otherwise for any loss arising from the use of these particulars is hereby excluded. This property is offered subject to contract.

ACCOMMODATION

Not To Scale - For Indicative Purposes Only

Floor Area	464 sq m	5,000 sq ft
Frontage	37m	120 ft
Floor to Ceiling	5.5m	18 ft
Entrance	3m x 4m	9 ft x 12 ft

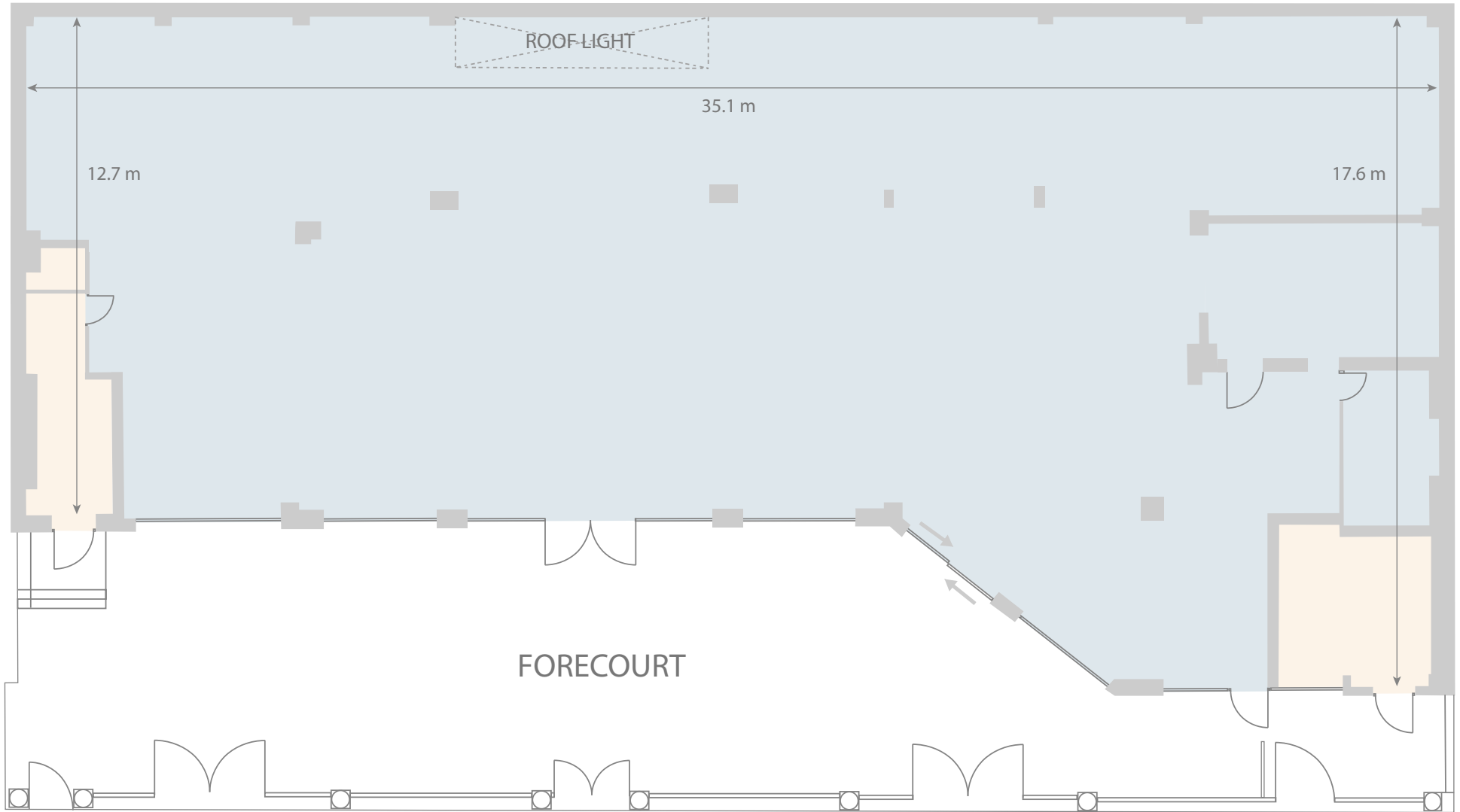

GROUND FLOOR