

FOR LEASE

AMLI 5350

A5350 BURNET ROAD, AUSTIN, TEXAS 78756



Retail Science from CBRE

www.cbre.com/ucr

CBRE

FOR LEASE

AMLI 5350

5350 BURNET ROAD | AUSTIN, TEXAS 78756



PROPERTY INFO

- + Located near Austin's most sought after neighborhood, in the high-growth urban core of Central Austin.
- + Mixed- use development consisting of 175 apartment units above 9,000 sf of ground floor retail offering convenient parking garage access.
- + Close to major employers including The University of Texas, Seton Hospital, and the Texas Department of State Health Services.
- + Area retailers include, HEB, CVS Pharmacy, Fonda San Miguel, Monkey's Nest Coffee, Hat Creek Burger Company Amy's Ice Cream, Pinthouse Pizza, Torchy's Tacos, Little Woodrow's, Thundercloud Subs, Brooklyn Pie Co, Phil's Ice House, Blue Star Cafeteria, Barley Swine, Lick Ice Cream, and Bufalina.

AVAILABLE SPACE

- + 2,093 SF- ideal for service users or retail

RATES | NNN

- + Please call for rates | \$9.32/ SF NNN



Retail Science from CBRE

www.cbre.com/ucr

CBRE

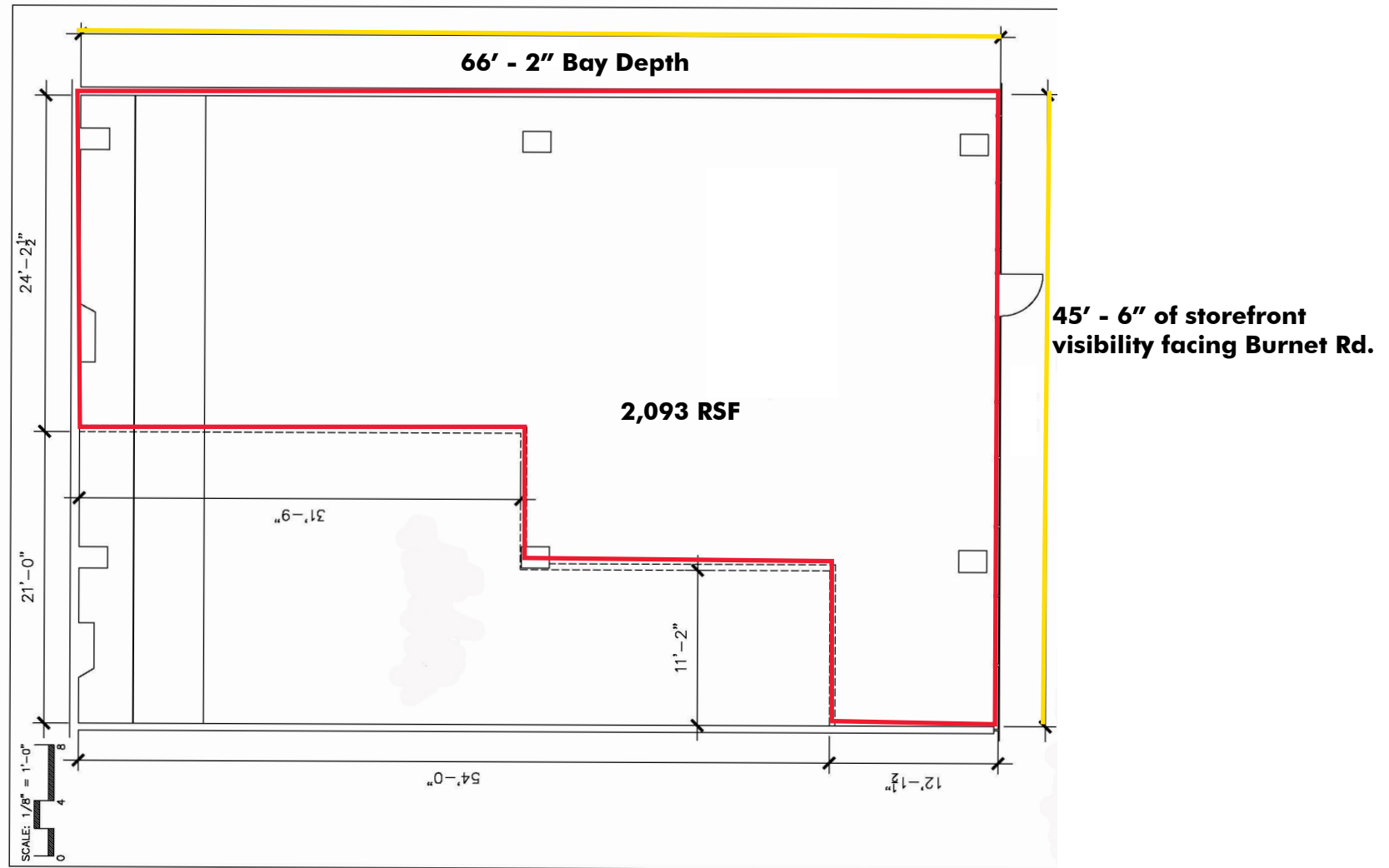



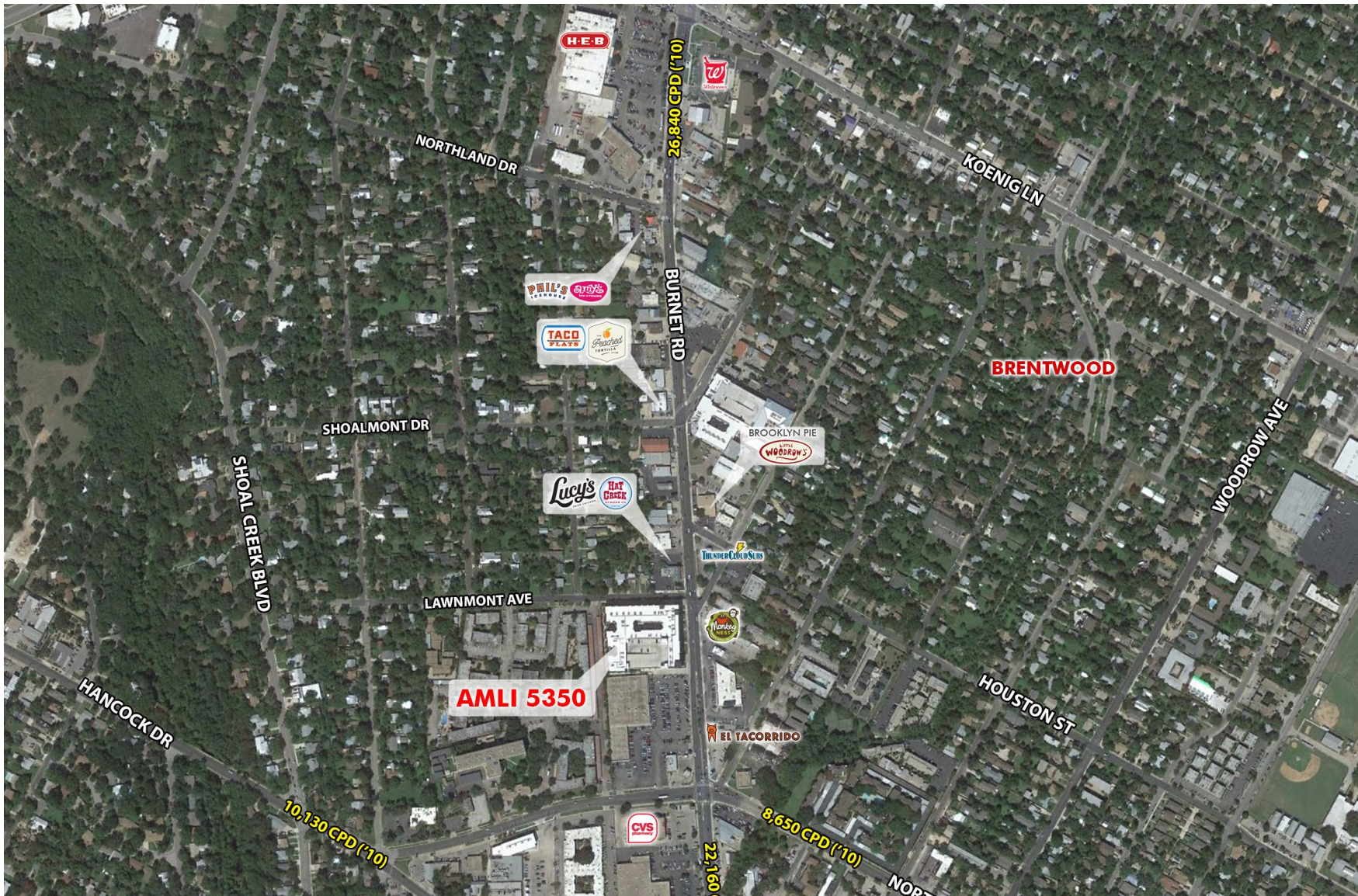



PROPERTY INFO

Demographic Summary

	1 Mile	3 Miles	5 Miles
2016 Population	14,166	145,479	318,365
2016 Daytime Population	18,182	187,153	461,564
2016 Avg HH Income	\$89,344	\$78,867	\$84,247

Traffic Counts

Burnet Road	23,375 vpd
2222	31,722 vpd



CONTACT US

Sergio Negrete

512 499 4959
sergio.negrete@cbre.com

Retail Science from CBRE

© 2016 CBRE, Inc. This information has been obtained from sources believed reliable. We have not verified it and make no guarantee, warranty or representation about it. Any projections, opinions, assumptions or estimates used are for example only and do not represent the current or future performance of the property. You and your advisors should conduct a careful, independent investigation of the property to determine to your satisfaction the suitability of the property for your needs. Photos herein are the property of their respective owners and use of these images without the express written consent of the owner is prohibited. CBRE and the CBRE logo are service marks of CBRE, Inc. and/or its affiliated or related companies in the United States and other countries. All other marks displayed on this document are the property of their respective owners.

www.cbre.com/ucr

CBRE