

Photo courtesy of Poole Tourism. Photo taken by Sue Sieger.

Approximately  
60% let or  
under offer



QUAY  
SIDE

Waterfront Retail and Restaurant Units To Let  
Poole Quay, Dorset



Quayside, with its 70,000 sq ft of retail and restaurant space and five floors of luxury apartments overlooking the new Poole Quay Boat Haven, is a major addition to the amenities of Poole – the St Tropez of the south coast. The bustling Quay is Poole’s major visitor attraction and a centre of local activity.

Poole is one of Dorset’s major destinations and is easily accessible from London. The Quayside development is just one of the changes that is making this a fashionable and desirable location.

Quayside adjoins Poole Pottery where a substantial refurbishment of the existing building is intended (subject to planning). Further details are available upon request.



Poole Tourism





Poole Tourism

## POOLE

- ◆ One of Britain's sunniest micro climates
- ◆ The largest harbour in the Northern hemisphere
- ◆ Dorset's largest town
- ◆ Major yachting destination
- ◆ Home to Sunseeker and Fairline Boats
- ◆ Over 55% ABC1s within 15 miles
- ◆ Over 50 special summer events

## THE QUAY

- ◆ High calibre restaurants and shops
- ◆ Centre for regular promotional events:  
Dream Machines – Britain's biggest weekly bike fest, fireworks and street markets
- ◆ 170 berth boat haven
- ◆ High Footfall - More than 2 million
- ◆ 550 space car park adjacent
- ◆ Multiple retailers of Pavers and Leading Labels



Photo courtesy of Poole Tourism. Photo taken by Sue Sieger.





## GROUND LEVEL

The retail units are arranged on two levels. The ground comprises streetfacing frontages and a mall connecting the quay with East Quay Road.

## LEVEL ONE

Level One can be accessed directly by lifts or from the grand stairs that lead up from the quay or from the mall.

The accommodation comprises only 11 remaining A1, A2 and A3 units totalling approximately 28,000 sq ft of space on two levels.

- ◆ 11 units from 71 sq m to 717 sq m
- ◆ Planning consent for A1, A2 and A3
- ◆ Immediately available
- ◆ Flexible leasing terms are available



| Level  | Unit | Sq m | Sq ft | Tenant              |
|--------|------|------|-------|---------------------|
| Ground | D1   | 220  | 2370  | Paver Shoes         |
| Ground | D2   | 162  | 1738  | Leading Labels      |
| Ground | D3   | 162  | 1745  | Leading Labels      |
| Ground | D4   | 157  | 1692  | Leading Labels      |
| Ground | D5   | 147  | 1579  | Leading Labels      |
| Ground | D6   | 110  | 1182  | Available           |
| Ground | D7   | 195  | 2098  | Available           |
| Ground | D8   | 203  | 2186  | Available           |
| Ground | D9   | 119  | 1280  | Available           |
| Ground | D10  | 96   | 1029  | Available           |
| Ground | D11  | 198  | 2136  | Available           |
| Ground | D12  | 227  | 2441  | Aveda               |
| Ground | D13  | 398  | 4284  | Available           |
| Ground | D14  | 162  | 2092  | Paver Shoes         |
| Ground | D15  | 194  | 2092  | Under Offer         |
| Ground | D16  | 180  | 1936  | Under Offer         |
| Ground | D17  | 121  | 1299  | Chapman's Deli      |
| Ground | D18  | 195  | 2097  | Bamboula            |
| Ground | D19  | 132  | 1426  | Available           |
| Ground | D20  | 71   | 767   | Available           |
| One    | D21  | 718  | 7728  | Available           |
| One    | D22  | 545  | 5867  | Wok n' Spice        |
| One    | D23  | 377  | 4208  | Bamboula Restaurant |
| One    | D24  | 391  | 1541  | Under Offer         |
| One    | D25  | 143  | 1541  | Gossip              |
| One    | D26  | 677  | 7291  | Driftwood           |
| One    | D27  | 288  | 3103  | Available           |

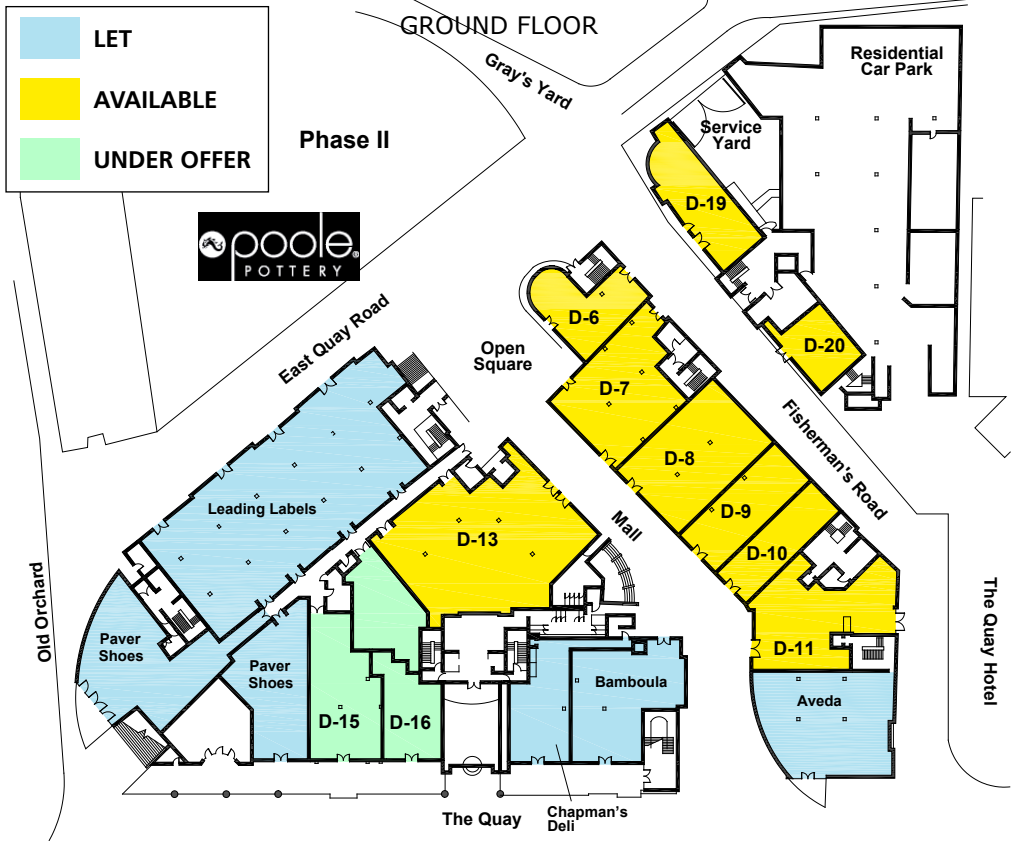

THE QUAY

POOLE QUAY BOAT HAVEN



THE QUAY

POOLE QUAY BOAT HAVEN

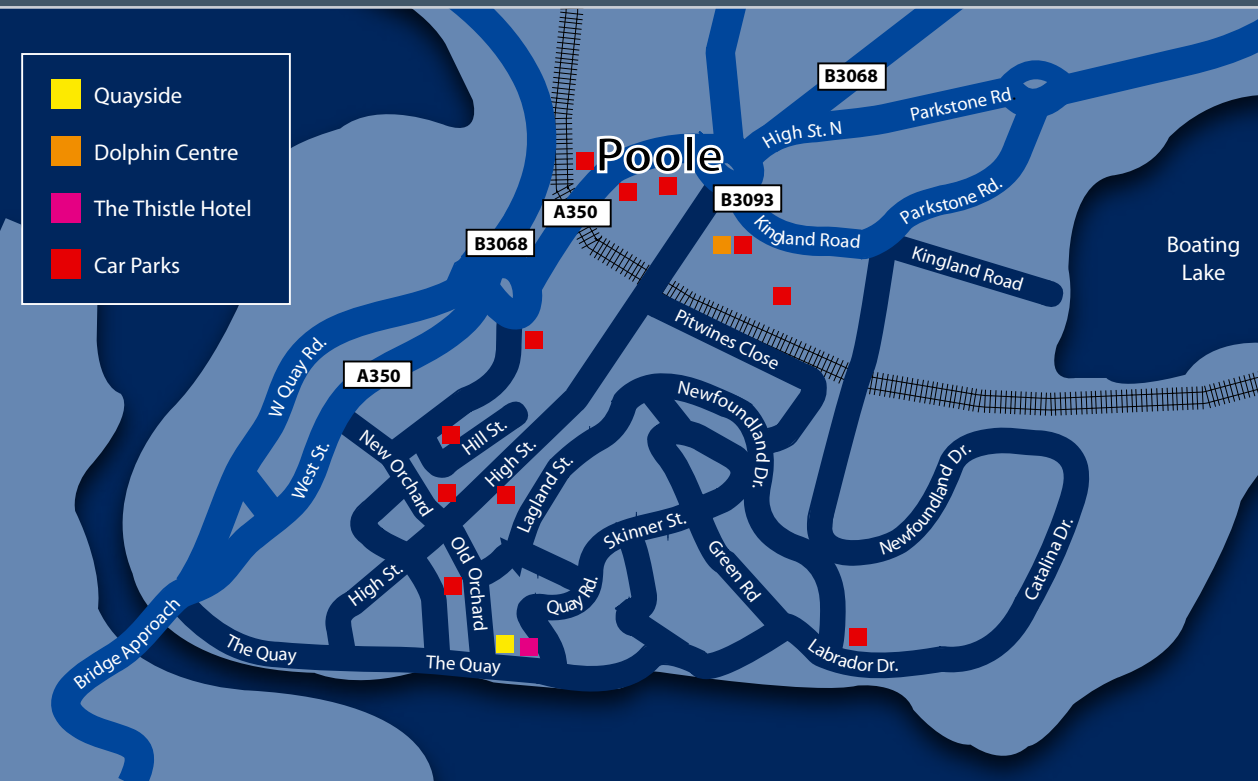

Kevin Marsh  
Colin Lambert  
Adam Bullas

Keith Nelson  
Elliott Hart

Brunswick House  
Brunswick Place  
Southampton SO15 2AP

[savills.com](http://savills.com) **savills**

**02380 713900**

**CHASE & PARTNERS** **C&P**

Retail & Leisure Property Specialists

**020 7389 9494**

[www.chaseandpartners.co.uk](http://www.chaseandpartners.co.uk)

20 Regent Street, London SW1Y 4PH

**MISREPRESENTATION ACT**

Savills and Chase & Partners, on their behalves and for the lessors of this property whose agents they are, give notice that:  
 (i) These particulars are set out as a general outline for the guidance of intending lessees and do not constitute, nor constitute part of, an offer or contract.  
 (ii) All descriptions, dimensions, references to condition and necessary permission for use and occupation, and other details are given in good faith and are believed to be correct but any intending tenants should not rely on them as statements or representations of fact but must satisfy themselves as to the correctness of them.