

423 W 55

NEWMARK

Sublease Opportunity



Building Highlights

Building Highlights

- 24/7 Tenant Controlled HVAC
- Lobby Security During Business Hours; 24/7 Key Card Access
- Proximity to major subway lines
- Credit-worthy Sublandlord
- Furnished, plug n' play
- Planet Fitness
- Great light and views

Sublease Space

Size	136,119 RSF
Floorplate Size	25,000 RSF
Floors	6th – 11th
Term	December 2027
Possession	Immediate

[View Matterport Virtual Tours](#)

[View Video Tour](#)

Building Stack



Building Lobby



Existing Interiors





6th Floor – 25,000 RSF

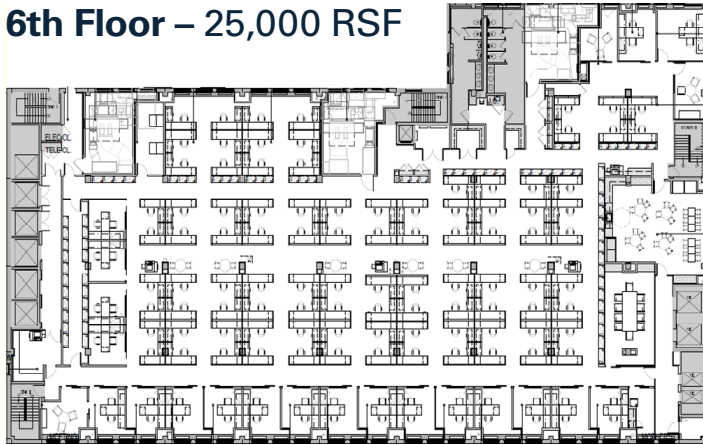

7th Floor – 25,000 RSF

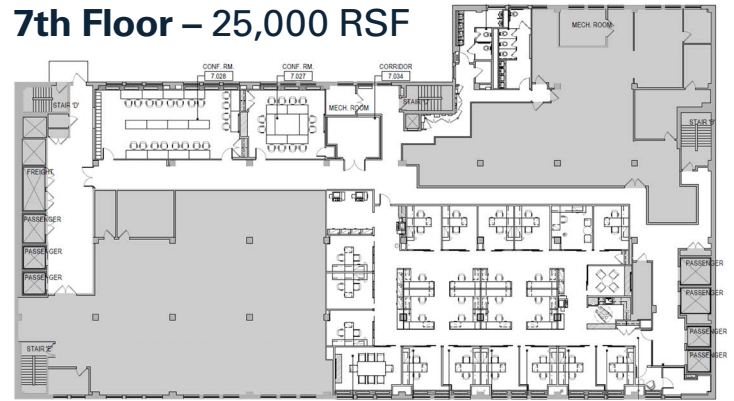

8th Floor – 25,000 RSF

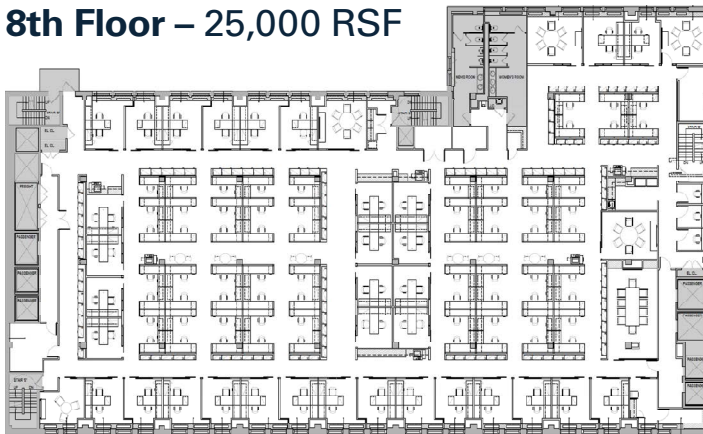

9th Floor – 25,000 RSF

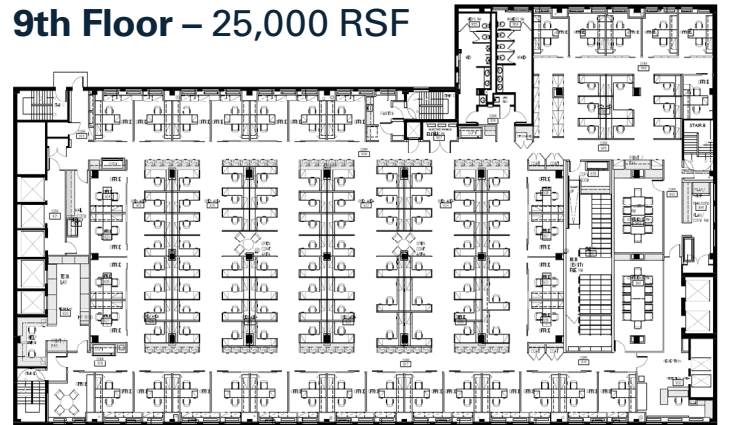

10th Floor – 25,000 RSF

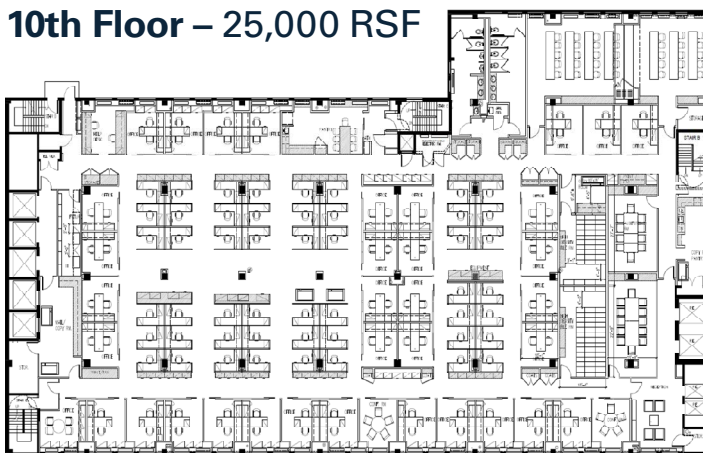

11th Floor – 25,000 RSF

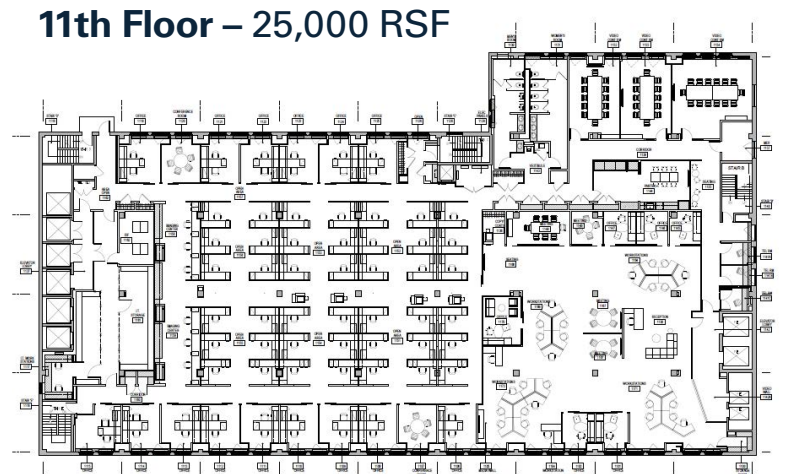

Contacts

Chris Mongeluzo

chris.mongeluzo@nrmk.com

212-372-2081

Aaron Winston

aaron.winston@nrmk.com

212-372-2381

Eric Zemachson

eric.zemachson@nrmk.com

212-372-2169

Emma Sukenik

emma.sukenik@nrmk.com

212-359-8528

423 W 55

NEWMARK