

86 Brook Street, London W1

High Quality Mayfair Office

2nd Floor - 2,291 sq ft (213m²)

Fitted Out



Description

- Fitted out
- Air conditioning
- Raised floor
- Metal tile suspended ceiling
- Demised WC's
- Passenger lift
- Smart reception with commissionaire
- Showers, changing facilities and bicycle racks

86 Brook Street, W1

Location

This prominent corner building is located at the junction of Brook Street and Binney Street, a few metres away from Grosvenor Square. Bond Street underground station is situated a short walk away, providing excellent access to The City and West London via the Central line and Canary Wharf, London Bridge and North West London via the Jubilee line.

Description

The available corner office is located on the 2nd floor (2,291 sq ft) and is accessed by way of an attractive manned reception and passenger lift.

There are showers, changing facilities and bicycle racks in the basement.

Lease

A new lease is available direct from the landlord.

Rent

To be confirmed.

Rates

£37.97 per sq ft.

Service Charge

£17.70 per sq ft.

Energy Performance

TBC

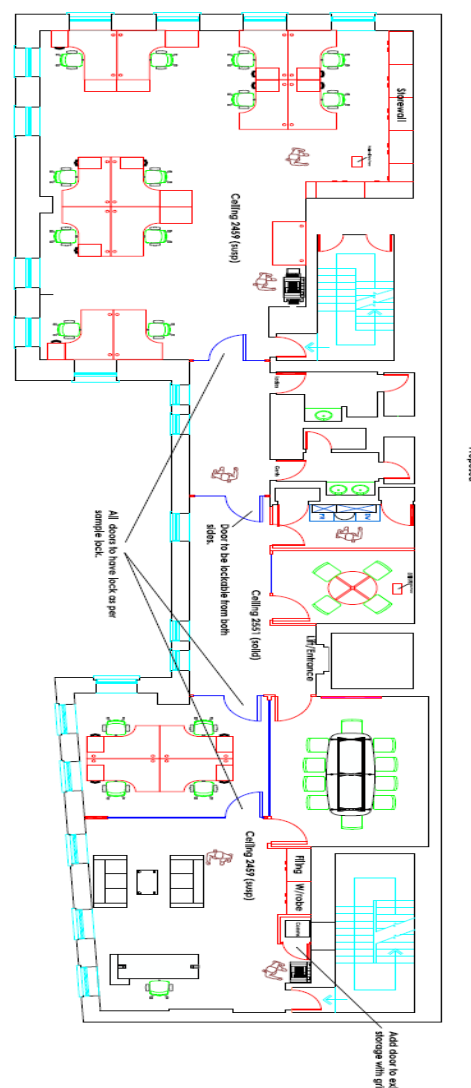

For further information or to arrange a viewing please contact the sole agents:

Crossland Otter Hunt

Bryan Pontifex
bryan@coh.eu

Phil Frenay
phil@coh.eu

10/19