

© 2016 THIS DRAWING IS THE PROPERTY AND INSTRUMENT OF SITELINE PA. NO MODIFICATIONS OR CHANGES MAY BE MADE TO THIS DRAWING WITHOUT THE EXPRESS WRITTEN PERMISSION OF SITELINE PA. ANY MODIFICATION, CHANGE OR USE OF THIS DRAWING WITHOUT THE EXPRESS WRITTEN PERMISSION OF SITELINE PA IS UNLAWFUL AND IS AT THE USER'S RISK.

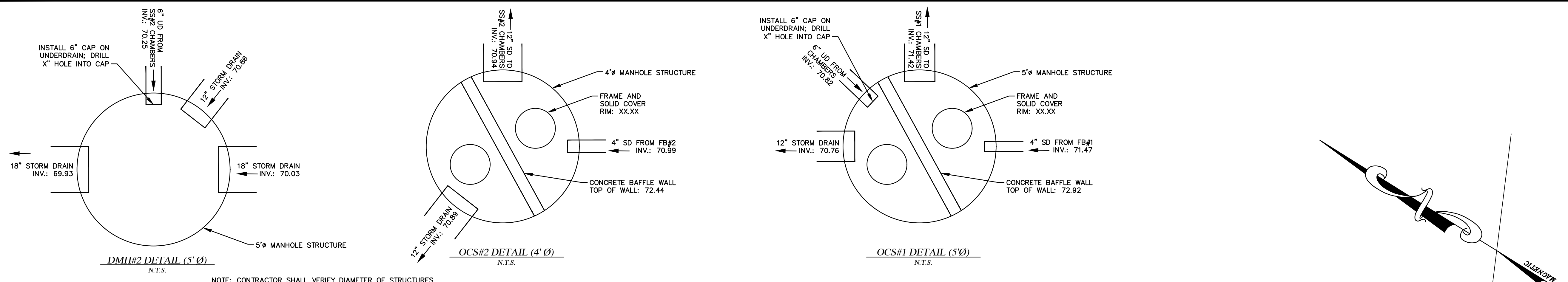

NOTE: CONTRACTOR SHALL VERIFY DIAMETER OF STRUCTURES WITH CONCRETE MANUFACTURER & PROVIDE SHOP DRAWINGS TO ENGINEER FOR APPROVAL PRIOR TO ORDERING.

- GRADING AND DRAINAGE NOTES:**
1. THE CONTRACTOR SHALL PHASE GRADING EFFORTS SUCH THAT TOTAL SITE DISTURBANCE IS MINIMIZED. TEMPORARY EROSION CONTROL MEASURES SHALL BE INSTALLED PRIOR TO GRADING EFFORTS OR WITHOUT DELAY UPON THEIR COMPLETION, DEPENDENT UPON THE SITUATION.
 2. ALL FILL SLOPES SHALL BE A MINIMUM OF 3:1 HORIZONTAL TO VERTICAL UNLESS OTHERWISE NOTED OR DIRECTED.
 3. THE LIMITS OF DISTURBANCE SHALL GENERALLY BE THE MINIMAL EXTENT NECESSARY ONLY TO PERFORM THE GRADING EFFORTS SHOWN ON THE DRAWINGS. SPECIAL CARE SHALL BE TAKEN TO AVOID DISTURBANCE OF OBJECTS AND AREAS NOT SPECIFICALLY IDENTIFIED FOR MODIFICATION OR REMOVAL.
 4. ALL DISTURBED AREAS SHALL BE LOAMED AND SEEDING IN ACCORDANCE WITH THE DRAWINGS, UNLESS INTENDED FOR OTHER SURFACE COVER.
 5. STORM DRAINS SHALL BE CONSTRUCTED CONCURRENTLY WITH GRADING EFFORTS TO PROVIDE ADEQUATE CONVEYANCE FOR ANY SITE RUNOFF CONDITIONS.
 6. WHERE FINAL GRADING HAS BEEN COMPLETED, SURFACE RESTORATION FOR DISTURBED AREAS WILL BE COMPLETED AS SOON AS PRACTICABLE. FOR VEGETATIVE AREAS, VEGETATION WILL BE PROGRESSIVELY ESTABLISHED.
 7. UNLESS OTHERWISE NOTED, ALL STORM DRAIN PIPE SHALL BE IN ACCORDANCE WITH MDT SPECIFICATIONS SECTION 603. PIPE CULVERTS AND STORM DRAINS, LATEST REVISION WITH ACCEPTABLE TYPES OF PIPE ARE AS FOLLOWS:
SMOOTH BORE POLYETHYLENE PIPE - HDPE N-12 ADS
 8. BENCHMARK INFORMATION: SEE PLAN
 9. THE CONTRACTOR SHALL SUBMIT SHOP DRAWINGS OF ALL DRAINAGE STRUCTURES AND PIPING PRIOR TO ORDERING.
 10. RIM ELEVATIONS OF PROPOSED DRAINAGE STRUCTURES ARE APPROXIMATE. FINAL ELEVATIONS ARE TO BE SET FLUSH AND CONSISTENT WITH THE GRADING PLANS.
 11. TRANSITIONS BETWEEN SLOPES ARE TO BE GENERALLY GRADUAL AND RESULT IN A SMOOTH, ROUNDED APPEARANCE.

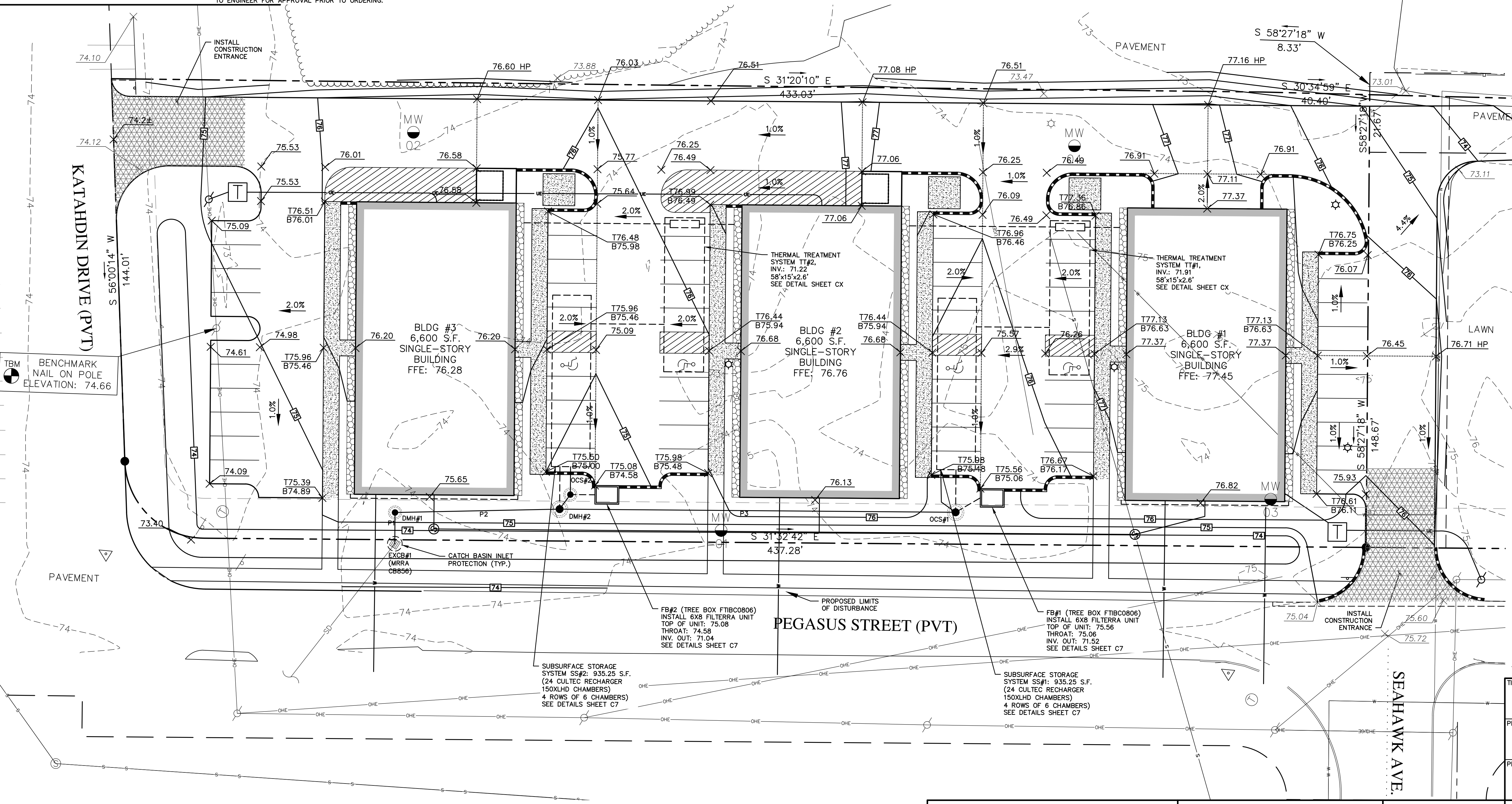

DRAINAGE STRUCTURE DATA:

EXCB#1 (MIRA CB856)
 RIM: 73.19
 NEW INV. IN: 69.50 (18" FROM DMH#1)
 EXISTING INV. OUT: 69.4± (12" ACROSS PEGASUS)

DMH#1 (4' Ø)
 RIM: XX.XX
 INV. IN: 69.64 (18" FROM DMH#2)
 INV. OUT: 69.54 (TO EXCB#1)

DMH#2 (5' Ø)
 RIM: XX.XX
 INV. IN: 70.03 (12" FROM OCS#1)
 INV. IN: 70.86 (12" FROM OCS#2)
 INV. IN: 70.25 (6" FROM SS#2 CHAMBERS)
 INV. OUT: 69.93 (TO DMH#1)

OCS#1 (5' Ø)
 RIM: XX.XX
 TOP OF BAFFLE: 72.92
 INV. IN: 71.47 (4" FROM FB#1)
 INV. OUT: 71.42 (12" TO SS#1 CHAMBERS)
 INV. IN: 70.82 (6" FROM SS#1 CHAMBERS)
 INV. OUT: 70.76 (TO DMH#2)

OCS#2 (4' Ø)
 RIM: XX.XX
 TOP OF BAFFLE: 72.44
 INV. IN: 70.99 (4" FROM FB#2)
 INV. OUT: 70.94 (12" TO SS#2 CHAMBERS)
 INV. OUT: 70.89 (TO DMH#2)

P1: 18" HDPE L=8' S=0.005
P2: 18" HDPE L=58' S=0.005
P3: 18" HDPE L=145' S=0.005
P4: 12" HDPE L=3' S=0.010

PROGRESS PRINT
 THIS PLAN IS ISSUED FOR REVIEW AND INFORMATION PURPOSES ONLY. THIS PLAN IS SUBJECT TO CHANGE AND IS NOT FOR PRICING OR CONSTRUCTION. PRICING BASED ON THIS PLAN IS NOT BINDING UNLESS SIGNED BY BOTH CONTRACTOR AND OWNER.

CALL DIG SAFE UTILITY LOCATION
1-888-344-7233
 STATE LAW REQUIRES ADVANCE NOTICE OF AT LEAST 3 BUSINESS DAYS BEFORE YOU DIG, GRADE OR EXCAVATE FOR THE MARKING OF UNDERGROUND UTILITIES

THIS SHEET SCALE IS DIFFERENT
GRAPHIC SCALE
 (IN FEET)
 1 inch = 20 ft.
 ISSUED FOR:
PRELIMINARY PRICING

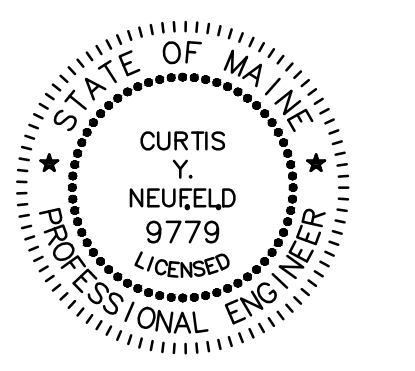

1. 06-29-18 SUBMITTED TO TOWN OF BRUNSWICK FOR SKETCH REVIEW MCA
GRADING PLAN
 PROJECT:
BRUNSWICK LANDING LOT 15
PEGASUS STREET, BRUNSWICK, MAINE
 PREPARED FOR:
14 WILLEY ROAD, LLC
P.O. BOX 295, CASCO, ME 04015

SITELINES, PA
ENGINEERS • PLANNERS • SURVEYORS
 8 CUMBERLAND STREET, BRUNSWICK, ME 04011
 207.725.1200 www.sitelinespa.com

FIELD WK: M/C/H	SCALE: 1"=20'	SHEET:
DRN BY: MCA	JOB #: 3324	C4
CHD BY: CYN	MAP/LOT: 40/32	
DATE: 08-22-17	FILE: 3324.FINAL	