



# FOR SUBLEASE

2988 E. Ana Street, Rancho Dominguez CA 90221

**85,042 SF Industrial Building**

**Lease Rate: TBD**



## FEATURES

Available Square Footage	85,042
Land Square Footage	283,096
Office Square Footage	5,544
Parking	58
Dimensions	Verify
Loading	8 Dock-high Loading Positions 9 Ground Level Doors
Minimum Ceiling Clearance	18'
Power	2400 Amps, 220 Volts, 3P, 4W
Sprinkler System	Yes
Year Built	1969
Construction	Tilt-up
Zoning	M1.5

## HIGHLIGHTS

- Unincorporated LA County
- Sublease through October 15, 2023
- Operating Expenses approx. \$28,095/month
- Possession November 1, 2020

## ACCESSIBILITY

### MILES TO

Los Angeles International Airport	18.0
Long Beach Airport	8.0
Los Angeles & Long Beach Ports (both)	8.5

### IMMEDIATE ACCESS TO

710 and 91 Freeways



### ED WHITTEMORE

LICENSE #00935219  
310.436.6482  
ewhittemore@lareminc.com



### JAY JASAITIS

LICENSE #00865169  
310.436.6487  
jjasaitis@lareminc.com



### MATT GINOCCHIO

LICENSE #01777208  
310.436.6483  
mginocchio@lareminc.com

**310.719.1585 // lareminc.com**  
**165 Savarona Way, Carson, California 90746**

**TRUSTED INDUSTRIAL REAL ESTATE SOLUTIONS SINCE 1993**

The information above has been obtained from sources believed reliable. While we do not doubt its accuracy, we have not verified it and make no guarantee, warranty or representation about it. It is your responsibility to independently confirm its accuracy and completeness. Any projections, options, assumptions or estimates used are for example only and do not represent the current or future performance of the property. The value of this transaction to you depends on tax and other factors which should be evaluated by your tax, financial and legal advisors. You and your advisors should conduct a careful, independent investigation of the property to determine to your satisfaction the suitability of the property for your needs.

# SITE PLAN

2988 E. Ana Street, Rancho Dominguez

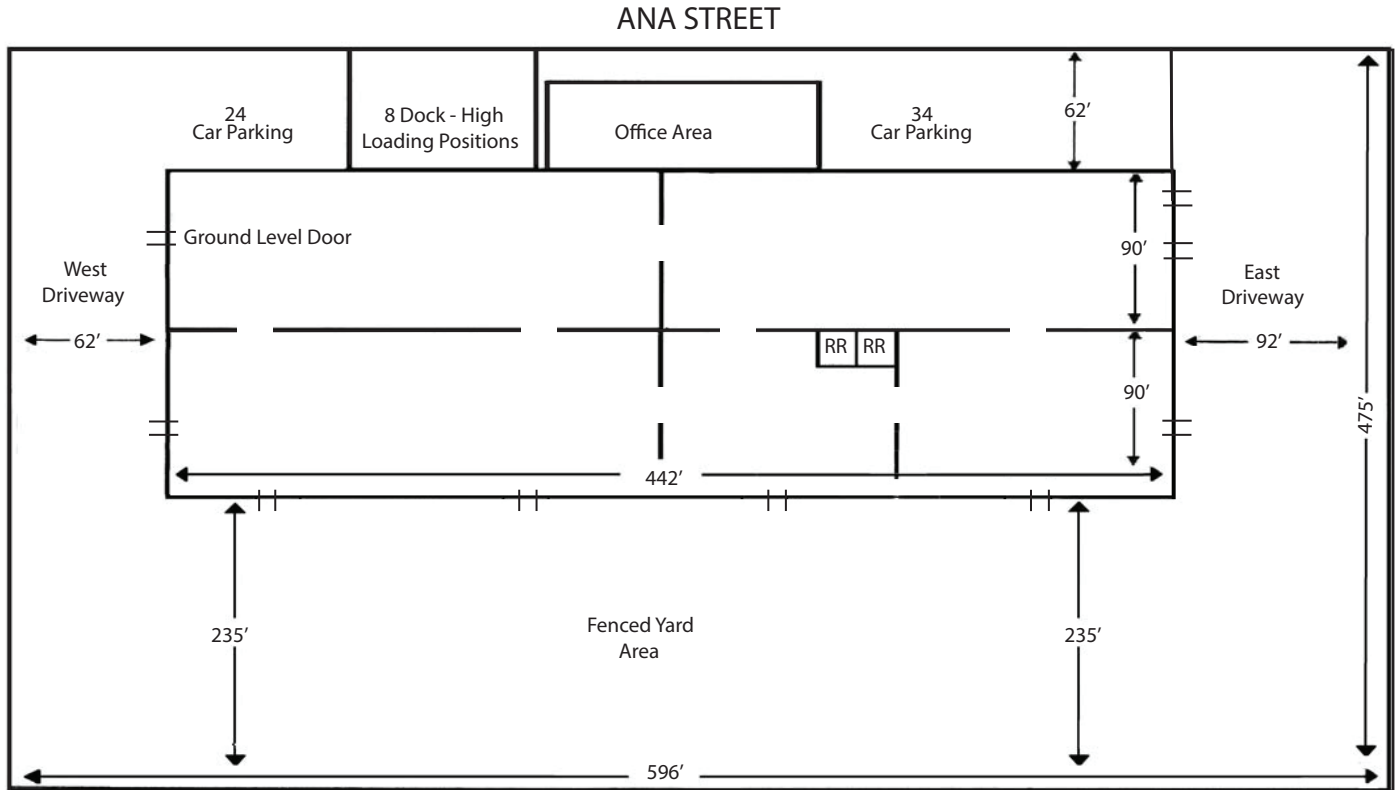

The information above has been obtained from sources believed reliable. While we do not doubt its accuracy, we have not verified it and make no guarantee, warranty or representation about it. It is your responsibility to independently confirm its accuracy and completeness. Any projections, options, assumptions or estimates used are for example only and do not represent the current or future performance of the property. The value of this transaction to you depends on tax and other factors which should be evaluated by your tax, financial and legal advisors. You and your advisors should conduct a careful, independent investigation of the property to determine to your satisfaction the suitability of the property for your needs.

310.719.1585 // [lareminc.com](http://lareminc.com)  
165 Savarona Way, Carson, California 90746

TRUSTED INDUSTRIAL REAL ESTATE SOLUTIONS SINCE 1993