

1000 E

600 S

- PARKING CALCULATIONS:**
- GROSS BLDG. AREA:** 19,823 S.F.
 - 1 PARKING STALL PER 250 S.F. REQUIRED**
 - PARKING REQUIRED:** 80 STALLS
 - PARKING PROVIDED:** 88 STALLS
 - ADA PARKING REQUIRED:** 5 STALLS
 - ADA PARKING PROVIDED:** 10 STALLS

1 ARCHITECTURAL SITE PLAN
A100 N.T.S.

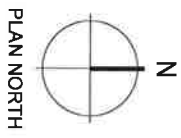

SHELL BUILDING FOR:
ST. GEORGE DIALYSIS PD CLINIC
 CCN Real Estate Ventures
 624 S and 1000 E ST., St. George, UT

croaction
 GROUP
 architectural
 2271 W. Frye Rd #210
 Orem, UT 84057
 P 405-362-2210
 F 405-361-1180

Revision Project Number
 13491
 Site Plan

A100

KIDNEY AND HYPERTENSION CENTER ST. GEORGE UTAH

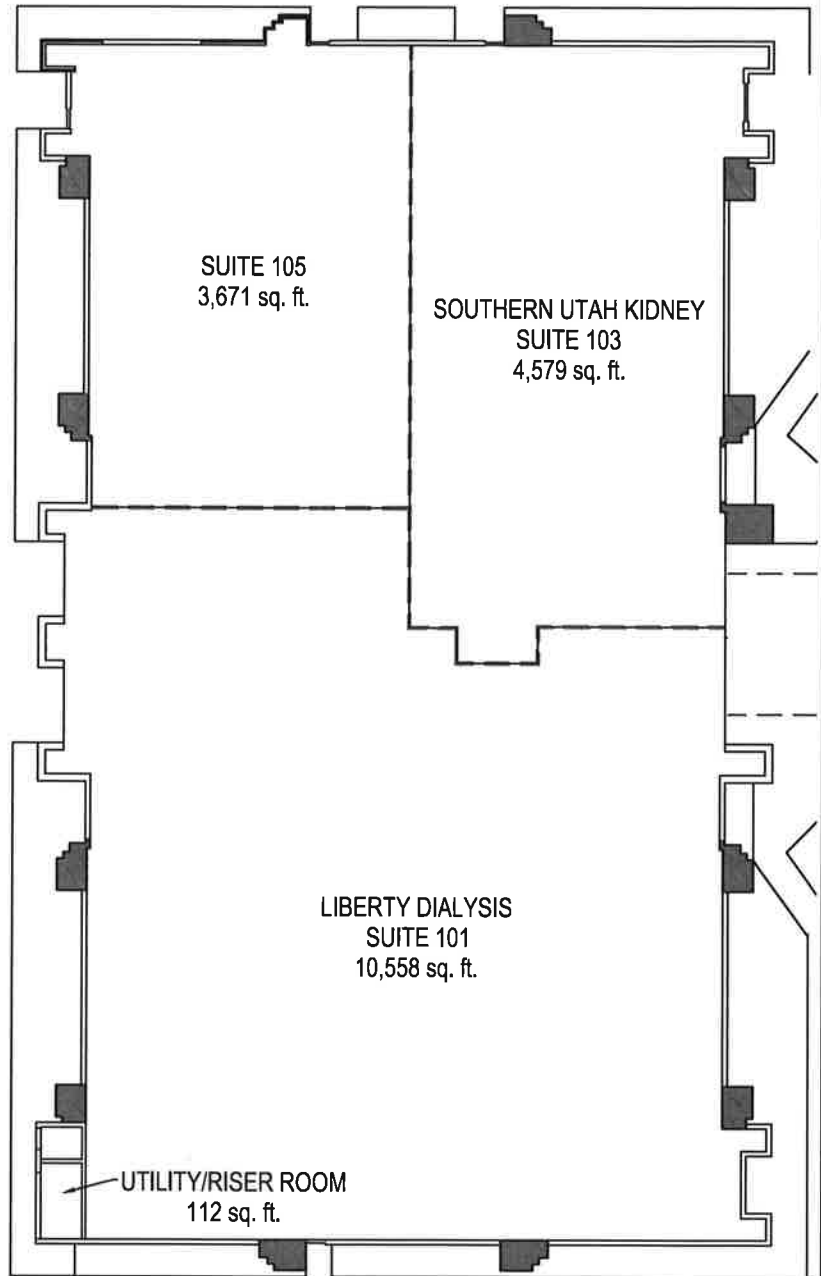
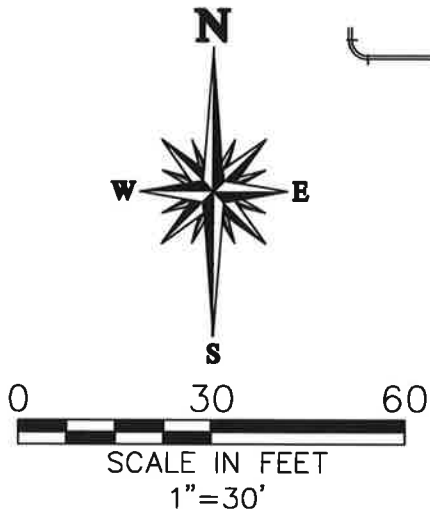

UNIT	USABLE AREA	UNIT
SUITE 101-LIBERTY DIALYSIS	10,558	SQ. FT.
SUITE 103-S.U. KIDNEY	4,579	SQ. FT.
SUITE 105-FUTURE	3,671	SQ. FT.
FIRE, WATER, UTILITY, POWER UTILITY/EXTERNAL WALL	1,015	SQ. FT.

NOTE:
USABLE AREA IS MEASURED TO THE CENTER OF
COMMON WALLS AND TO THE INTERIOR OF OUTSIDE
WALLS.

GROSS BUILDING AREA MEASURED PER BOMA
STANDARDS.

KIDNEY AND HYPERTENSION CENTER LEASE AREA TABLE (BOMA) STANDARD FEBRUARY 10, 2016

AREA DESCRIPTION	SUITE NUMBER	USABLE NET AREA (s.f.)	PERCENT OF GROSS BUILDING	PERCENT OF NET BUILDING	PRO-RATE COMMON AREAS (s.f.)	RENTABLE SQUARE FEET
LIBERTY DIALYSIS	101	10,558	53.3%	56.1%	569	11,127
SOUTHERN UTAH KIDNEY	103	4,579	23.1%	24.4%	248	4,827
FUTURE	105	3,671	18.5%	19.5%	198	3,869
SUBTOTAL NET BUILDING		18,808				
COMMON AREA		1,015	5.1%			
GROSS BUILDING AREA		19,823	100.0%			19,823



**BROWN
CONSULTING
ENGINEERS, P.C.**

CIVIL ENGINEERING-LAND SURVEYING-LAND PLANNING
188 WEST 1600 SOUTH, UNIT 6
ST. GEORGE, UTAH 84770
(435) 628-4700 FAX (435) 628-4725