

401

WEST 207th ST

CORNER OF 207TH STREET & 9TH AVE
INWOOD, NYC

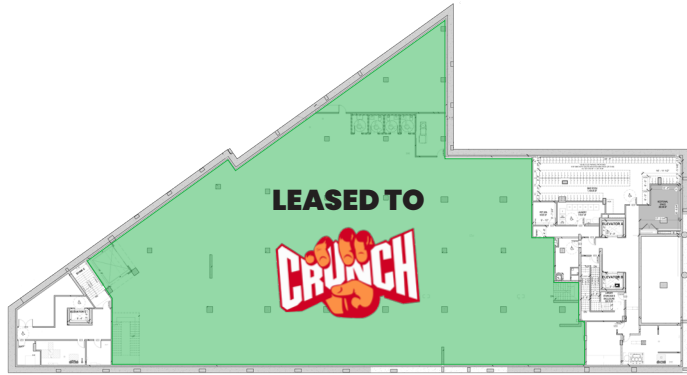

Lower Level

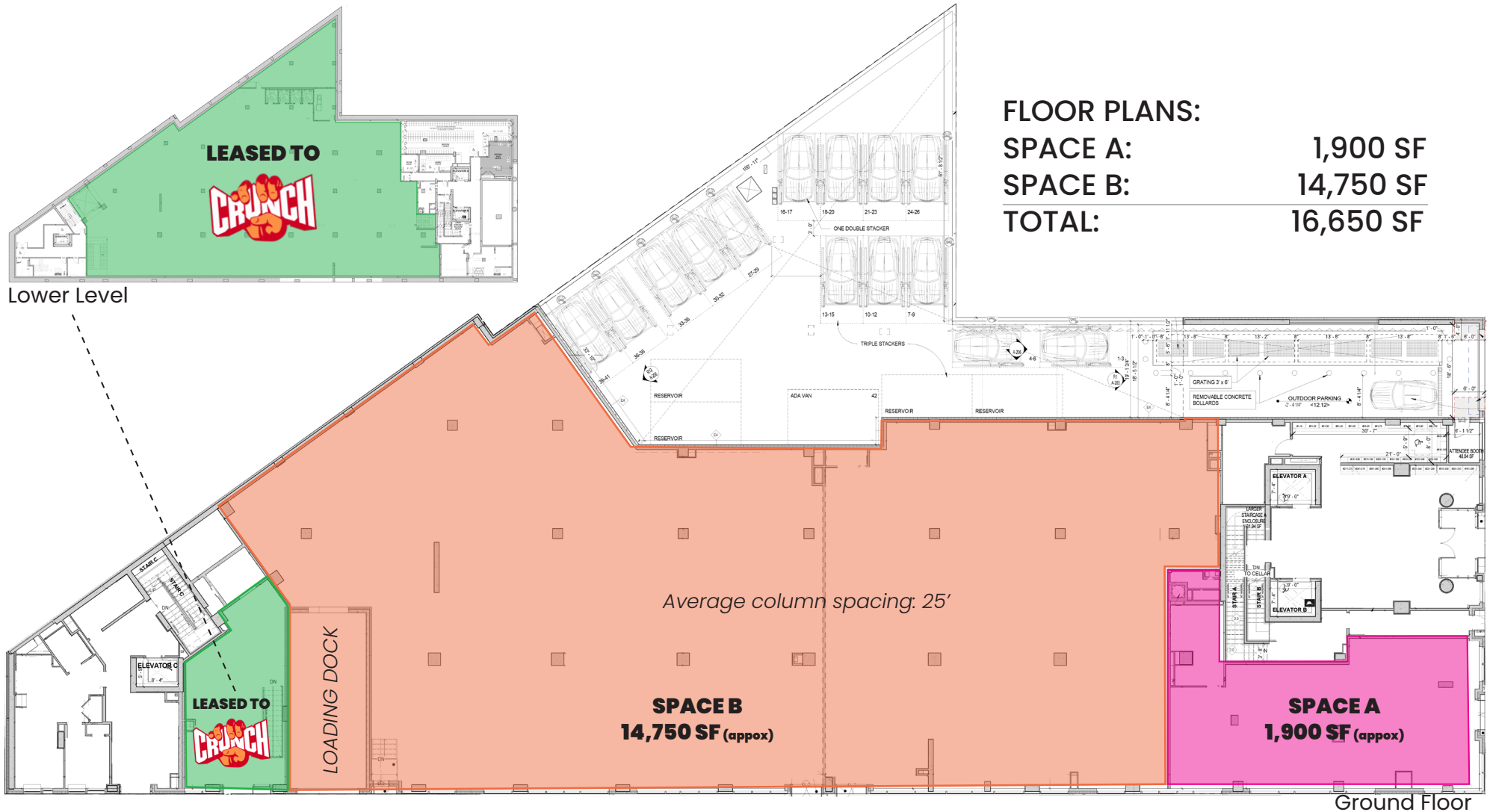

FLOOR PLANS:

SPACE A:	1,900 SF
SPACE B:	14,750 SF
TOTAL:	16,650 SF

SPACE A:
1,900 SF (GROUND FLOOR)

SPACE B:
14,750 SF (GROUND FLOOR)

401

WEST 207th ST

CORNER OF 207TH STREET & 9TH AVE
INWOOD, NYC

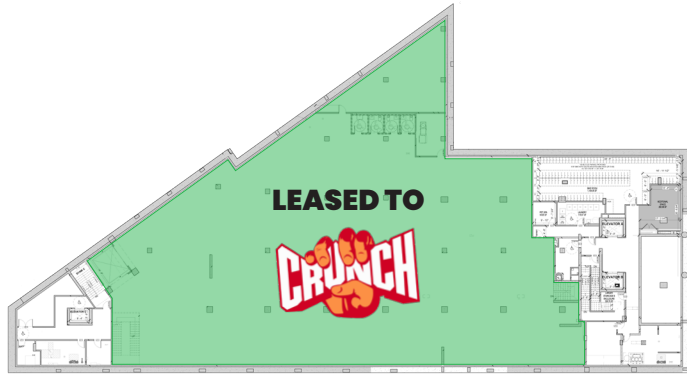

Lower Level

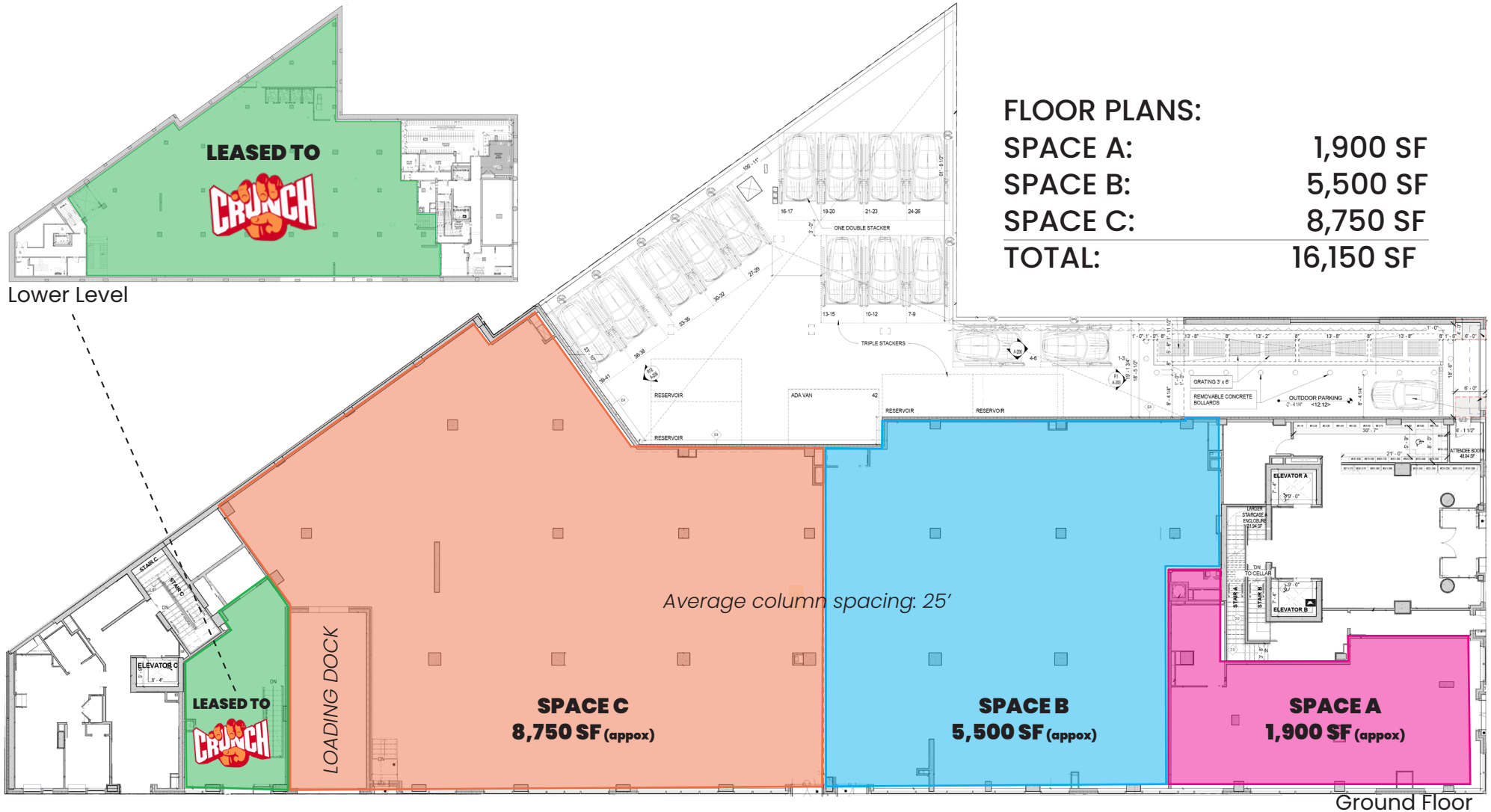

FLOOR PLANS:

SPACE A:	1,900 SF
SPACE B:	5,500 SF
SPACE C:	8,750 SF
TOTAL:	16,150 SF

SPACE A:
1,900 SF (GROUND FLOOR)

SPACE B:
5,500 SF (GROUND FLOOR)

SPACE C:
8,750 SF (GROUND FLOOR)