



Office Condo for Sale or Lease

**EASTLAND PARKWAY BUSINESS CENTER
19201 E VALLEY VIEW PARKWAY, INDEPENDENCE, MISSOURI**

Property Highlights

- 2,338 - 5,078 (±) sf available
- Excellent access to I-70, I-470 and 40 Highway
- Abundant retail, restaurants, professional services nearby
- End-cap unit with ample natural light
- For lease \$22.00/sf
- For sale \$1,040,990

For information, please contact:

Justin Beal

Senior Managing Director, Principal

t 816-268-4241

jbeal@nzimmer.com

Trey DeRousse

Associate

t 816-268-4236

tderousse@nzimmer.com

1220 Washington Street, Suite 300
Kansas City, MO 64105

nmrkzimmer.com



NEWMARK
ZIMMER

The information contained herein has been obtained from sources deemed reliable but has not been verified and no guarantee, warranty or representation, either express or implied, is made with respect to such information. Terms of sale or lease and availability are subject to change or withdrawal without notice.

19201 E VALLEY VIEW PARKWAY, INDEPENDENCE, MISSOURI

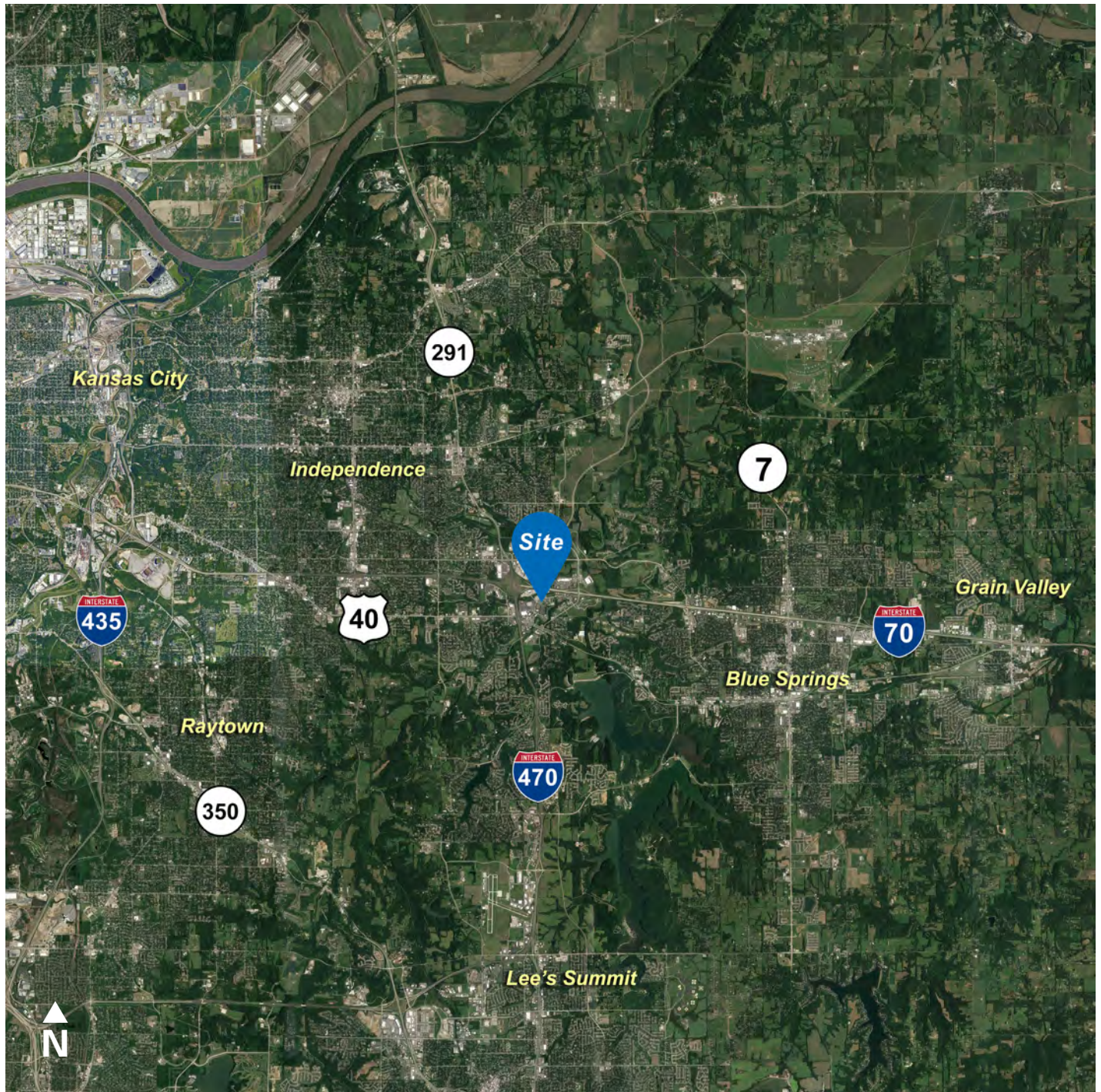

CONTACT

Justin Beal
Senior Managing Director, Principal
t 816-268-4241
jbeal@nzimmer.com

Trey DeRousse
Associate
t 816-268-4236
tderousse@nzimmer.com

nmrkzimmer.com

NEWMARK
ZIMMER

19201 E VALLEY VIEW PARKWAY, INDEPENDENCE, MISSOURI

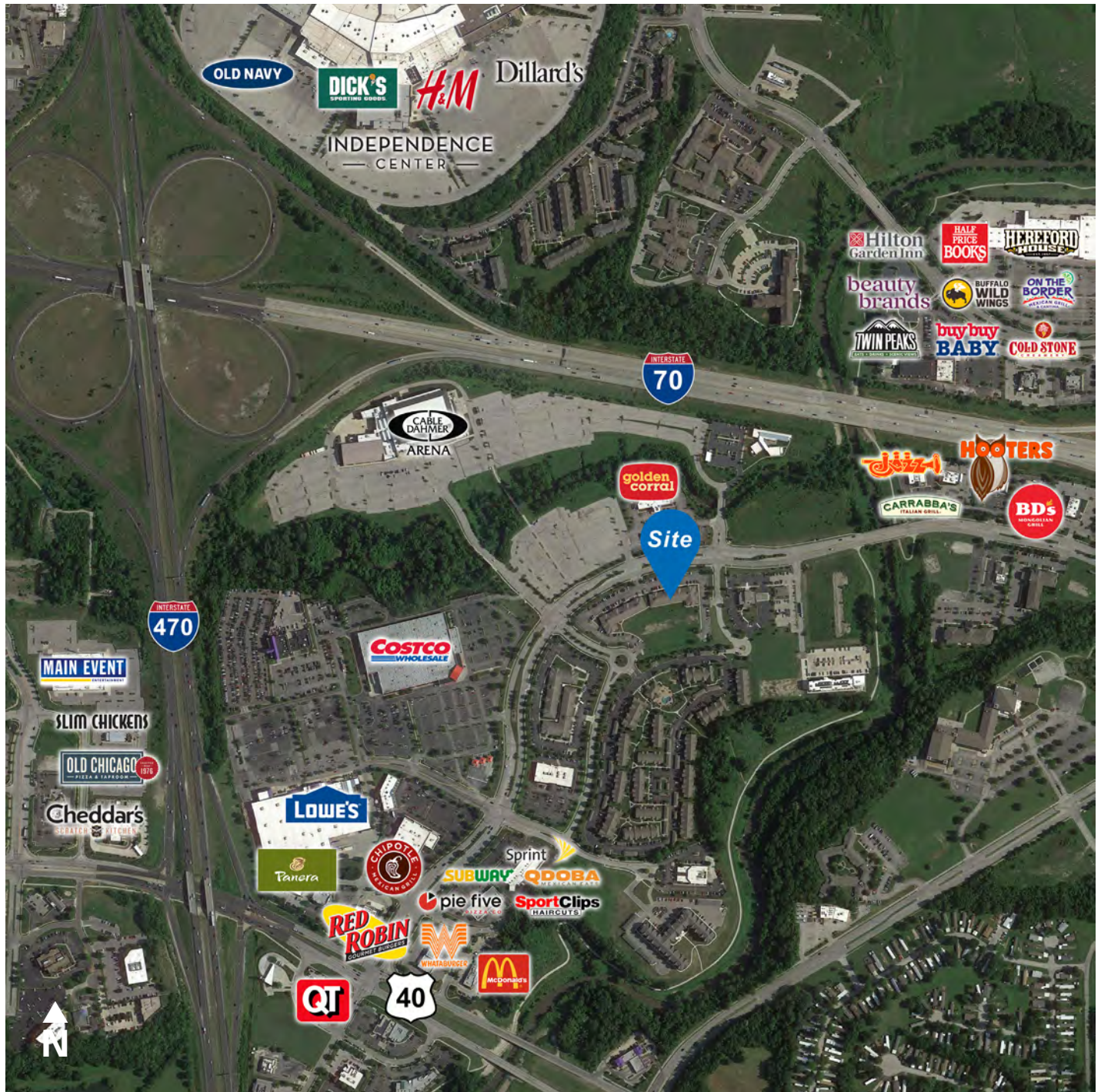

CONTACT

Justin Beal
Senior Managing Director, Principal
t 816-268-4241
jbeal@nzimmer.com

Trey DeRousse
Associate
t 816-268-4236
tderousse@nzimmer.com

nmrkzimmer.com

NEWMARK
ZIMMER

19201 E VALLEY VIEW PARKWAY, INDEPENDENCE, MISSOURI

Floor Plan (Suites G and H)

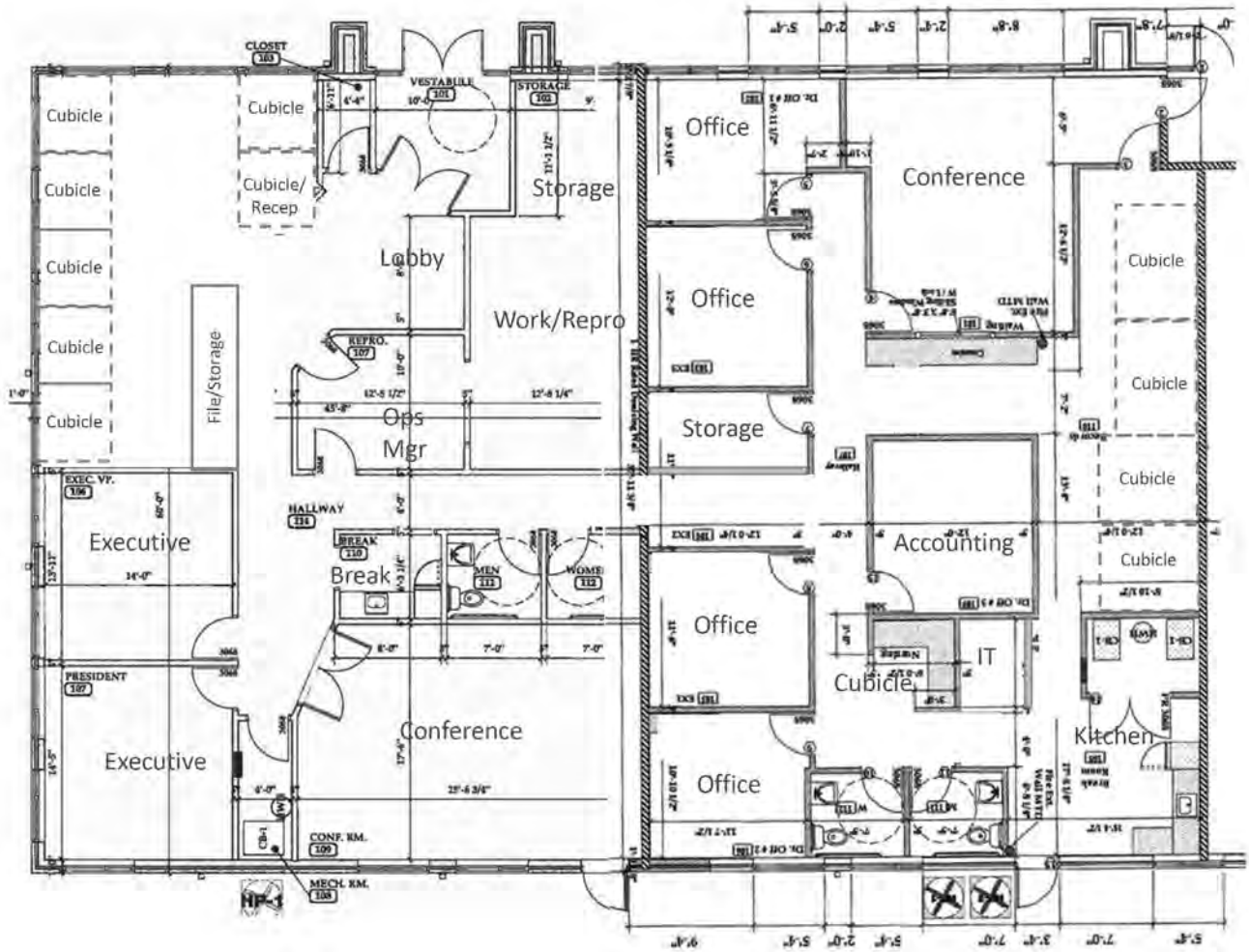

CONTACT

Justin Beal
Senior Managing Director, Principal
t 816-268-4241
jbeal@nzimmer.com

Trey DeRousse
Associate
t 816-268-4236
tderousse@nzimmer.com

nmrkzimmer.com



19201 E VALLEY VIEW PARKWAY, INDEPENDENCE, MISSOURI



CONTACT

Justin Beal
Senior Managing Director, Principal
t 816-268-4241
jbeal@nzimmer.com

Trey DeRousse
Associate
t 816-268-4236
tderousse@nzimmer.com

nmrkzimmer.com

NEWMARK
ZIMMER