

14 Murray Street

TRIBECA
NEW YORK, NY



CONCEPTUAL RENDERING

NEWMARK

14 MURRAY STREET

Property Details

Location

South block between Broadway and Church Street

Approximate Size

Ground Floor 850 SF*
Lower Level 3,500 SF
Total 4,350 SF

*Ground Floor can be taken with or without the Lower Level

Frontage

20 FT on Murray Street

Term

Negotiable

Possession

Immediate

Site Status

Formerly The UPS Store

Neighbors

Just Salad, LENWICH, Ito, New York Vinters, Whole Foods Market, Speak Out New York (coming soon), Juice Press, Bondi Sushi, Los Tacos No. 1, Tribeca Pediatrics, Target and Equinox

Comments

The space can be taken with or without the large legal lower level

The area is filled with a strong mix of residents, office workers, tourists and students

In close proximity to the **A C E 2 3 R W** and **PATH** train

Steps from the World Trade Center, Brookfield Place, 9/11 Memorial & Museum and City Hall

Four blocks from the 129,000 SF Ronald O. Perelman Performing Arts Center which can accommodate up to 1,200 people per night, opening soon

Building is not located in an LPC Historic District

Ground Floor

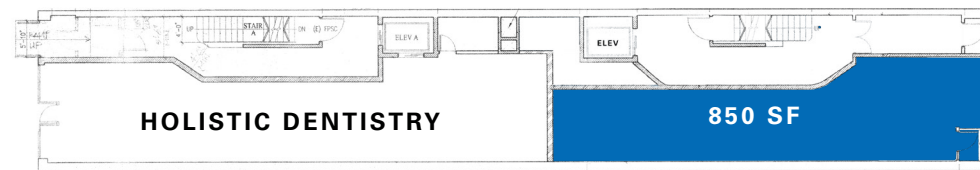

1-20 FT-1
MURRAY STREET

Lower Level

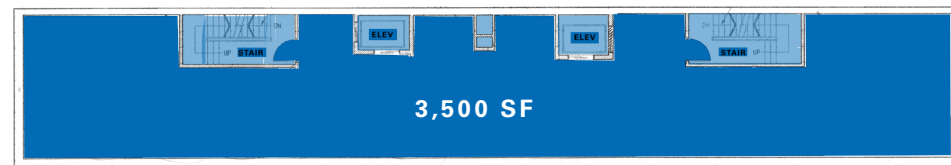

Interior Photos

GROUND FLOOR



LOWER LEVEL



GROUND FLOOR



LOWER LEVEL



14 MURRAY STREET



CONTACT

Andrew Stern
 t 212-351-9353
 andrew.stern@nmrk.com

Julia Singer
 t 212-655-1019
 julia.singer@nmrk.com

nmrk.com

+ COMING SOON