



For Lease

Contact the Agents:

Paul Raimundo

Senior Vice President
+1 780 917 4171
paul.raimundo@colliers.com

Bruce Peters

Vice President
+1 780 969 3033
bruce.peters@colliers.com

Tony Savchuk

Senior Associate
+1 780 969 3039
tony.savchuk@colliers.com



Accelerating success.

HP Business Centre

2943 50 Avenue, Edmonton, AB

- Flexible retail opportunities available
- New construction
- Great visibility from Whitemud Drive
- Excellent access

This document has been prepared by Colliers for advertising and general information only. Colliers makes no guarantees, representations or warranties of any kind, expressed or implied, regarding the information including, but not limited to, warranties of content, accuracy and reliability. Any interested party should undertake their own inquiries as to the accuracy of the information. Colliers excludes unequivocally all inferred or implied terms, conditions and warranties arising out of this document and excludes all liability for loss and damages arising there from. This publication is the copyrighted property of Colliers and /or its licensor(s). © 2026 All rights reserved. This communication is not intended to cause or induce breach of an existing listing agreement. Colliers Macaulay Nicolls Inc., Brokerage.

Property Overview

Municipal Address:
2943 50 Avenue, Edmonton, AB

Zoning:
Business Employment - BE

Lease Rates:
Market

Condo Fees:
\$5.25 PSF (est)

Operating Costs:
\$7.50 PSF

Tax:
\$48,739.40

Second Floor:
Fully Leased to a Daycare



Site Overview

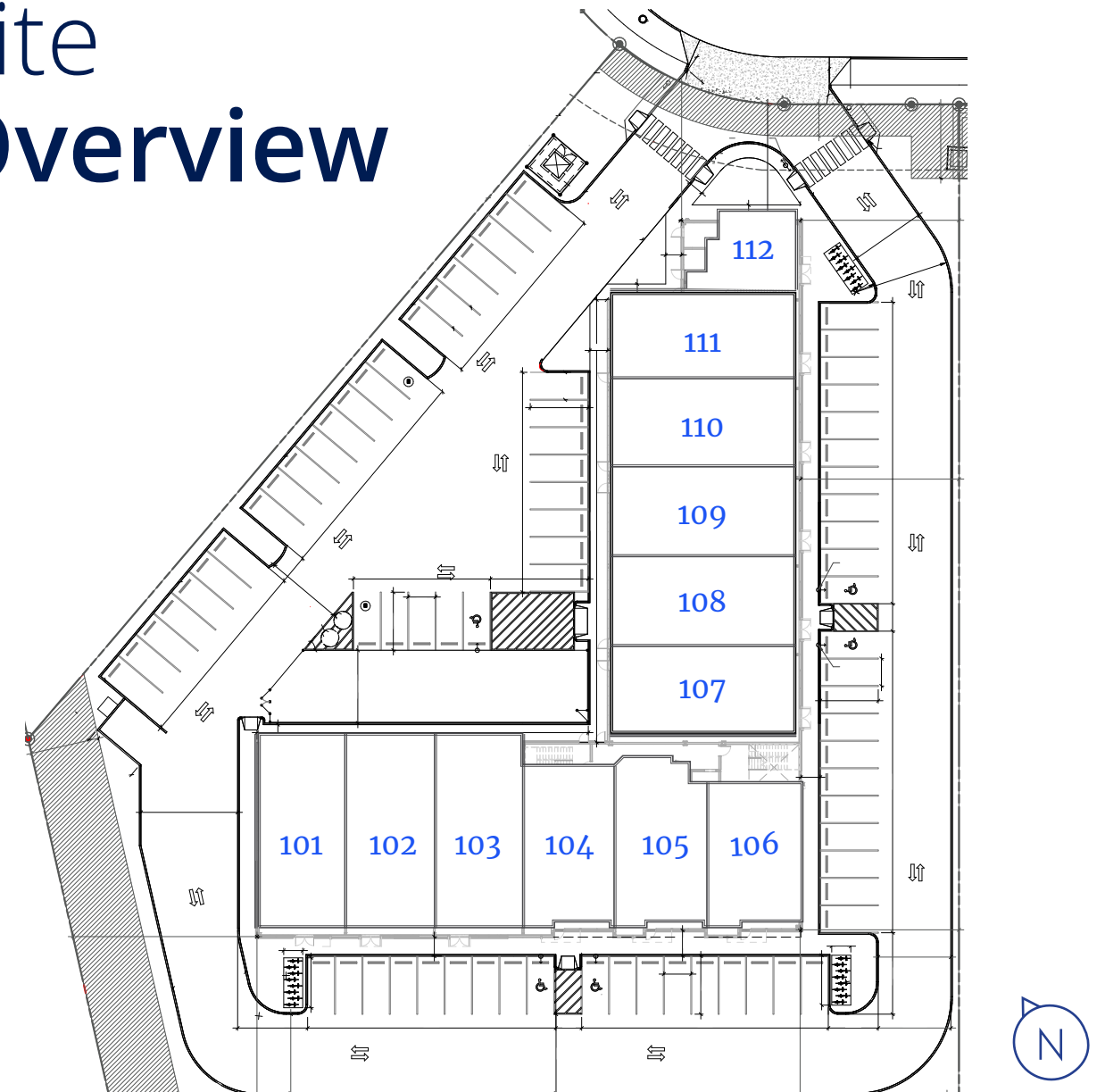

LEVEL 1

	Unit	Area (SF)	Price Per SF	List Price	Lease Price
• Market rates	101	1,650 SF	\$485	\$799,800	Market
• \$476 - 485 PSF sales rates	102	1,650 SF	\$485	\$799,800	Market
	103	1,650 SF	\$487	\$799,800	Market
• 1,268 SF - 1650 SF range	104	1,438 SF	\$498	\$699,800	Market
	105	1,405 SF	\$512	\$699,800	Market
• 17,708 SF total available	106	1,268 SF	\$476	\$649,800	Market
	107	1,637 SF	\$476	\$779,800	Market
• Immediate availability	108	1,638 SF	\$476	\$779,800	Market
	109	1,638 SF	\$476	\$779,800	Market
	110	1,638 SF	\$476	\$779,800	Market
• Units 101 - 103 and 107 - 111 have 22' ceilings, allowing for mezzanines or second floors.	111	1,635 SF	\$477	\$779,800	Market
	112	1,565 SF incl. second floor	\$479	\$699,800	Market

2943 50 Avenue, Edmonton

Paul Raimundo

Senior Vice President
+1 780 917 4171
paul.raimundo@colliers.com

Bruce Peters

Vice President
+1 780 969 3033
bruce.peters@colliers.com

Tony Savchuk

Senior Associate
+1 780 969 3039
tony.savchuk@colliers.com

AMENITIES

- | | |
|----------------|----------------------|
| 1. Walmart | 6. Sportchek |
| 2. McDonalds | 7. Petsmart |
| 3. Home Depot | 8. Shoppers Drugmart |
| 4. Tim Hortons | 9. Sobeys |
| 5. Superstore | 10. Esso |

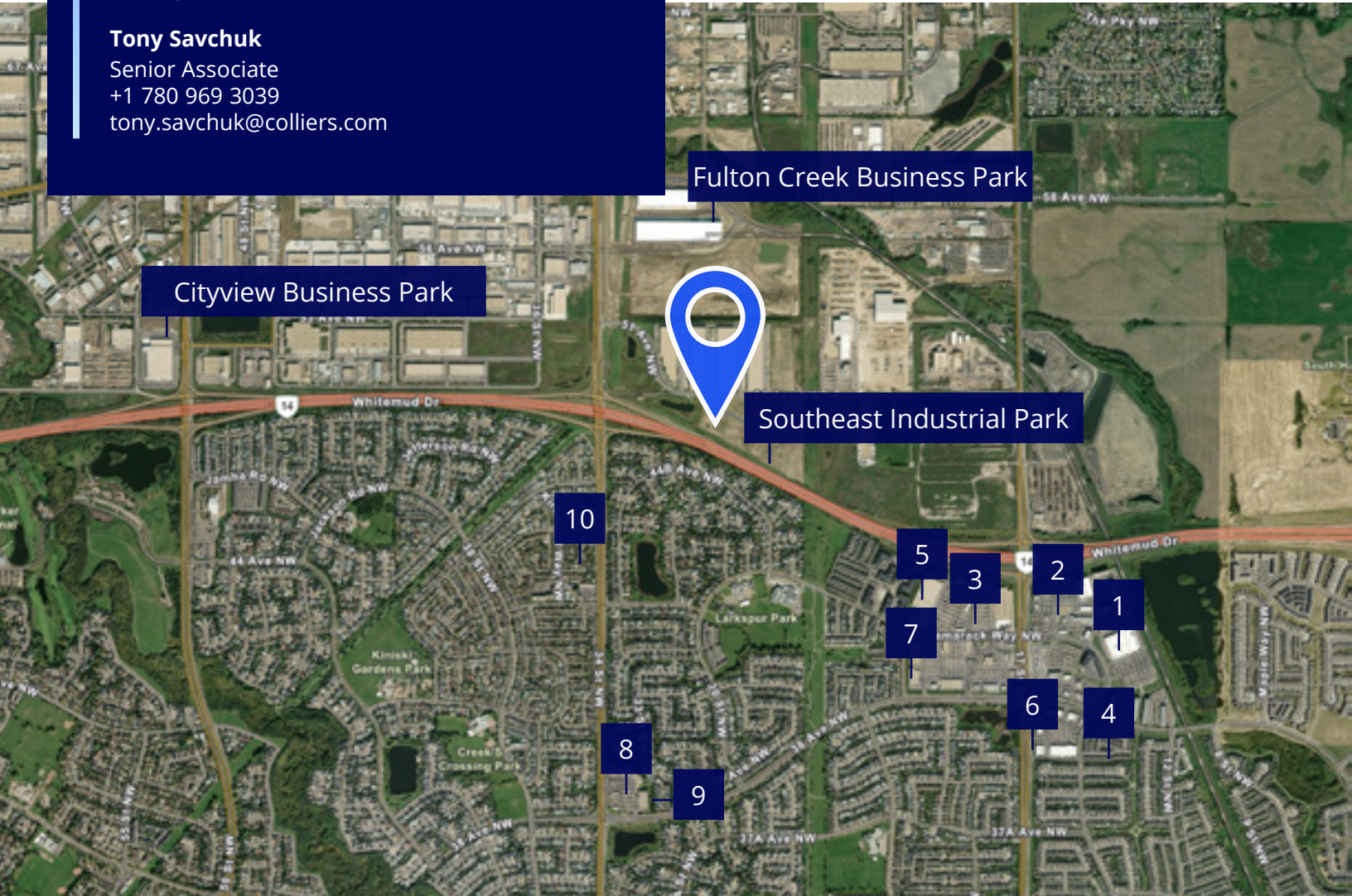

122,690
Current Population
(2025)



147,729
Projected Population
(2035)



124,827
Daytime Population
(2025)



\$115,307
Average Household
Income (2025)