

# WHITESTONE

## LOGISTICS CENTER

28-10 WHITESTONE EXPRESSWAY, QUEENS, NEW YORK 11356



CLASS A NEW CONSTRUCTION

**313,496 SF**  
FOR LEASE



# SPACE FEATURES

WHITESTONE  
LOGISTICS CENTER



## SQUARE FOOTAGE

80,612 SF Warehouse (Ground Floor)  
164,725 SF Structured Parking (Levels 2-3)  
68,159 SF Exterior/Truck Court



## CLEAR HEIGHT

36' Warehouse  
11' 2" Parking



## LOADING CAPACITY

13 Loading Docks  
3 Drive-In Doors



## POWER

3000 Amps  
120/208V Service



## ICAP TAX ABATEMENT

# SITE PLAN



**SCHEMATIC UNIT A**  
Warehouse: 38,975 SF  
Parking/Truck Court: 29,633 SF  
Loading Docks: 7  
Drive-In Door: 1 Double Wide

**SCHEMATIC UNIT B**  
Warehouse: 41,637 SF  
Parking/Truck Court: 27,158 SF  
Loading Docks: 6  
Drive-in Doors: 2



4 Access Points



Loading On 2 Sides



800 PSF Floor Loads



Direct Access To Whitestone Expy Frontage Road

# STATE OF THE ART INDUSTRIAL WAREHOUSE

WITH INTEGRATED PARKING



164,725 SF parking garage  
can be leased alone  
Building in a building opportunity



Double-wide ramp



Fully secured & vented

## LEVEL 2

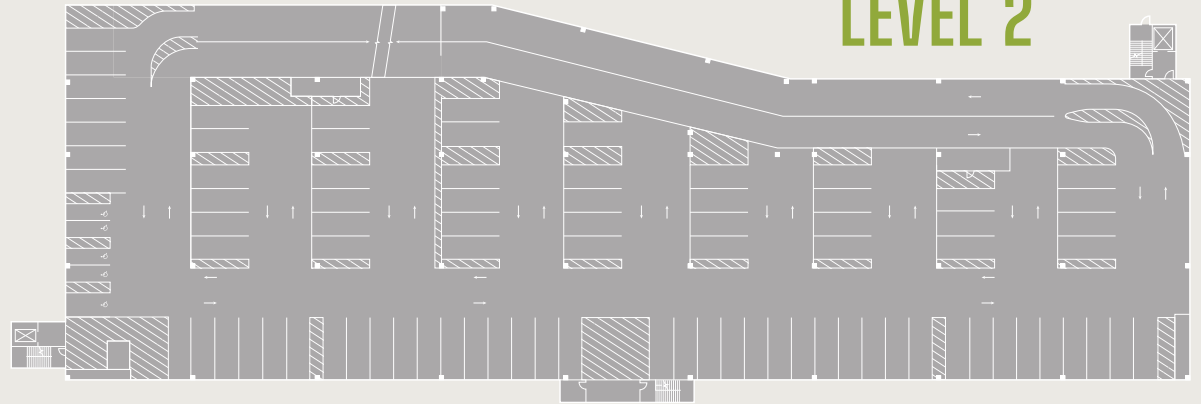

## LEVEL 3

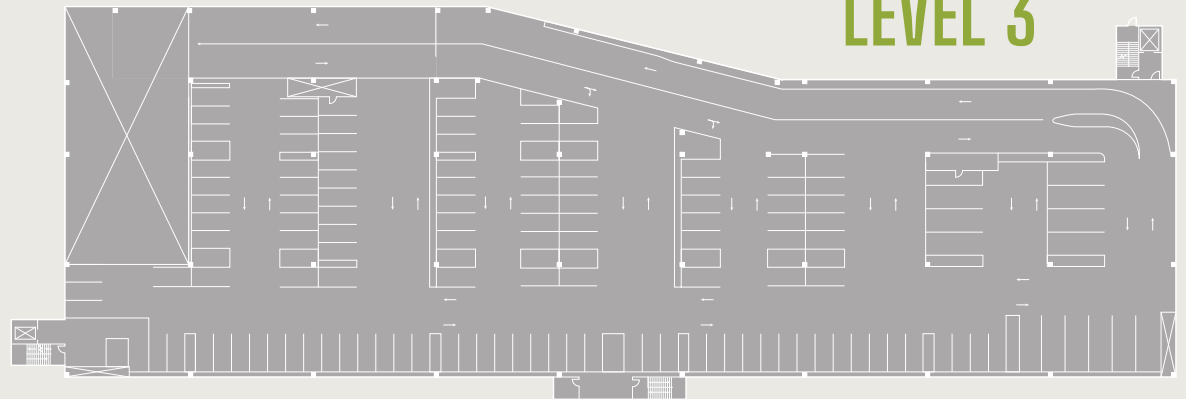

# DRIVE TIMES & DEMOGRAPHICS



DRIVE TIMES

**30 MINUTES**

**60 MINUTES**



POPULATION

**6,728,914**

**15,705,421**



AVG HH INCOME

**\$119,982**

**\$138,440**



**REACH OVER 15 MILLION**  
CONSUMERS IN A ONE HOUR DRIVE TIME

## DRIVE DISTANCES

I-678	0.4 MILES
WHITESTONE BRIDGE	1.9 MILES
I-495	2.4 MILES
LGA	2.4 MILES
THROGS NECK BRIDGE	3.8 MILES
I-278	4.4 MILES
RFK BRIDGE	5.1 MILES
GOLD COAST, LONG ISLAND	8.8 MILES
QUEENSBORO BRIDGE	9.0 MILES
JFK	9.1 MILES

# WHITESTONE

LOGISTICS CENTER

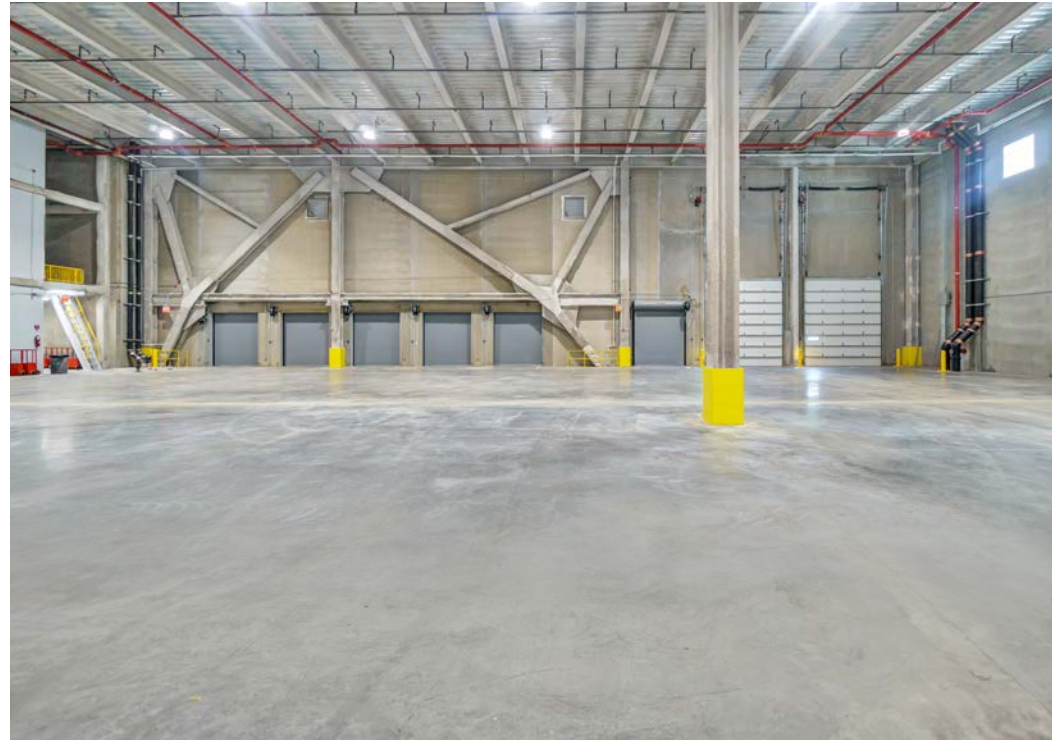
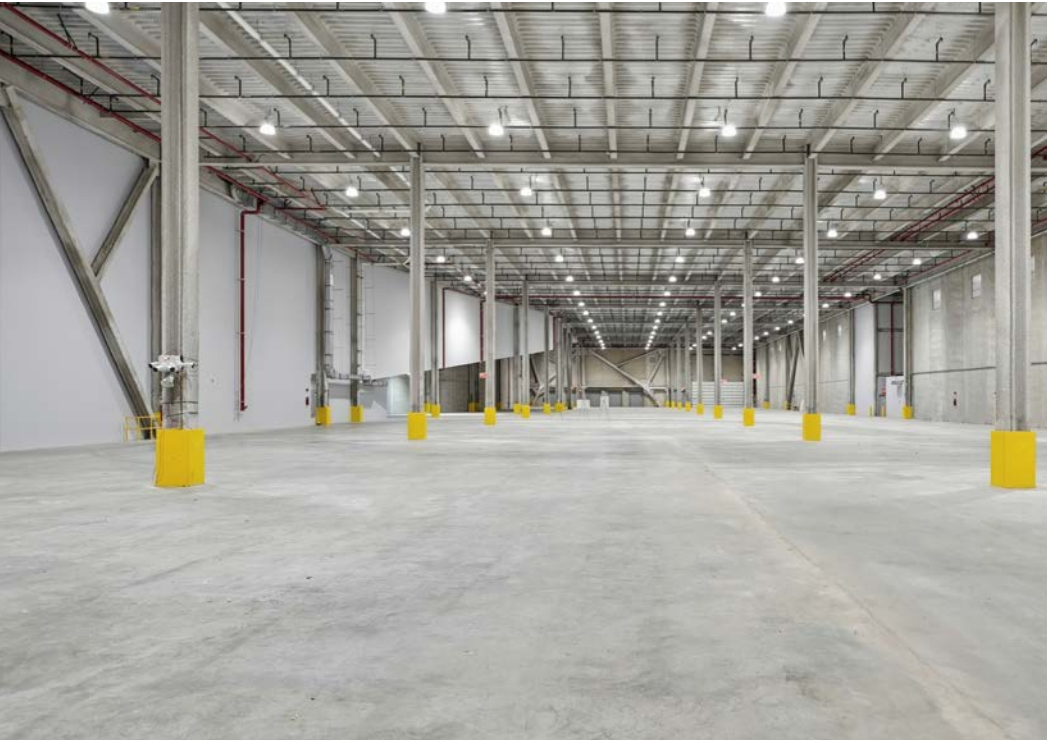



**HELEN PAUL**

+1 212 841 7575

[helen.paul@cushwake.com](mailto:helen.paul@cushwake.com)

**RICO MURTHA**

+1 212 390 1368

[rico.murtha@cushwake.com](mailto:rico.murtha@cushwake.com)

**SONNY SINGH**

+1 718 275 5478

[sonny.singh@cushwake.com](mailto:sonny.singh@cushwake.com)

**DAN DONAHUE**

+1 212 713 6864

[dan.donahue@cushwake.com](mailto:dan.donahue@cushwake.com)

