

© Copyright 2014, All Rights Reserved.
 This drawing is the property of Timothy Morgan Associates LLC. It is to be used only for the project and site identified on this drawing. It is not to be reproduced or used for any other project without the written consent of Timothy Morgan Associates LLC.

No.	DATE	REVISION DESCRIPTION

PASQUESI PLUMBING
3218 SKOKIE VALLEY ROAD
 HIGHLAND PARK, ILLINOIS
 FRIGO & COMPANY

DRAWING TITLE:
SITE PLAN

DATE:
07/16/14

PROJECT NO. / SHEET NO.:

14-022
A001

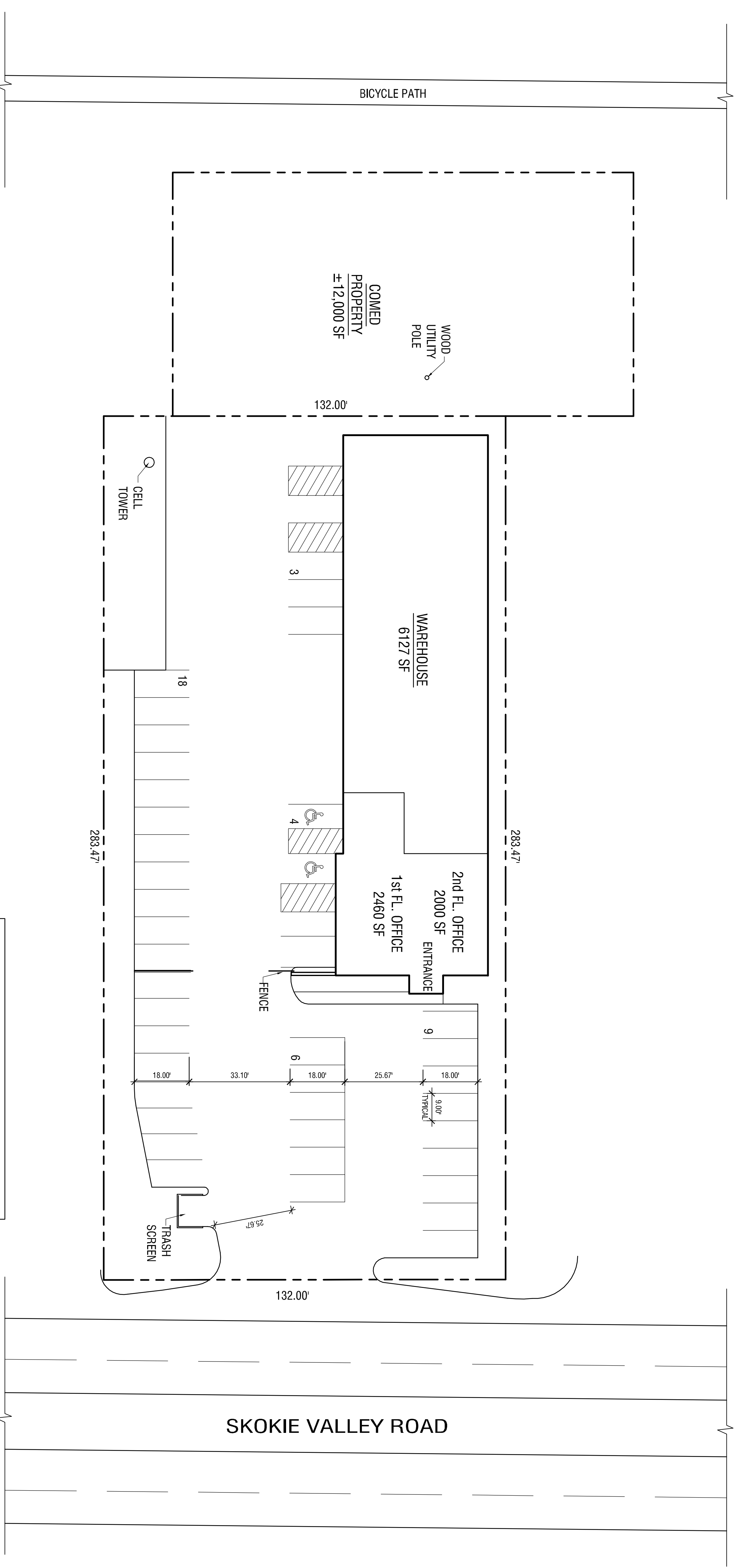

1 SITE PLAN
 A001
 Scale: 1" = 20'-0"

SITE DATA

ZONING: B3 HIGHWAY COMMERCIAL
 SITE AREA: 37,429 SF = 0.86 ACRE
 FIRST FLOOR AREA:
 AVS/BUDGET OFFICE = 500 SF
 PASQUESI OFFICE = 1,910 SF
 SECOND FLOOR AREA:
 PASQUESI OFFICE = 2,000 SF
 FIRST FLOOR WAREHOUSE:
 PASQUESI WAREHOUSE = 6,127 SF
 TOTAL BUILDING AREA = 10,587 SF

PARKING REQUIREMENTS:
 AVS/BUDGET OFFICE @ 2.5/1000 = 1 SPACE
 PASQUESI OFFICE @ 4/1000 = 16 SPACES
 PASQUESI WAREHOUSE @ 0.5/1000 = 3 SPACES
 TOTAL PARKING REQUIRED = 20 SPACES

OFFICE & WAREHOUSE PARKING PROVIDED = 40 SPACES
 HIGHLAND PARK MINIMUM SIZE OF 90° PARKING:
 17'-11" x 8'-6" WITH 25'-8" AISLES