

SUMMARY

PHOTOS

4TH FLOOR

LOCATION

FOR LEASE

PROPERTY OVERVIEW

Located in Mobile's CBD, One St. Louis Centre offers professional office space in a Class A, multi-tenant office building. Positioned at the intersection of Water Street and St. Louis Street, the building provides for great access and visibility. Amenities include: available on-site parking, modern finishes, and abundant options for restaurants, hotels, fitness facilities, and public parks within walking distance.

Currently 100% leased. Suite 4100 available late Spring 2024. Call for details.

AVAILABLE	FLOOR	SIZE	DESCRIPTION
Suite 4100	4th Floor	5,100 SF	Fully improved – future availability

RENTAL RATE

- \$19.00/SF Annual
- Parking: \$80.00/Month

BUILDING INFORMATION

- Office Class: A
- Gross Building Area: 97,723 RSF
- Ceiling Height: 9'
- Number of Stories: 5
- Exterior: Brick
- Interior: Lobby is finished with granite and marble. Custom finishes exist throughout.
- Air Conditioning: Engineered System

SUMMARY

PHOTOS

4TH FLOOR

LOCATION



SUMMARY

PHOTOS

4TH FLOOR

LOCATION

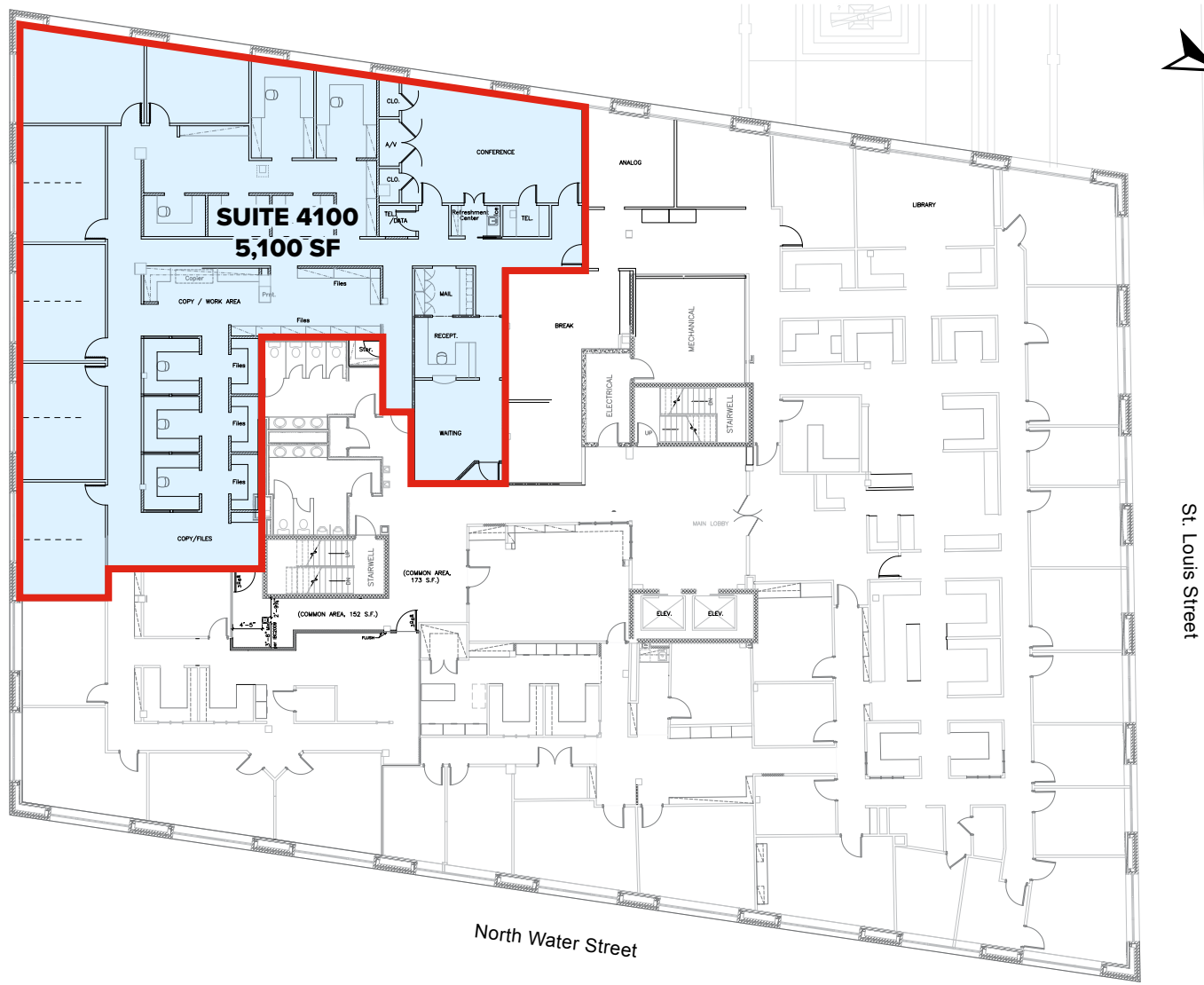

SUMMARY

PHOTOS

4TH FLOOR

LOCATION

