

# NORTH PRESTON VILLAGE

790 N. PRESTON RD., PROSPER, TX 75078

FOR LEASE

AVAILABLE  
1,313 SF

## Site Plan

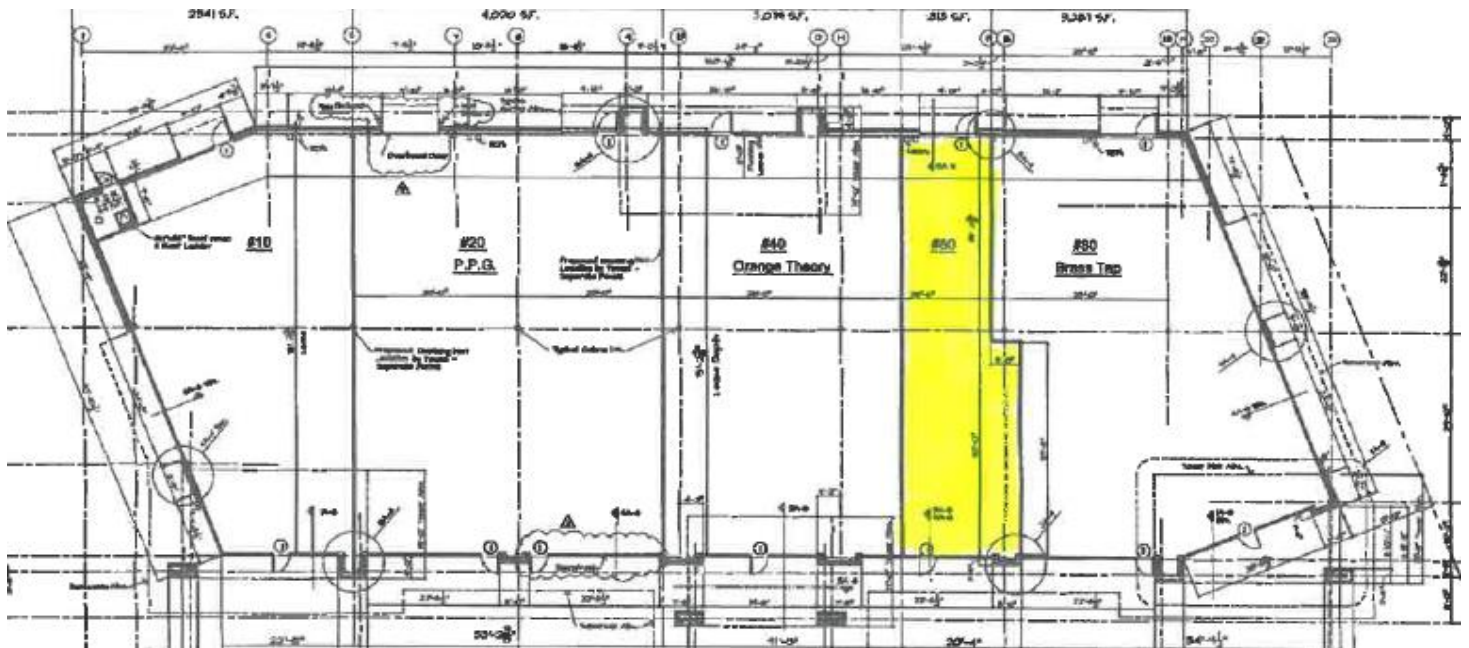

FOR MORE INFORMATION:

BILL RUDD | 972.422.4515 | [bill@haggardgroup.com](mailto:bill@haggardgroup.com)

**HAGGARD**  
PROPERTY GROUP, LTD.



# NORTH PRESTON VILLAGE

## 790 N. PRESTON RD., PROSPER, TX 75078

FOR LEASE

### Demographics



#### Demographic and Income Profile

790 North Preston Road  
790 N Preston Rd, Prosper, Texas, 75078  
Ring: 3 mile radius

Prepared by Esri  
Latitude: 33.24307  
Longitude: -96.78619

| Summary                         | Census 2010 | 2019    | 2024      |         |        |         |
|---------------------------------|-------------|---------|-----------|---------|--------|---------|
| Population                      | 11,249      | 31,479  | 41,257    |         |        |         |
| Households                      | 3,540       | 9,697   | 12,651    |         |        |         |
| Families                        | 3,048       | 8,183   | 10,656    |         |        |         |
| Average Household Size          | 3.18        | 3.25    | 3.26      |         |        |         |
| Owner Occupied Housing Units    | 2,853       | 8,723   | 11,515    |         |        |         |
| Renter Occupied Housing Units   | 687         | 974     | 1,136     |         |        |         |
| Median Age                      | 34.6        | 35.5    | 34.9      |         |        |         |
| Trends: 2019 - 2024 Annual Rate | Area        | State   | National  |         |        |         |
| Population                      | 5.56%       | 1.59%   | 0.77%     |         |        |         |
| Households                      | 5.46%       | 1.55%   | 0.75%     |         |        |         |
| Families                        | 5.42%       | 1.53%   | 0.68%     |         |        |         |
| Owner HHs                       | 5.71%       | 1.63%   | 0.92%     |         |        |         |
| Median Household Income         | 2.37%       | 2.50%   | 2.70%     |         |        |         |
| Households by Income            | 2019        |         | 2024      |         |        |         |
|                                 | Number      | Percent | Number    | Percent |        |         |
| <\$15,000                       | 380         | 3.9%    | 354       | 2.8%    |        |         |
| \$15,000 - \$24,999             | 220         | 2.3%    | 227       | 1.8%    |        |         |
| \$25,000 - \$34,999             | 253         | 2.6%    | 249       | 2.0%    |        |         |
| \$35,000 - \$49,999             | 346         | 3.6%    | 375       | 3.0%    |        |         |
| \$50,000 - \$74,999             | 872         | 9.0%    | 1,024     | 8.1%    |        |         |
| \$75,000 - \$99,999             | 1,074       | 11.1%   | 1,238     | 9.8%    |        |         |
| \$100,000 - \$149,999           | 2,257       | 23.3%   | 2,852     | 22.5%   |        |         |
| \$150,000 - \$199,999           | 1,724       | 17.8%   | 2,564     | 20.3%   |        |         |
| \$200,000+                      | 2,571       | 26.5%   | 3,768     | 29.8%   |        |         |
| Median Household Income         | \$133,520   |         | \$150,085 |         |        |         |
| Average Household Income        | \$164,180   |         | \$182,512 |         |        |         |
| Per Capita Income               | \$50,946    |         | \$56,286  |         |        |         |
| Population by Age               | Census 2010 |         | 2019      |         | 2024   |         |
|                                 | Number      | Percent | Number    | Percent | Number | Percent |
| 0 - 4                           | 945         | 8.4%    | 2,302     | 7.3%    | 3,150  | 7.6%    |
| 5 - 9                           | 1,264       | 11.2%   | 2,585     | 8.2%    | 3,333  | 8.1%    |
| 10 - 14                         | 1,193       | 10.6%   | 2,878     | 9.1%    | 3,490  | 8.5%    |
| 15 - 19                         | 804         | 7.1%    | 2,485     | 7.9%    | 3,133  | 7.6%    |
| 20 - 24                         | 388         | 3.4%    | 1,617     | 5.1%    | 2,006  | 4.9%    |
| 25 - 34                         | 1,078       | 9.6%    | 3,644     | 11.6%   | 5,588  | 13.5%   |
| 35 - 44                         | 2,278       | 20.3%   | 4,486     | 14.3%   | 5,808  | 14.1%   |
| 45 - 54                         | 1,748       | 15.5%   | 4,870     | 15.5%   | 5,542  | 13.4%   |
| 55 - 64                         | 923         | 8.2%    | 3,586     | 11.4%   | 4,663  | 11.3%   |
| 65 - 74                         | 450         | 4.0%    | 2,086     | 6.6%    | 2,979  | 7.2%    |
| 75 - 84                         | 145         | 1.3%    | 760       | 2.4%    | 1,299  | 3.1%    |
| 85+                             | 31          | 0.3%    | 181       | 0.6%    | 267    | 0.6%    |

FOR MORE INFORMATION:

BILL RUDD | 972.422.4515 | bill@haggardgroup.com

