



the **ZEPP COMPANY**
Commercial Real Estate Services

Healthcare Development * Construction * Real Estate

For Sale or For Lease
STARCREEK
Medical Office Campus
SWC SRT / S.H. 121 @ N Watters Rd
Allen, Texas 75013

Another Development by **Golan Properties.com**



Property Details: Located at the SWC of the Sam Rayburn Tollway (SRT) @ N. Watters Rd. The buildings will be constructed of crème colored stone having a retail office design consistent with the City of Allen requirements for the area. **STARCREEK Medical Office Campus** is situated on the north side of **Lifetime Fitness** and to the west side of STARCREEK/CINEMARK Center as shown in this brochure.

PROPERTY DATA

The medical office campus is situated on approximately 3.4 acres and is to the south of STARCREEK Retail as shown.

STARCREEK Medical will be 5 office condos which can be subdivided to suit your needs.

Office/ Medical – Office

Building 1	7936 SF
Building 2	5246 SF
Building 3	5400 SF
Building 4	6255SF
Building 5	7008 SF

Shell Cost: \$280- \$315 psf



FOR INFORMATION CONTACT

Katina Zepp | **Ph.214-676-3709**
katina@katinazepp.com
zeppcompany.com

Information furnished, while obtained by sources believed reliable, has not been verified by Katina Zepp and the ZEPP Company. We make no guarantee, warranty or representation as to its accuracy and completeness. It is submitted subject to independent investigation by you, without reliance on us. This submission is subject to change in price, prior to sale or withdrawal without notice.

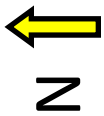

S.H. 121/ SAM RAYBURN TOLLWAY (SRT)

N. WATTERS ROAD

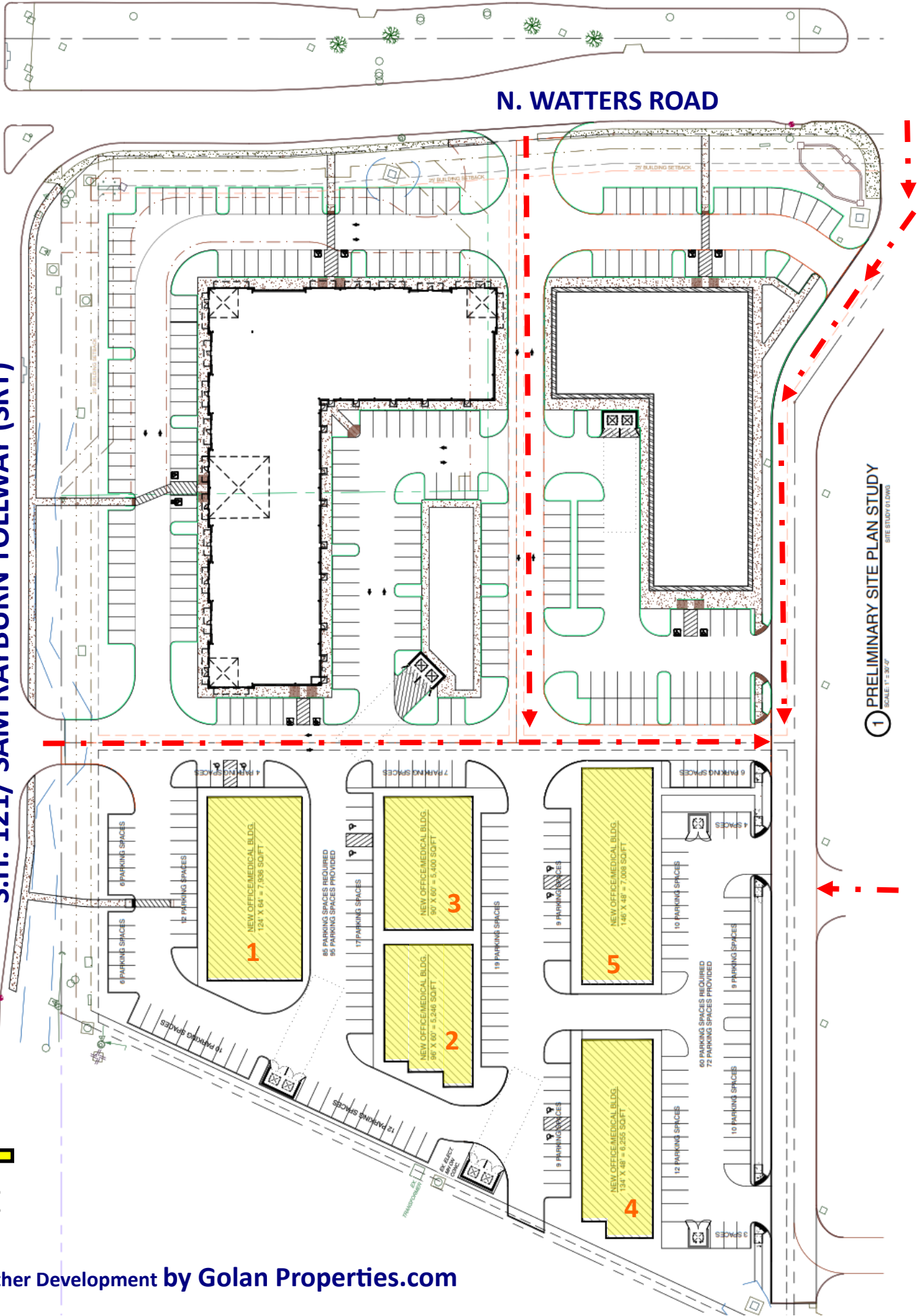

1 PRELIMINARY SITE PLAN STUDY
SCALE 1" = 30'-0"
SITE STUDY 01.DWG

Another Development by Golan Properties.com

For Sale or For Lease
STARCREEK

Medical Office Campus
SWC SRT / S.H. 121 @ N Watters Rd
Allen, Texas 75013

FOR INFORMATION

Katina Zepp | **Ph.214-676-3709**

katina@katinazepp.com

zeppcompany.com

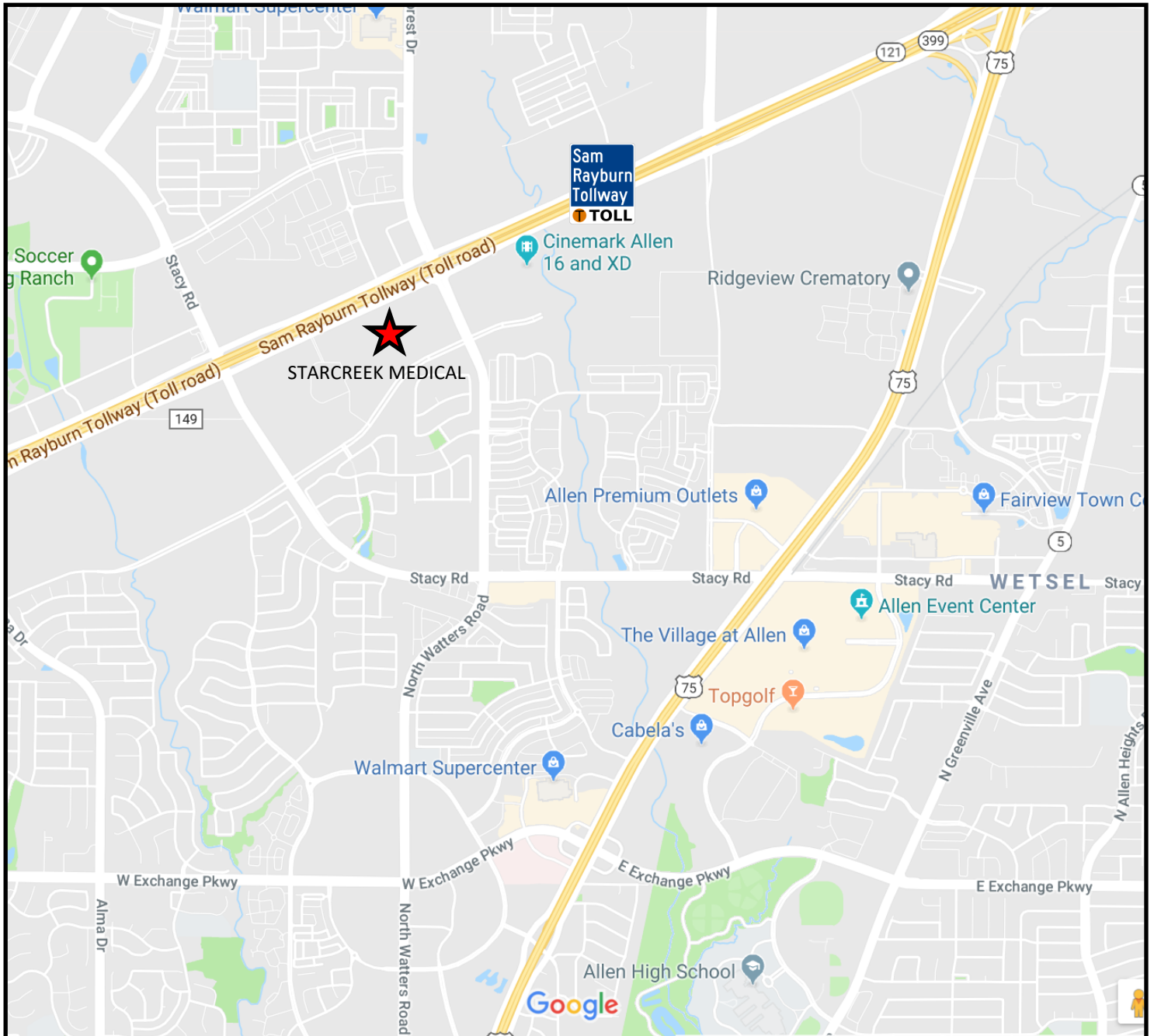

Another Development by **Golan Properties.com**