

Thorpe Wood Development Site, Peterborough PE3 6SB

LOCATION

Peterborough is an attractive cathedral city in one of the fastest growing regions in the country. It has a population of approximately 158,000 people and a catchment of 520,000 within a 20 mile radius.

It has recently been included within the London-Standed-Cambridge 'growth corridor' and is scheduled to have approximately 22,000 new houses and 18,000 new jobs increasing the population by 40,000 by 2020.

Major office occupiers in Peterborough include : Thomas Cook, Pearl, EMAP, Norwich & Peterborough Building Society, Budget Insurance, Travelex, the Environment Agency, The Land Registry and The Passport Office.

LOCATION

The site is well located fronting Thorpe Wood Road, a short distance from Junction 15 of the A47 and the A1260 (Peterborough Ring Road) and approximately 2¼ miles from Peterborough city centre. Neighbouring occupiers include Thorpe Wood Health & Racquets Club, Lloyds TSB, Travelex, Churchill Insurance and Anglian Water. Also close by is Thorpe Wood Golf Club and the Holiday Inn Hotel.

DESCRIPTION

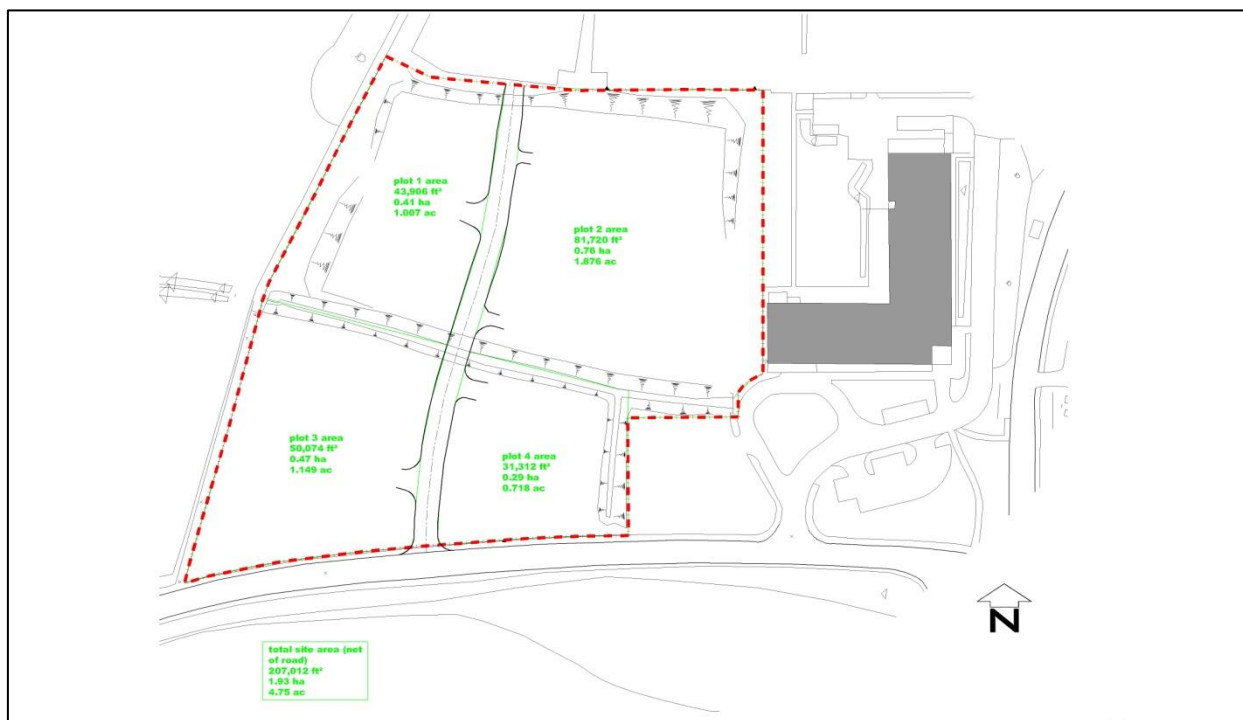

ACCOMMODATION

Plots can be combined to develop units from 31,312 Sq Ft.

Description	Acres	Hectares
Plot 1	1.007	0.41
Plot 2	1.876	0.76
Plot 3	Sold	
Plot 4	0.718	0.29

LEGAL COSTS

Each party to bear their own legal costs in respect of the transaction.

VIEWING

Strictly by appointment with the sole agents.

Paul Farrow

Email : pfarrow@savills.com
Tel : 01733 201391

Edward Gee

Email : egee@savills.com
Tel : 01733 209906

IMPORTANT NOTICE

Savills, their clients and any joint agents give notice that:-

- They are not authorised to make or give any representations or warranties in relation to the property either here or elsewhere, either on their own, behalf of their client or otherwise. They assume no responsibility for any statement that may be made in these particulars. These particulars do not form part of any offer or contract and must not be relied upon as statements or representations of fact.
- Any areas, measurements or distances are approximate. The text, photographs and plans are for guidance only and are not necessarily comprehensive. It should not be assumed that the property has all necessary planning, building regulation or other consents and Savills have not tested any services, equipment or facilities. Purchasers must satisfy themselves by inspection or otherwise.

Figures quoted in these particulars may be subject to VAT in addition.

Compiled: April 2016