

THE NEIGHBORHOOD

LoSo

Located at the intersection of Tryclan Drive and Dewitt Lane in the Lower South End neighborhood of Charlotte, NC, there is an **entertainment district** that is easily accessible by light rail via the Scaleybank Station located only 500 yards away!

Since 2020, this section of LoSo has seen over 50,000 SF of leases signed with entertainment, fitness and food and beverage users.

The LoSo neighborhood overall is experiencing **rapid residential growth** with over 4,900 units delivered or under construction within a mile from this intersection.

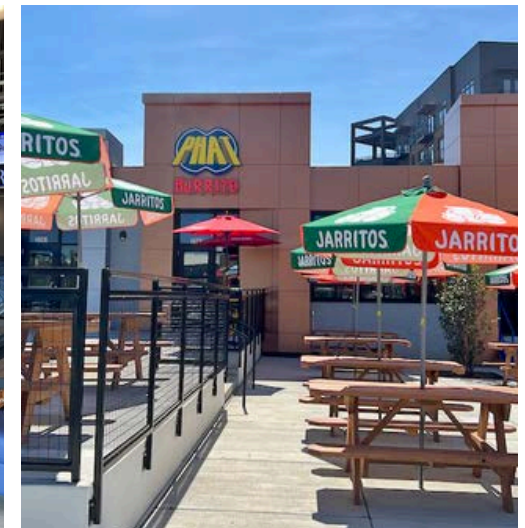
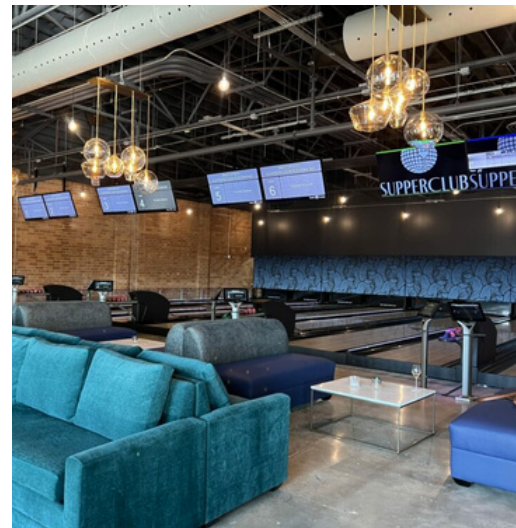

**AREA
RETAIL** ▾







DELIVERING SHELL READY SPACES SUMMER OF 2025





FOOD & BEVERAGE / NIGHTLIFE



ENTERTAINMENT



FITNESS



RETAIL SERVICES



OFFERING A+ PATIO OPPORTUNITIES

3520-A ✓

Features:

- New water and sewer
- New grease trap
- New window penetrations
- Elevated cafe patio
- Glass storefront

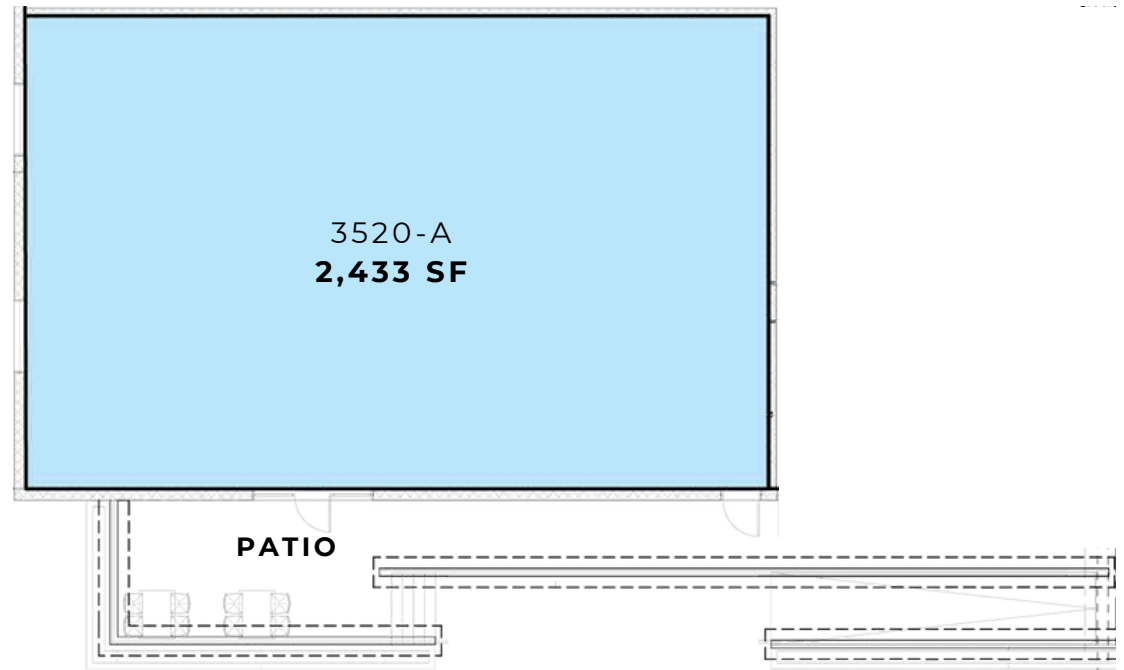
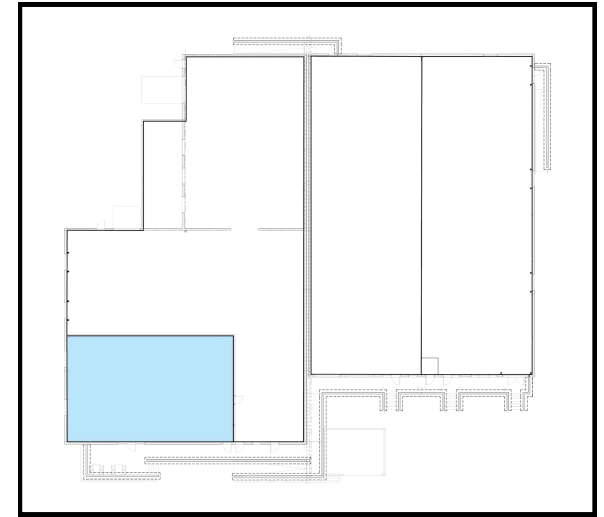

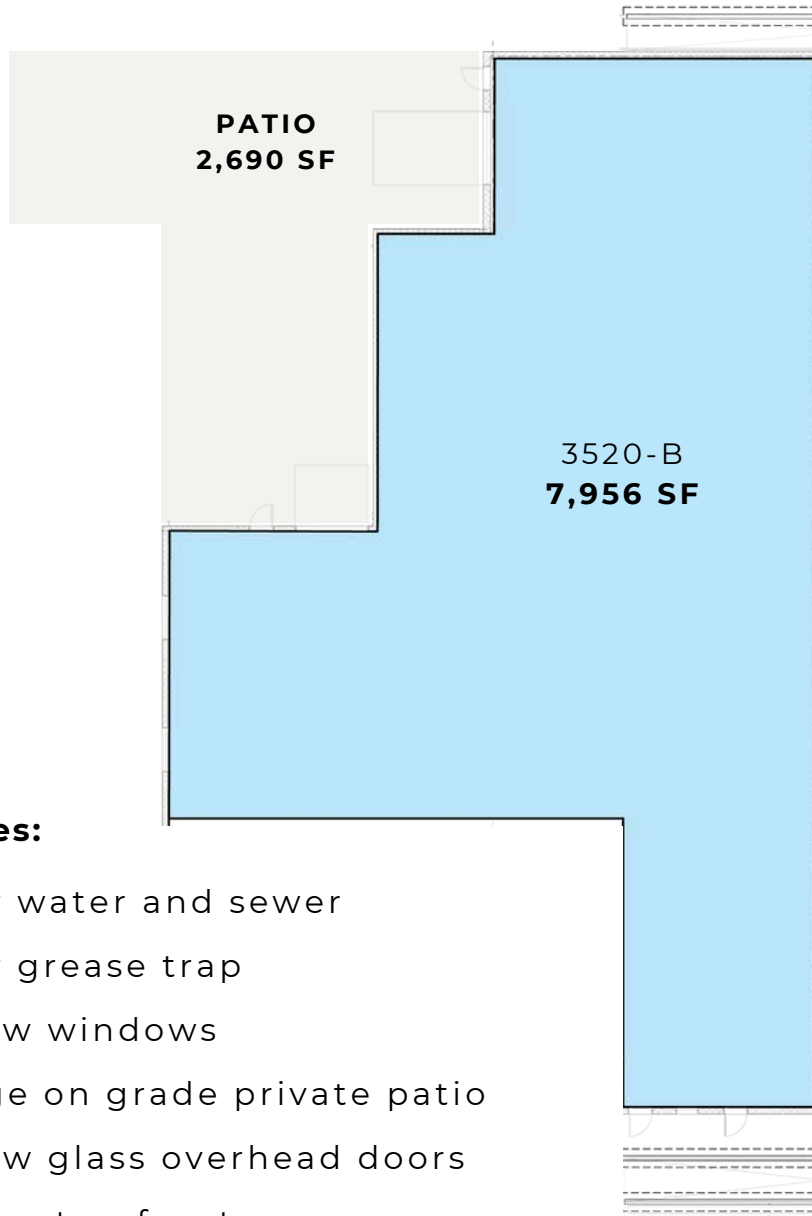

Features:

- New water and sewer
- New grease trap
- 5 new windows
- Large on grade private patio
- 2 new glass overhead doors
- Glass storefront

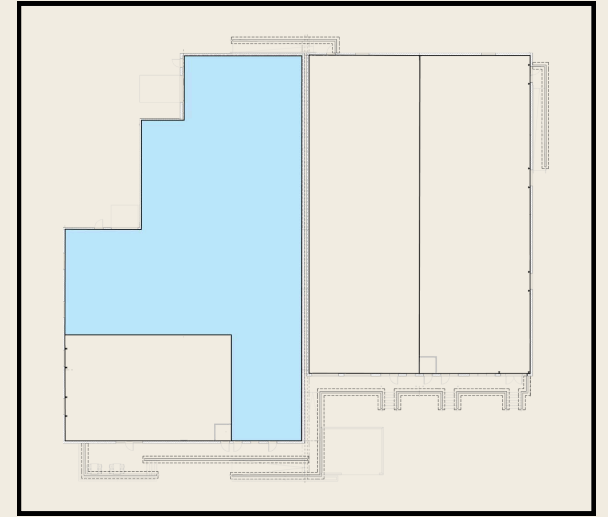

3520-C ▾

Features:

- New water and sewer
- Glass storefront
- New stairs and ADA accessible access

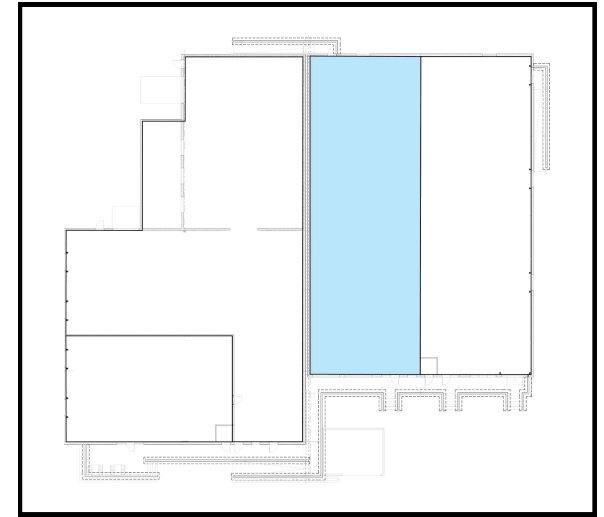
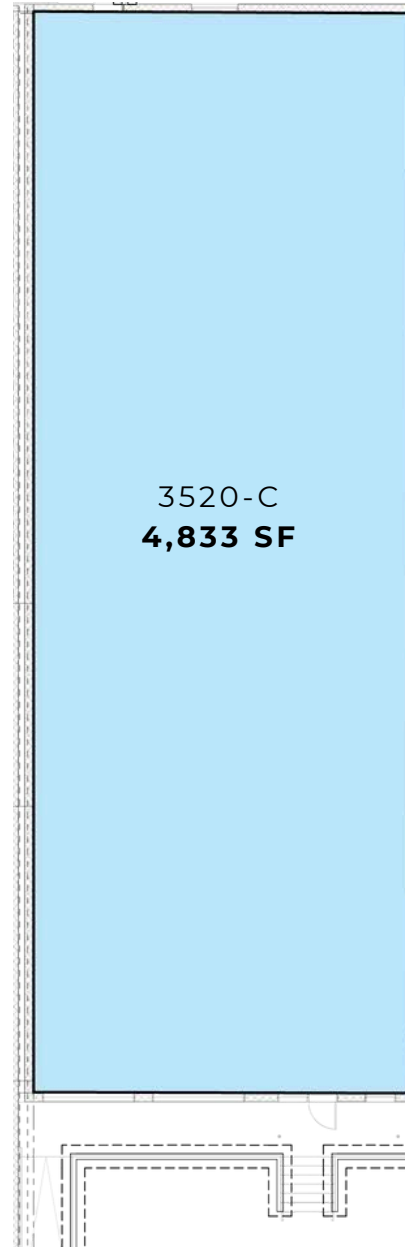
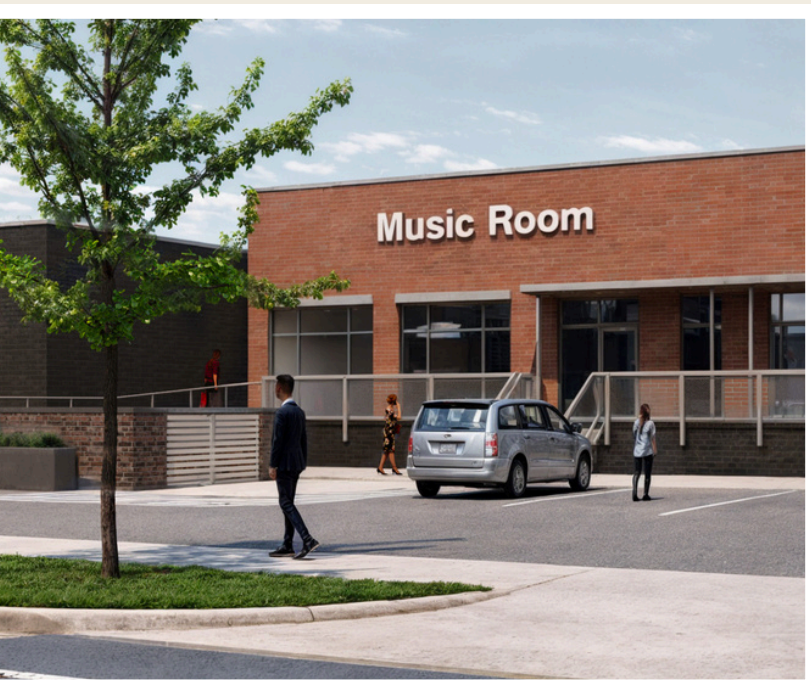

Features:

- New water and sewer
- New window penetrations
- Elevated cafe patio
- Glass storefront

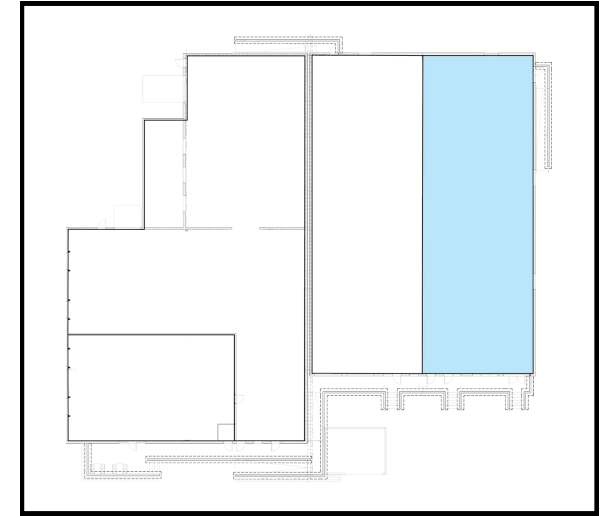
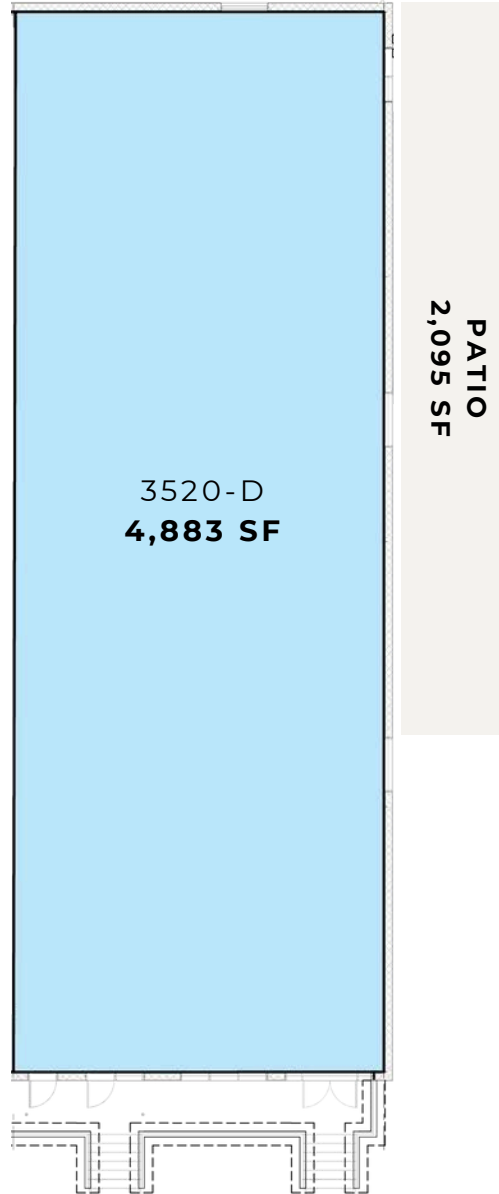

AREA
RESIDENTIAL ▾

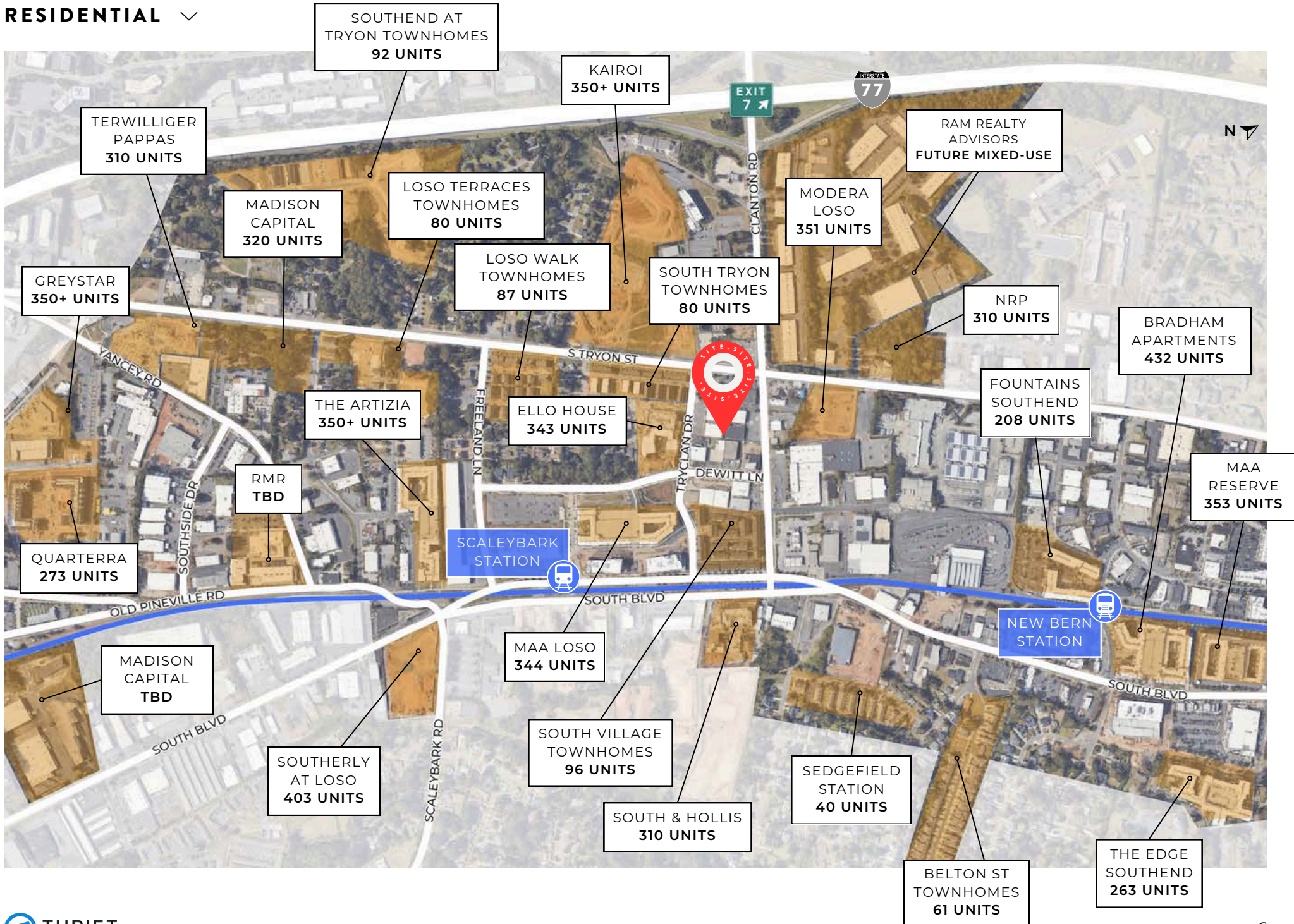



Protagonist



Queen Park Social



Chef Alyssa's Kitchen



Lenny Boy



Gilde

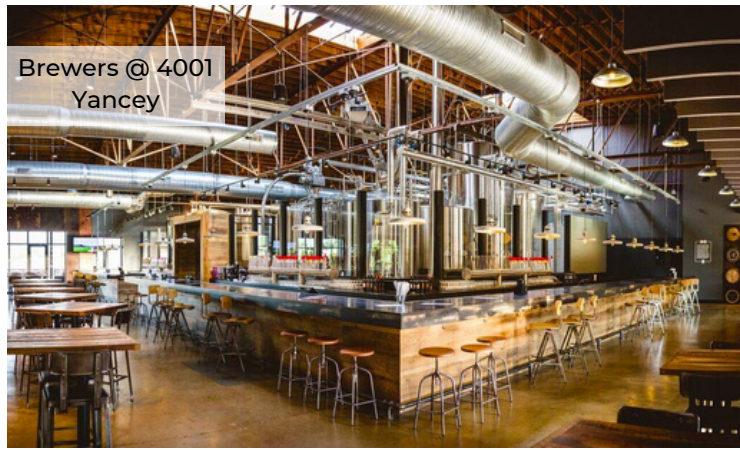

Brewers @ 4001 Yancey



Olde Mecklenburg Brewery



The Everyday Market



Sugar Creek Brewing Co.

3510-3520 DEWITT LN

CHARLOTTE, NC

GET IN TOUCH 



JAY MITCHENER

(704) 576-2772

jay@thriftcres.com

