

7,615 SF FOR LEASE

5435 ATLANTIS COURT, MOORPARK

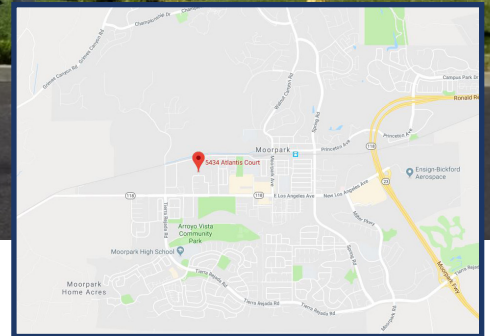

FEDER & ASSOCIATES
COMMERCIAL REAL ESTATE

7,615 SQFT
Lease Rate/SF: \$1.19/SF MG

- Excellent Location at the End of a Cul-de-Sac!
- Beautiful Office Improvements!
- 461 SF Steel Storage Mezzanine!
- 2 Ground Level 10'X12' Roll Up Doors!
- 16" Minimum Clearance!
- Rare Small Building For Lease!
- 21 Parking Spaces



RON FEDER

Managing Director
o. 818.222.0404
f. 818.322.4015
rjf@rjfeder.com
www.rjfeder.com
Cal Lic #00983855

TAYLOR JOCOY

KW Commercial
c. 818.483.3627
f. 818.657.6501
tjocoy@kw.com
www.rjfeder.com
Cal Lic #02049497





FEDER & ASSOCIATES
COMMERCIAL REAL ESTATE

Lic. 01872625 Keller Williams Realty Calabasas does not guarantee the accuracy of square footage, lot size or other information concerning the condition or features of the property provided by the seller or obtained from public records or other sources and the buyer is advised to independently verify the accuracy of that information through personal inspection with appropriate licensed professionals. Each office is independently owned and operated.



**5435 Atlantis Court
Moorpark, CA 93021**

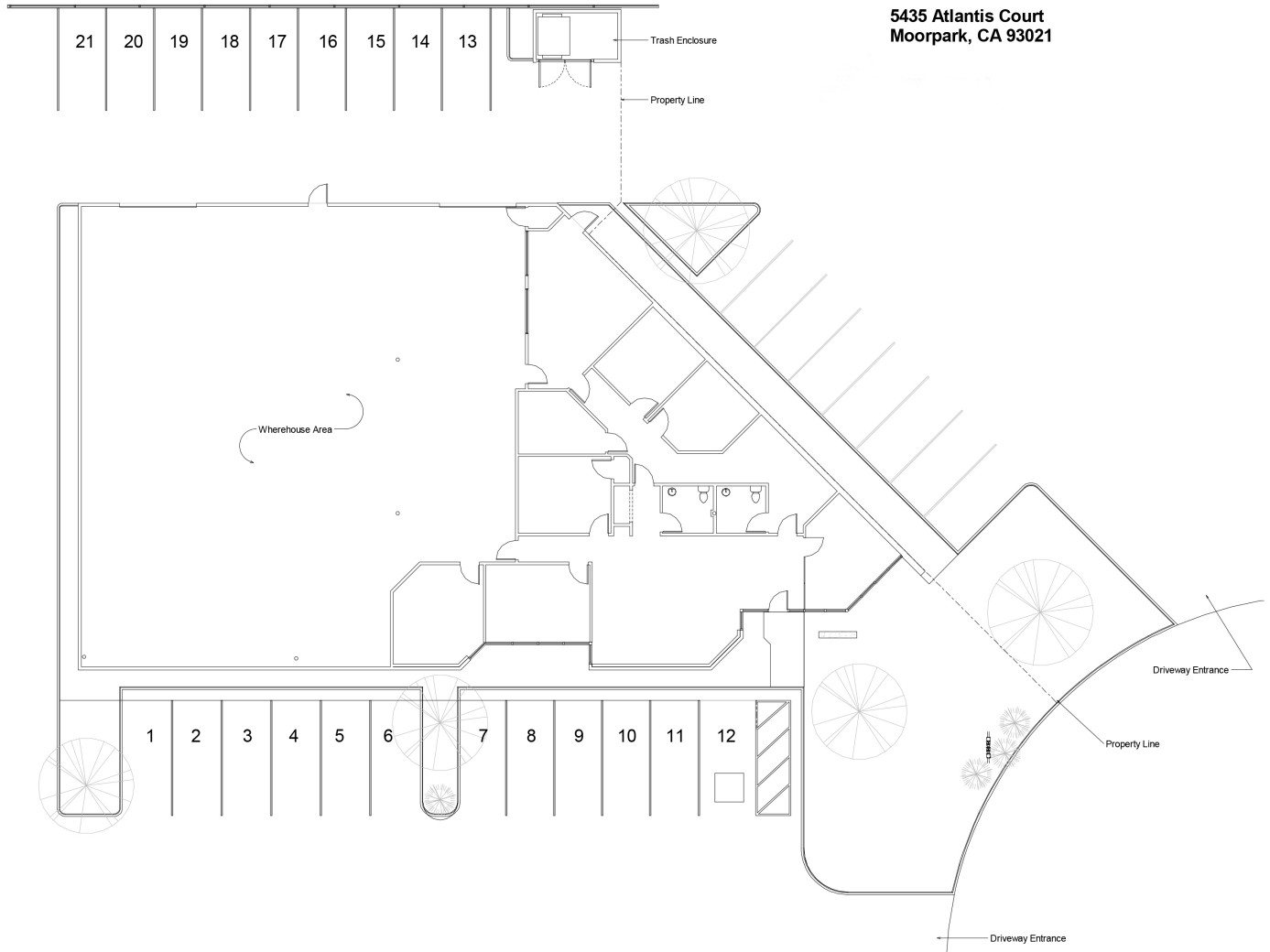

FEDER & ASSOCIATES
COMMERCIAL REAL ESTATE

Lic. 01872625 Keller Williams Realty Calabasas does not guarantee the accuracy of square footage, lot size or other information concerning the condition or features of the property provided by the seller or obtained from public records or other sources and the buyer is advised to independently verify the accuracy of that information through personal inspection with appropriate licensed professionals. Each office is independently owned and operated.