

For Lease  
Up to 55,545 SF  
Professional Office  
Educational Space



## 157-183 Main Street Paterson, NJ

### Property Features

- Square footage available on all three (3) floors
- All suites are separately metered
- All suites have their own ADA compliant restroom
- Elevator building
- Modern improvements
- Building signage available to tenant
- Two public parking garages available
- Steps from City Hall & Passaic County Community College
- In the heart of the Main Street Shopping District
- Easy access to bus Routes 80 and 19
- Minutes to the Garden State Parkway
- Twenty minutes to Manhattan



---

BUILDING SIZE 89,060 SF

---

SPACE AVAILABLE UP TO 55,545 SF

---

### Demographics

Population	145,871
Average HHI	\$39,282

For more information:  
**LEASING: 718-485-3682 X4240**  
**LEASING@MAVERICKMGMT.COM**

Lower Level Availability	Street Level Availability	Upper Level Availability
1,394 s.f.	2,180 s.f.	2,508 s.f.
1,805 s.f.	2,074 s.f.	3,060 s.f.
1,728 s.f.	3,175 s.f.	9,768 s.f.
1,361 s.f.		2,947 s.f.
1,440 s.f.		1,890 s.f.
1,440 s.f.		2,834 s.f.
1,567 s.f.		
<u>14,374 s.f.</u>		
25,109 s.f.	<u>7,429 s.f.</u>	<u>23,007 s.f.</u>

## Photos



**SECOND LEVEL OFFICE/EDUCATIONAL SPACE**

(Access from Washington Street)

**WASHINGTON STREET**

**VAN HOUTEN STREET**

**MAIN STREET**

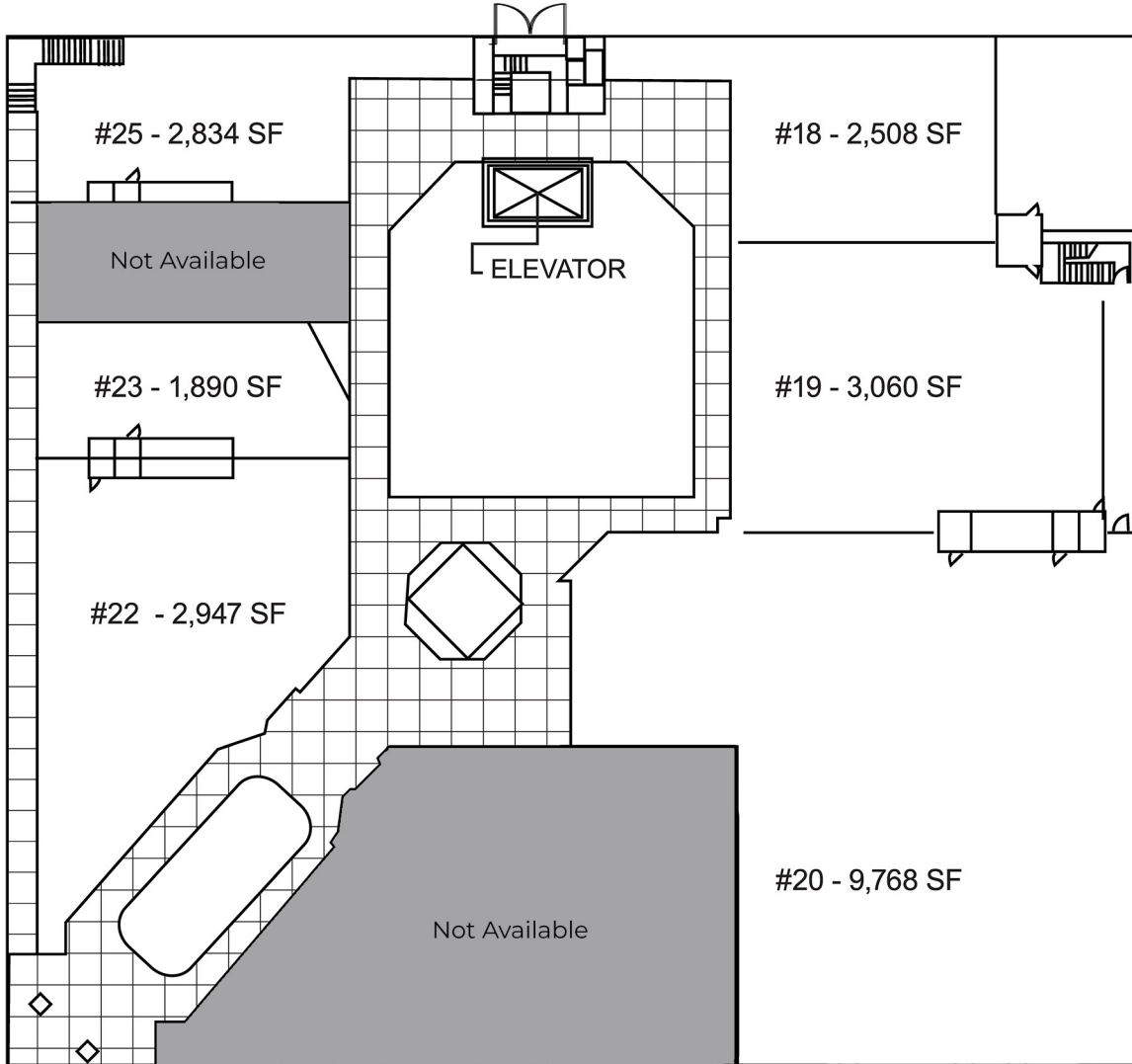

STREET LEVEL OFFICE/EDUCATIONAL SPACE

WASHINGTON STREET

VAN HOUTEN STREET

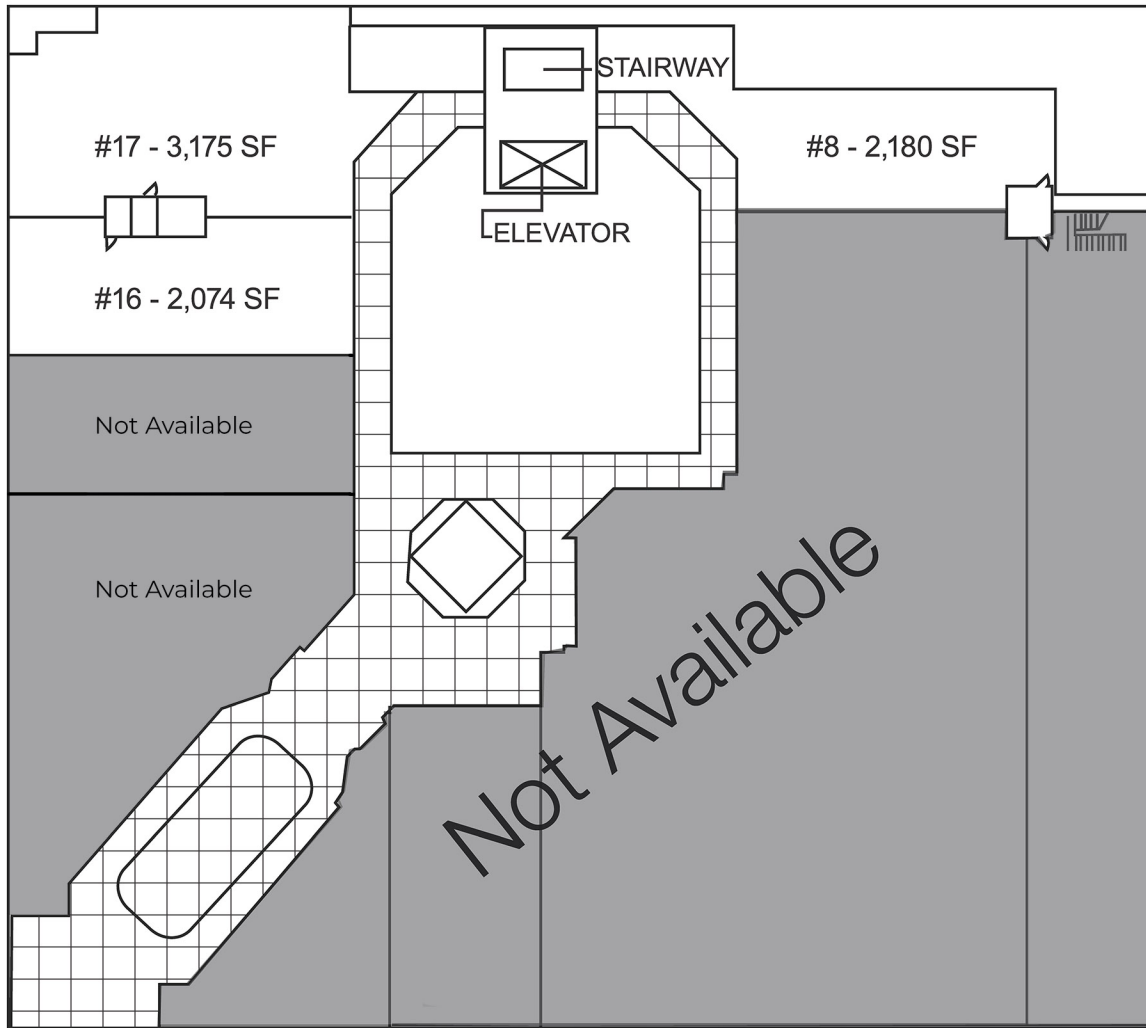

MAIN STREET

LOWER LEVEL OFFICE/EDUCATIONAL SPACE

WASHINGTON STREET

VAN HOUTEN STREET

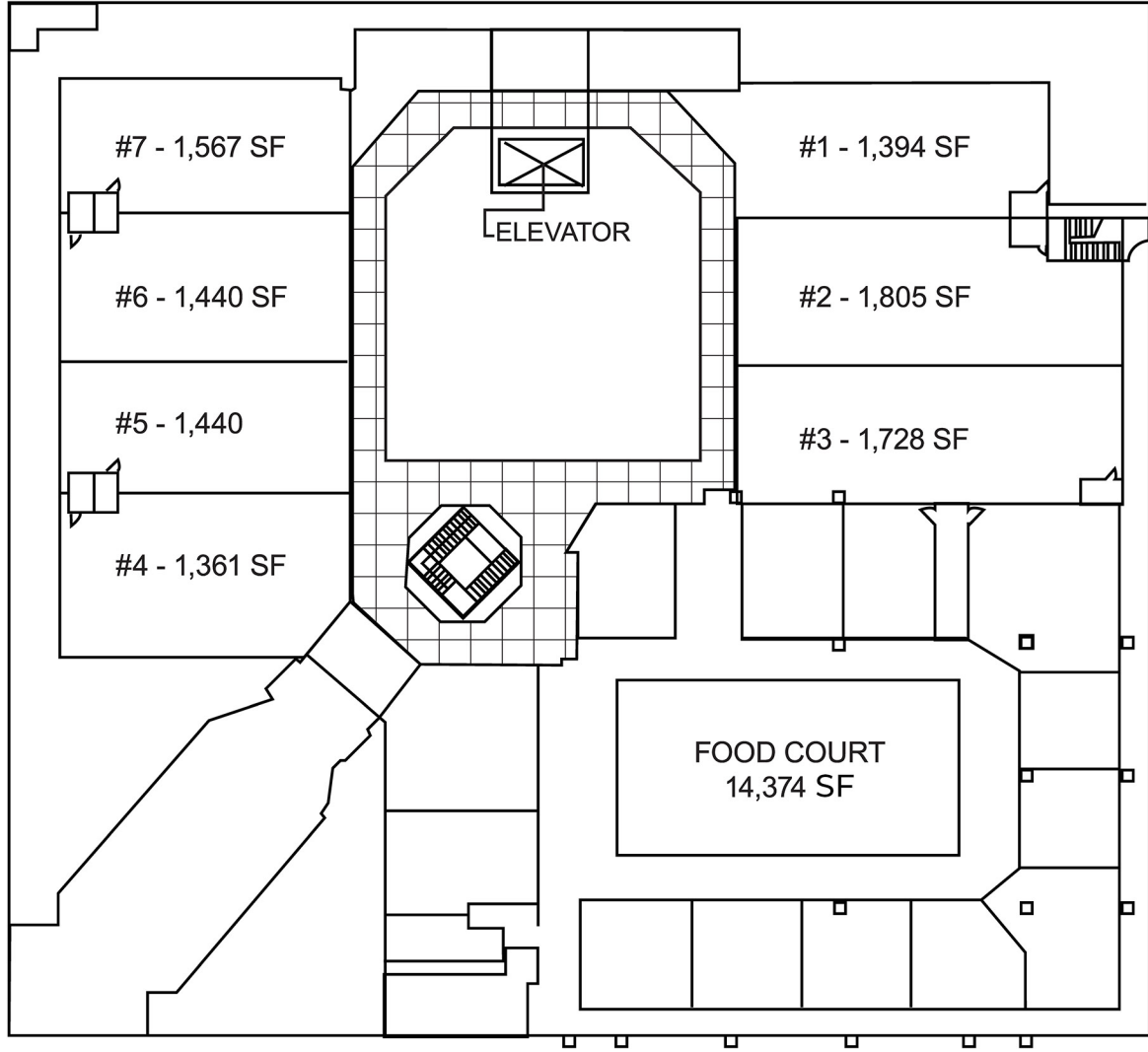

MAIN STREET

For Lease

**157-183 Main Street  
Paterson, NJ**

