



2,100 SF
For Lease

RESTAURANT/RETAIL/FITNESS/OFFICE

142 MONTAGUE STREET

Between Henry and Clinton Streets

BROOKLYN HEIGHTS
BROOKLYN | NY

RIPCO
REAL ESTATE

SPACE DETAILS

GROUND FLOOR

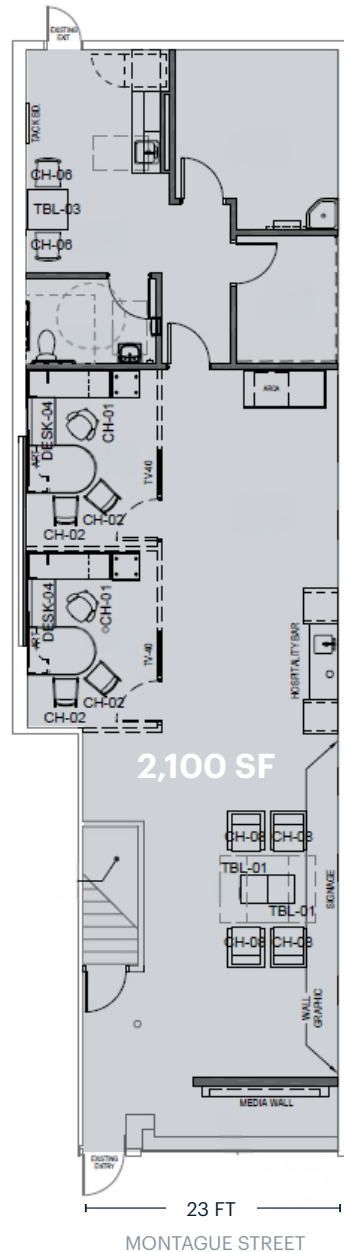

LOCATION

South side of Montague Street
between Henry and Clinton Streets

SIZE

Ground Floor 2,100 SF

ASKING RENT

Upon request

FRONTAGE

23 FT

TAXES

Proportionate share over base

CURRENTLY

Vacant

FORMERLY

Purepoint Financial

POSSESSION

Immediate

NEIGHBORS

Books are Magic, L'Appartement
4F, Dellarocco's Brick Oven Pizza,
Blank Street Coffee, Kiehl's,
City Chemist, Hanco's, Starbucks,
Chipotle, Chase Bank, Citibank,
and Soul Cycle

COMMENTS

Space can be vented for
restaurant use

Heart of historic Montague Street
in Brooklyn Heights

Heavy seven-days-a-week traffic

TRANSPORTATION

2023 Ridership Report

Court Street/
Borough Hall

R 2 3 4 5

Annual 6,066,699

Weekday 12,377

Weekend 20,372

AREA RETAIL



CONTACT EXCLUSIVE AGENTS

JASON PENNINGTON

jpennington@ripcony.com | 718.233.6565

ALEX BEARD

abeard@ripcony.com | 718.233.6565

ESTELLE HOLM PEDERSEN

epedersen@ripcony.com | 718.233.6565

RIPCO
REAL ESTATE

32 Court Street
10th Floor
Brooklyn, NY 11201
718.233.6565

Please visit us at ripcony.com for more information

This information has been secured from sources we believe to be reliable, but we make no representations as to the accuracy of the information. References to square footage are approximate. Buyer must verify the information and bears all risk for any inaccuracies.