

FOR LEASE

# RETAIL SPACE

593

MAIN STREET

Gorham, Maine 04038



## PROPERTY HIGHLIGHTS

- + 1,710± SF retail/restaurant space for lease
- + Exceptional frontage and signage opportunity along Gorham's busiest street (Route 25)
- + Ample on-site parking
- + Ideal for any retail, service or restaurant use
- + Join existing tenants Dunkin' Donuts, AT&T and Lucky Thai.
- + Lease Rate: \$13.00/SF NNN

**CBRE** | The Boulos Company

Part of the CBRE affiliate network

One Canal Plaza, Ste 500  
Portland, ME 04101  
207.772.1333  
[www.boulos.com](http://www.boulos.com)

# FOR LEASE RETAIL SPACE



## PROPERTY DETAILS

<b>Landlord</b>	Kimco Realty, LLC
<b>Building Size</b>	8,448± SF
<b>Land Area</b>	2.05± acres
<b>Available Space</b>	Unit B: 1,710± SF
<b>Map/Lot</b>	Map 32, Lot 15
<b>Zoning</b>	RC - Roadside Commercial
<b>Parking</b>	78± parking spaces (8:1 parking ratio)
<b>Traffic Count</b>	18,370 cars/day (MDOT 2014)
<b>Water/Sewer</b>	Public - separately metered
<b>Sprinklers</b>	Yes, wet system
<b>HVAC</b>	Gas-fired, forced air
<b>Tenants</b>	Dunkin' Donuts, AT&T and Lucky Thai
<b>Expenses</b>	\$7.02/SF
<b>Lease Rate</b>	\$13.00/SF NNN





## FLOOR PLAN

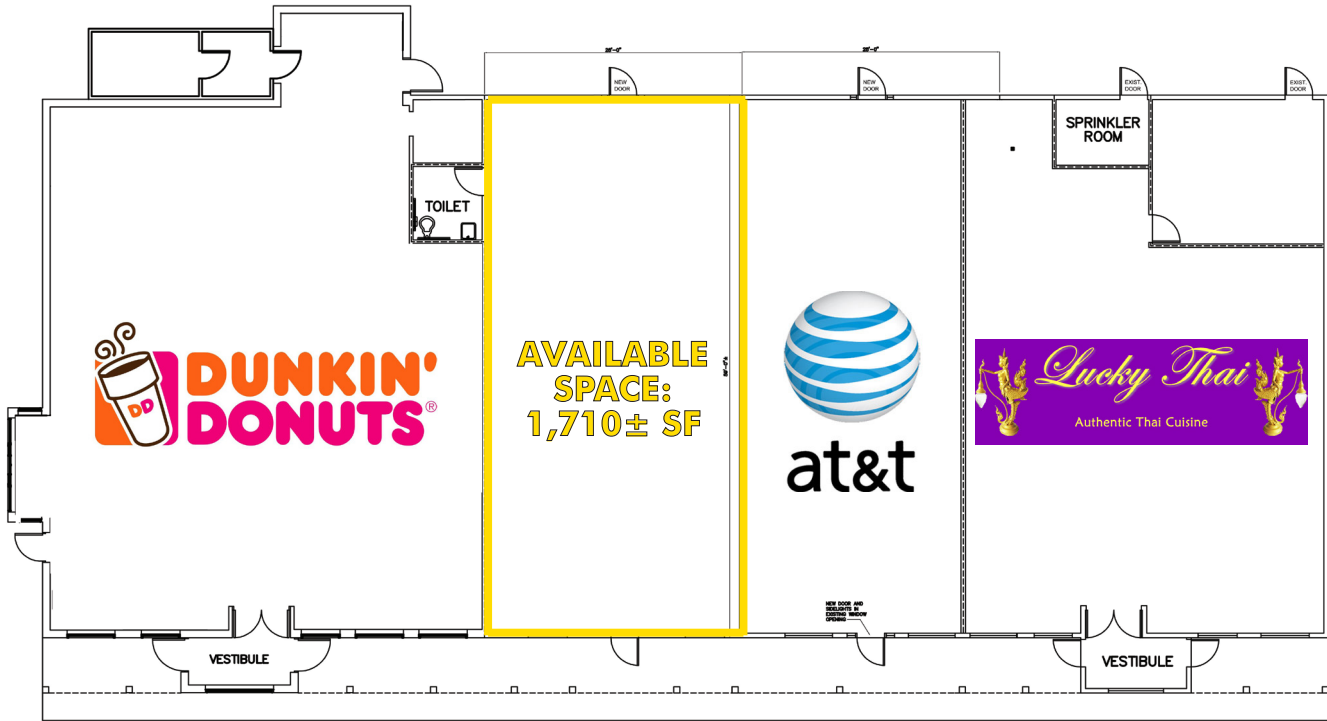

PROPOSED FLOOR PLAN  
SCALE: 1/4" = 1'-0"



# FOR LEASE RETAIL SPACE

593  
MAIN STREET  
Gorham, Maine 04038



## LOCATION

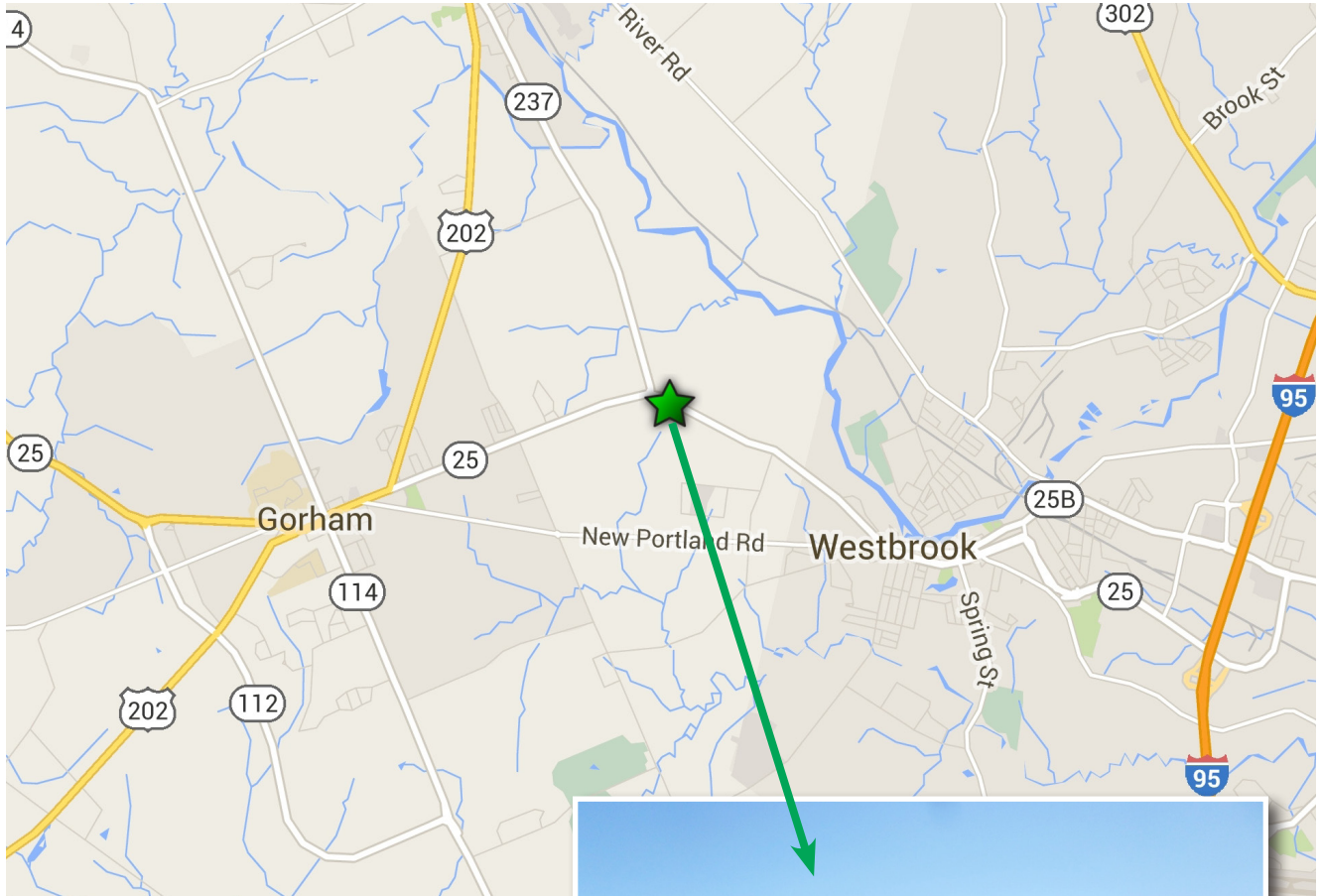

## CONTACT US



**NATE STEVENS**  
Associate Broker  
+1 207 553 1702 D  
+1 207 272 2385 C  
nstevens@boulos.com

©2016 The Boulos Company, Inc. - We obtained the information above from sources we believe to be reliable. However, we have not verified its accuracy and make no guarantee, warranty or representation about it. It is submitted subject to the possibility of errors, omissions, change of price, rental or other conditions, prior sale, lease or financing, or withdrawal without notice. We include projections, opinions, assumptions or estimates for example only, and they may not represent current or future performance of the property. You and your tax and legal advisors should conduct your own investigation of the property and transaction. We represent the Seller/Landlord, and, as such, has a fiduciary duty to disclose to the Seller/Landlord information which is material to the Sale/Lease, acquired from the Buyer/Tenant or any other source, except in cases of disclosed dual agency. Photos herein are the property of their respective owners and use of these images without the express written consent of the owner is prohibited.

**CBRE** | The Boulos Company

Part of the CBRE affiliate network

One Canal Plaza, Ste 500  
Portland, ME 04101  
207.772.1333  
www.boulos.com