

Shea Center Walnut | 667 Brea Canyon Road, Unit 21 | 2,488 SF (1,202 SF Office)

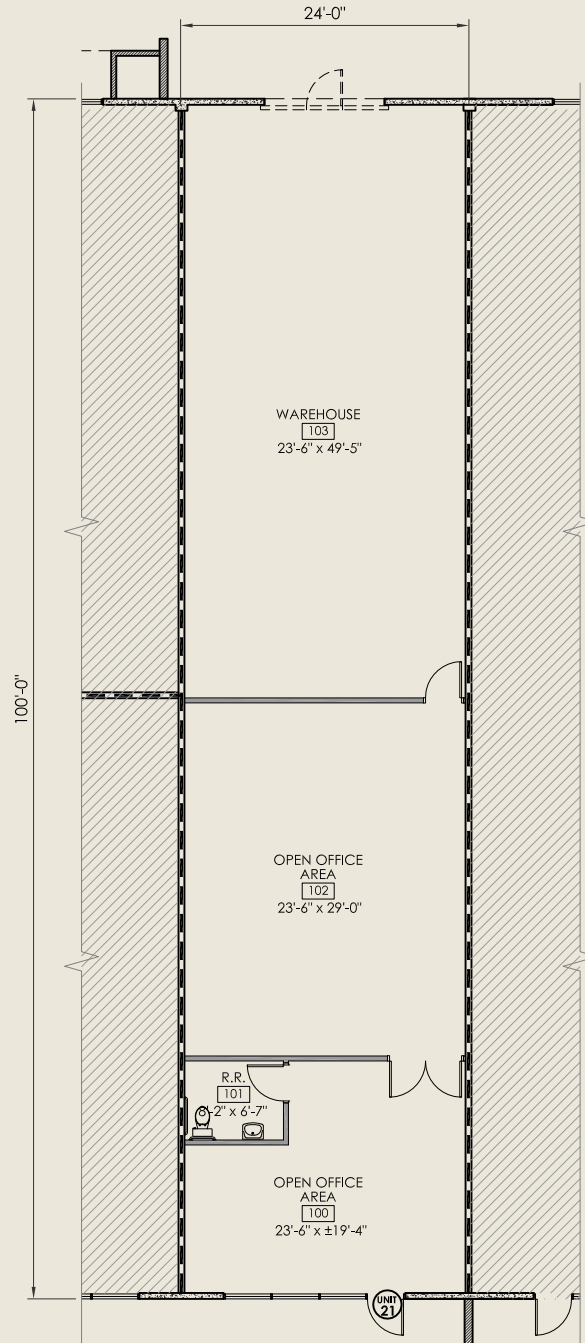

SHEA PROPERTIES (CA BL DRE #01382566)

Irma Diaz (CA SPL #01216471) • (909) 595-0499 • irma.diaz@sheaproperties.com

FLOOR PLAN